

Ceylon Government Gazette

Published by Authority.

No. 5,583 — FRIDAY, NOVEMBER 11, 1898.

PART I.—General: Minutes, Proclamations, Appointments, and General Government Notifications.
PART II.—Legal and Judicial.

PART III.—Provincial Administration.
PART IV.—Marine and Mercantile.
PART V.—Municipal and Local.

Separate paging is given to each Part in order that it may be filed separately.

Part III. — Provincial Administration.

	PAGE		PAGE
Land Sales :—		Land Acquisition Notices ...	1396
Western Province ...	1363	Land Resumption Notices...	—
Central Province	1367	Notices under Ordinance No. 1 of 1897	1397
Northern Province ...	—	Abstracts of Season Reports...	—
Southern Province ...	—	Notices under "The Forest Ordinance"	—
Eastern Province ...	1368	Sales of Arrack, Opium, and Toll Rents	1407
North-Western Province....	1384	Miscellaneous Provincial and District Notices :—	
North-Central Province ...	—	Sales of Salt and Timber	—
Province of Uva ...	1391	Notifications of Close Seasons, Infected Areas, &c.	1407
Province of Sabaragamuwa	—	Specifications under "The Irrigation Ordinance"	—

LAND SALES IN THE WESTERN PROVINCE.

No. 1,605, w. p.

Colonial Secretary's Office,
Colombo, November 1, 1898.

ON Tuesday, December 20, 1898, at 12 o'clock noon, the Hon. the Government Agent for the Western Province will put up for sale or settlement, at his office in Colombo, the under-mentioned portions of Crown Land, on the terms authorized by Government.

Twenty allotments of land situated in the Hapitigam and Alutkuru north korales of the Negombo District of the Western Province.

Lot.	Village.	Name of Land.	Name of Claimant.	Description.	Upset Price		
					Extent.	A. R. P.	Rs. c.
Preliminary plan 8,696.							
Z 498	Halloluwa	Millagahalanda	T. Harmanis Naide	Cocoanut	0 2 36	20	0
Preliminary plan 8,008.							
B 443	Kahandawa	Talgahawatta	D. Girigoris	Jungle	0 0 23	10	0
Preliminary plan 7,855.							
K 426	Kinadeniya	Welaboda or Pillewa-watta	K. Harmanis Appu and others	Cocoanut	2 2 24	75	0
C 427	Pirisyala	Rahumpitiyapillewa	A. Elias Appuhami	Chena	0 2 3	25	0
K 427	Do.	Kosgahawatta	W. Babahami	Cocoanut plants	1 1 16	150	0
L 427	Do.	Hapugahawatta	A. Brampy Appuhami	Cocoanut	0 3 32	25	0
S 427	Do.	Kahatagahawatta	M. Punchi Sinno	do.	1 2 24	40	0
U 427	Do.	Hapugahawatta	do.	do.	0 3 0	100	0
T 428	Do.	do.	A. A. Appuhami	do.	0 1 7	125	0
1363							C 1

Lot.	Village.	Name of Land.	Name of Claimant.	Description.	Upset Price per Acre.		
					A.	R.	P.
Preliminary plan 9,914.							
110	Weweldeniya	Galabodawatta	W. Daniel Sinno	Jungle	0	0	8
115	Arukoda.	Siyambalagahawatta	A. James Sinno	Cocoanut and jungle	0	2	24
117	Do.	do.	G. Caranis' Appu	Jungle	0	0	39
118	Do.	Welikannagewatta	H. Babahami	do.	0	0	35
119	Do.	Siyambalagahawatta	K. Selenchihami	do.	0	0	24
120	Do.	Mapitiyawatta	H. Babahami	do.	0	0	23
Preliminary plan 10,244.							
F 691	Halpe	Delgahawatta	J. Podi Sinho	Jungle	0	1	11
The above lands are situated in the Yatigaha and Udugaha pattus of Hapitigam korale.							
Preliminary plan 3,543.							
7459	Vitanamulla	Gorakagahakumbura	U. Punchappuhami	Field	2	1	25
Preliminary plan 3,025.							
2388	Niripitiwela	Borupankadolkele	Crown	Deniya and marshy ground	10	1	35
2389	Do.	do.	do.	do.	8	1	29
2390	Do.	do.	do.	do.	10	2	7
The above lands are situated in Dasiya pattu of Alutkuru korale north.							

Further information respecting these lands may be had from the Surveyor-General, and concerning the conditions of sale from the Hon. the Government Agent of the Western Province.

By His Excellency the Governor's command,

E. NOEL WALKER,
Colonial Secretary.

No. 1,605, W. P.

වෂ් 1898 ක්වූ නොවැම්බර් මස 1 වෙනි දින කොළඹ මහසෙනෙකාරීජ්ජන්තානසේයේ කන්යෝරුවේදීය.

සේනාධිපති ජනරාල්වරයා විසින් මෙහි පහත සඳහන්වන ආණ්ඩුව සන්තක ඉඩම් ආණ්ඩුවේ නියෝගවල ප්‍රකාරයට වෂ් 1898 ක්වූ දෙසැම්බර් මස 20 වෙනි දින වූ අභ්‍යන්තර වාද දවල් 12ව පමණ කොළඹ කම්මේරියේදී වෙන්දේසිකර විකුනවන නොහොත් තිත්පුකර දෙවන වෙනුවෙන් ඉඩ.

සේනාධිපති ජනරාල් මහත්මයාණන්ගේ ආපදානම් සහ උතුරු අලුත්කුරුකෝරලවල පිහිටා තිබෙන බිම් කැබලි 21යි.

නො.	ඉඩමේ නම.	අයිතිකම් කියවනා.	අන්දම.	අක්කර මහත. යක මිල.	අක්කර රු.
Z 498	මල්ලගහලන්ද	සිතියම 8,696. ගම—හල්මලුව. තෙ. හරමානිස් නයිදෙ	පොල්	0 2 36	20
B 443	හල්ගහවත්ත	සිතියම 8,008. ගම—කහන්දව. ද. හිරිගෝරිස්	කැලේ	0 0 23	10
K 426	වැලඹොඩ නොහොත් පිල්ලුව වත්ත	සිතියම 7,855. ගම—කිනදෙනිය. ක. හරමානිස්අප්පුසහ තවත්	පොල්	2 2 24	75
C 427	රහුම්පිටියපිල්ලුව	ගම—පිරිස්ගල.	හේන	0 2 3	25
K 427	කොස්ගහවත්ත	අ. එළියස්අප්පුසහමි	පොල්පැල	1 1 16	150
L 427	හපුගහවත්ත	ව. බිබාහමි	පොල්	0 3 32	25
S 427	කහවගහවත්ත	අ. මුම්පිඅප්පුසහමි	එම	1 2 24	40
U 427	හපුගහවත්ත	ම. පුම්පිසිංකො, සහ තවත්	එම	0 3 0	100
T 428	එම	ම. පුත්තිසිංකො, අ. අලියන්දිඅප්පුසහමි	එම	0 1 7	125
110	ගලඹොඩවත්ත	සිතියම 9,914. ගම—වේවැල්දෙනිය. වි. දැනිගෙල් සිංකො	කැලේ	0 0 8	10
115	සියඹලගහවත්ත	ගම—අරුන්ගොඩ.	පොල් සහ කැලේ	0 2 24	20
117	එම	අ. පේම්පිසිංකො	කැලේ	0 0 39	10
118	වැලිකන්තගේ වත්ත	ගමගේ කරනිස්අප්පු	එම	0 0 35	10
119	සිංඹුලගහවත්ත	ක. බිබාහමි	එම	0 0 24	10
120	මාපිටියවත්ත	ක. සෙලන්තිහමි ක. බිබාහමි	එම	0 0 23	10
F 691	දෙල්ගහවත්ත	සිතියම 10,244. ගම—හල්පො. ජ. පොසිසිංකො	කැලේ	0 1 11	15

ඉහත කී ඉඩම් පිහිටා තිබෙන්නේ ආපදානම්කෝරලේ උඩුගහ සහ හම්ගහපත්තුවලය.

නො.	ඉඩමේ නම.	අයිතිකම් නියෝජනා.	අන්දම.	මහත. අ. රු. ප.	අක්කර යක මිල. රු.
7459	තොරකගහ කුඹුර	සිතියම 3,543. ගම—විතානමුල්ල. උ. පුත්වස්ස	කුඹුර	2 1 25	30
2388	බොරැපත්ගොඩැල්ල	සිතියම 3,025. ගම—තිරිපිච්චල. ආණ්ඩුව	දෙකිය, පොකුණ ඉඩම	10 1 35	10
2389	එම	එම	එම	8 1 29	10
2390	එම	එම	එම	10 2 7	10

ඉහතකී ඉඩමේ තිබෙන්නේ උතුරු අලුත්කුරුකෝරලේ දැසියපත්තුවේය.

මේ ඉඩම් ගැණ වැඩිදුර කාරණා සර්වේයර්පනරාල්ලත්තානස්සේනේද, විකිනීමේ කොන්දේසි ගැණ විස්තාරීත පලාතේ වංශාධිපති ඒජන්තලත්තානස්සේනේද දැනගත හැකිවේ.

ගරුකර ආණ්ඩුකාර උතුරුකන්වකන්සේනේ අඤ්චලය,

ජ. තොළල් වාකර්,
මහසෙනුකාරීස් වම්ක.

No. 1,606, w. p.

Colonial Secretary's Office,
Colombo, November 1, 1898.

ON Tuesday, December 13, 1898, at noon, the Hon. the Government Agent for the Western Province will put up for sale or settlement, at his office in Colombo, the under-mentioned portions of Crown Land, on the terms authorized by Government.

Forty-four allotments of land situated in the Gangaboda pattu of the Siyane korale of the olombo District.

Preliminary plan 9,333. Village—Hisella.

Lot.	Name of Land.	Name of Claimant.	Description	Extent.			Upset Price
				A.	R.	P.	per Acre. Rs.
1	Ereagahakumbura	Heirs of K. Babanisa	Paddy field	10	3	0	40
3	Kahatagahawatta	R. Sada	Chena	2	0	16	15
4	Kelagahawatta	K. Juwanisa	do.	2	0	28	15
5	Millagahawatta	W. Sardia	do.	1	2	32	15
6	Do.	W. Laverisa and Carolisa	do.	1	3	29	20
7	—	Crown	Tank	0	2	24	10
8	Goikumbura	K. Lawarisa and others	Field	2	1	32	40
9	Millagahawatta	K. Lawarisa and another	Garden	4	1	27	50
10	Kahatagahawatta or Ihala-watta	Crown	Low jungle	0	2	13	10
11	Do.	R. Sada	Chena	0	0	31	15
12	Do.	R. Hancha and others	Garden	2	1	16	50
13	Induranakumbura	A. Henrick Perera and others	Pillewa	0	2	22	10
14	Do.	do.	Paddy field	15	0	14	40
15	Rukattanagahawatta	K. Lawarisa and others	Garden	8	3	4	50
16	Ilukkelelanda	K. Gironisa	Chena	1	0	12	10
18	Kajugahawatta	K. Gironisa and others	Garden	0	3	7	15
19	Dawatagahakumbura	H. Peirisa and others	Field	16	0	38	40
20	Delgahawatta	Y. Kiria	Garden	0	0	16	30
21	Ambagahawatta	Y. Babinga	do.	0	1	37	40
22	Ihalawatta	Rangallage Micha and others	do.	0	3	36	40
23	Do.	E. Porolisa	Chena	0	3	10	15
24	Delgahawatta	M. Suwarisa and another	do.	1	1	30	15
25	Amuneliyadda	M. Suwarisa	Deniya	0	1	28	10
26	Millagahawatta	Y. Kiriya and another	Chena	1	3	33	25
27	Moragahalanda	K. Madanisa	do.	1	1	10	15
27½	Kahatagahawatta	B. Hencha and others	Garden	14	2	24	50
29	Horagahalanda	Heirs of Elias Peris and others	Chena	5	1	15	15
Village—Hisella and Kuttiwila.							
Village—Hisella.							
30¼	—	T. Batta Veda	do.	0	0	22	10
30½	—	do.	do.	0	0	18	10
31	Etambagahawatta	T. Batta Veda	Garden	1	2	8	25
32	Nagahalanda	T. Babanisa	Chena	0	1	18	15
33	Ilukkondiyakumbura	Gunatissa Terunnanse	Paddy field	10	2	30	40
33½	—	Batta Veda	Deniya	0	0	30	10
34	Kahatagahawatta	T. Podde	Garden	1	0	30	40
35	Nagollekelegahawatta	do.	Chena	1	2	21	25
35½	Do.	T. Baba Veda	—	0	1	26	10
36	Nagahakele	Crown	Chena	1	3	22	10
37	Nagahawatta	U. Laverisa	do.	4	0	38	25
38	Horagahawatta	R. Juwanisa and another	do.	1	2	29	15
39	Horagahakele	Crown	do.	5	2	14	10
40	Kahatagahaowita	K. Talanisa and another	Paddy	4	1	16	40

Lot.	Name of Land.	Name of Claimant.	Description	Extent.		Upset Price per Acre. Rs.
				A.	R. P.	
T 722	Induragara	M. Livinis Appu and Baronchi Appu	Preliminary plan 10,414. Village—Emberaluwa Situation—Meda pattu of Siyane korale.	1	3 6	30
8814	Horagahalanda	K. Louis Appuhami and Thomis	Preliminary plan 10,548. Village—Weboda Situation—Adikari pattu of Siyane korale.	0	2 36	20
8817	Do.	K. Louis	—	1	0 9	30

Further information respecting these lands may be obtained from the Surveyor-General, and respecting the conditions of sale from the Hon. the Government Agent, Western Province.

By His Excellency the Governor's command,

E. NOEL WALKER,
Colonial Secretary.

No. 1,606, W. P.

වසූ 1898 ක්වූ නොවැම්බර් මස 1 වෙනි දින කොළඹ මහසෙනෙවුන්ගේ නාමයෙන් කන්දෝරුවෙහිදී.

බස්නාහිර දිසාවේ වංශාධිපති ආණ්ඩුවේ ඒජන්ත උත්තරානන්දේ විසින් මෙහි පහත සඳහන්වන ආණ්ඩුව සහ තනි ඉඩම් ආණ්ඩුවේ නියෝගවල ප්‍රකාරයට වසූ 1898 ක්වූ දෙසැම්බර් මස 13 වෙනි දින වූ අගනරුවාද දවල් කොළඹ කවිචේරියේදී වෙන්දේසිකර විකුණනට නොහොත් නිවැරදි කර දෙන්නට යොදනවා ඇත.

බස්නාහිර දිසාවේ කොළඹ පලාතේ සිසනුකෝරලේ ගහබොවපත්තුවේ පිහිටා තිබෙන බිම්කැබේලි. සිතියම 9,333. ගම—හිස්ඇල්ල.

නො.	ඉඩමේ නම.	අයිතිකම් කීයන්ගේ නම.	අන්දම.	අක්කර මහන. සහ මිල.		
				අ. රු. ප.	රු.	
1	ජීර්ණකුඹුර	කේ. බබානිසාගේ උරුමක්කාරයෝ	කුඹුර	10	3 0	40
3	කහවගහවත්ත	ආර්. සාදා	හේන	2	0 16	15
4	කැලගහවත්ත	කේ. පුළුනිසා	එම	2	0 28	15
5	මිල්ලගහවත්ත	වබ්ලිච්චි. සර්දියා	එම	1	2 32	15
6	එම	වබ්ලිච්චි. ලවරියා සහ කරෝලියා	එම	1	3 29	20
7	—	ආණ්ඩුව	පොකුන	0	2 24	10
8	ගොසිකුඹුර	කේ. ලවරියා සහ තවත් අය	කුඹුර	2	1 32	40
9	මිල්ලගහවත්ත	කේ. ලවරියා සහ තවත් කෙනෙක්	වත්ත	4	1 27	50
10	කහවගහවත්ත කොහොත් ඉහලවත්ත	ආණ්ඩුව	ලදකැලේ	0	2 13	10
11	එම	ආර්. සාදා	හේන	0	0 31	15
12	එම	ආර්. හත්වා සහ තවත් අය	වත්ත	2	1 16	50
13	ඉදුරුනේකුඹුර	ඒ. හෙන්ද්‍රික් ප්‍රේම සහ තවත් අය	පිල්ලුව	0	2 22	10
14	එම	එම	කුඹුර	15	0 14	40
15	රුක්අත්තනගහවත්ත	කේ. ලවරියා සහ තවත් අය	වත්ත	8	3 4	50
16	ඉළුකැලේලන්ද	කේ. ගිරෝනිසා	හේන	1	0 12	10
18	කපුගහවත්ත	කේ. ගිරෝනිසා සහ තවත් අය	වත්ත	0	3 7	15
19	දවටගහකුඹුර	එච්. පිරිසා සහ තවත් අය	කුඹුර	16	0 38	40
20	දෙල්ගහවත්ත	වයි. කීරියා	වත්ත	0	0 16	30
21	අඹගහවත්ත	වයි. බබානිසා	එම	0	1 37	40
22	ඉහලවත්ත	රත්නල්ලගේ මිවා සහ තවත් අය	එම	0	3 36	40
23	එම	ජී. පොරෝලියා	හේන	0	3 10	15
24	දෙල්ගහවත්ත	ඇම්. සුචාරියා සහ තවත් කෙනෙක්	එම	1	1 30	15
25	අමුනේලියාද්ද	ඇම්. සුචාරියා	දෙතිය	0	1 28	10
26	මිල්ලගහවත්ත	වයි. කීරියා සහ තවත් කෙනෙක්	හේන	1	3 33	25
27	මාරගහලන්ද	කේ. මදනිසා	එම	1	1 10	15
27½	කහවගහවත්ත	ආර්. හත්වා සහ තවත් අය	වත්ත	14	2 24	50
29	හොරගහලන්ද	ගම—හිස්ඇල්ල සහ කුට්ටිපිලි. එලියස් පිරිස්ගේ උරුමක්කාරයෝ සහ තවත් අය	හේන	5	1 15	15
30½	—	ගම—හිස්ඇල්ල.	—	0	0 22	10
30½	—	පී. බබානිසා වෙදා	—	0	0 18	10
31	ඇටඹගහවත්ත	එම	හේන	0	0 18	10
32	නාගහලන්ද	එම	වත්ත	1	2 8	25
33	ඉළුකැලේලන්ද කුඹුර	පී. බබානිසා	හේන	0	1 18	15
33½	—	ගනකීස්ස හෙරුත්තානන්දේ	කුඹුර	10	2 30	40
34	කහවගහවත්ත	බබානිසා වෙදා	දෙතිය	0	0 30	10
35	නාගොල්ලේ කැලගහ වත්ත	පී. පොඩ්ඩේ	වත්ත	1	0 30	40
35½	එම	එම	හේන	1	2 21	25
35½	එම	පී. බබානිසා	—	0	1 26	10

නො.	ඉඩමේ නම.	අයිතිකම් කීයන්ගේ නම.	අන්දම.	මහත. අ. රු. ප.	අක්කර සක මිල. රු.
36	නාගනකැලේ	ආණ්ඩුව	හේන	1 3 22	10
37	නාගනවත්ත	සී. උවරිසා	එම	4 0 38	25
		ගම—සිස්පැල.			
38	ගොරගනවත්ත	ආර්. ප්‍රවානිසා සහ තවත්කෙනෙක්	හේන	1 2 29	15
39	ගොරගනකැලේ	ආණ්ඩුව	එම	5 2 14	10
40	කහවගන මිව්ව	කේ. තෙලේනිසා සහ තවත්කෙනෙක්	කුඹුර	4 1 16	40
T 722	සිතියම 1,04,414. පිහිටා තිබෙන්නේ සිතනැකෝරලේ මැදපත්තුවේය.	අම්. ලිවිනිස්අප්පු සහ බාරොන්විඅප්පු	—	1 3 6	30
	ඉදුරුගාර සිතියම 10,548.	සිතනැකෝරලේ අදිකාර්පත්තුවේ.	ගම—වැබොඩ.		
8814	ගොරගනලත්ද	කේ. එවිස්අප්පුසාම සහ තෝමස්	—	0 2 36	20
8817	එම	කේ. එවිස්	—	1 0 9	30

මෙම ඉඩම් ගැණ වැඩිදුර කාරණා සර්වේඤ්චනවත්තාත්සේගෙන්ද, විකිනීමේ කොන්දේසි ගැණ කාරණා කොළඹ වංශාධිපති ආණ්ඩුවේ ඒජන්තවත්තාත්සේගෙන්ද දැනගත්ව පුළුවන.

ගරුහර ආණ්ඩුකාර උතුමානත්වගන්සේගේ ආඥාවලෙව,
 ජ. නොඑල් වාකර්,
 මහසෙක්‍රතාරිස් වලිග.

LAND SALES IN THE CENTRAL PROVINCE.

AMENDED NOTICE.

No. 1,593, C. P.

Colonial Secretary's Office,
 Colombo, October 16, 1898.

ON Wednesday, November 30, 1898, at 12 o'clock noon, the Assistant Government Agent for the Matale District will put up to auction, at his office in Matale, the under-mentioned portion of Crown Land, on the terms authorized by Government.

An allotment of land situated in Medasiya pattu division of the Matale South District of the Central Province.

Preliminary plan 3,729.

Lot.	Village.	Name of Applicant.	Name of Claimant.	Description.	Extent. A. R. P.
10254	Elwela	B. M. Banda	Crown	Mukalana	3 0 35

Upset price,—Rs. 50 per acre.

Further information respecting this land may be obtained from the Surveyor-General, and respecting the conditions of sale from the Assistant Government Agent, Matale.

By His Excellency the Governor's command,
 E. NOEL WALKER,
 Colonial Secretary.

වෙනස්කරණලද දැන්වීමයි.

No. 1,593, C. P.

වර්ෂ 1898 ක්‍රිස්තු මස 16 වෙනි දින කොළඹ

මහසෙක්‍රතාරිස්උත්තාත්සේගේ කන්තෝරුවේදීය.

මධ්‍යම දිසාවේ මාතලේ උපඒජන්තවත්තාත්සේ විසින් මෙහි පහත සඳහන්වෙන ආණ්ඩුව සත්තක ඉඩම ආණ්ඩුවේ නියෝගවල ප්‍රකාරයට වර්ෂ 1898 ක්‍රිස්තු නොවැම්බර් මස 30 වෙනි දින වදාදා දවල් 12ට මාතලේ කවිචේරියේදී වෙන්දේසිකර විකුනනව යෙදෙනවා ඇත.

මධ්‍යම දිසාවේ මාතලේ දකුණු පලාතේ මැදසියා පත්තුවේ කොට්ඨාසයේ පිහිටා තිබෙන බිම්කැබෙලි 1ක්.
 සිතියම 3,729.

නො.	ගම.	ඉල්ලුම්කාරයා.	අන්දම.	මහත. අ. රු. ප.
10254	ඇල්වල	බී. ඇම්. බත්තා	මුකලාන	3 0 35

අක්කරයක් රුපියල් 50ගේ හිට විකුනනව පවත්ගනු ලැබේ.

මෙම ඉඩම ගැණ වැඩිදුර කාරණා සර්වේඤ්චනවත්තාත්සේගෙන්ද, විකිනීමේ කොන්දේසි ගැණ මාතලේ ආණ්ඩුවේ උපඒජන්තවත්තාත්සේගෙන්ද දැනගත්ව පුළුවන.

ගරුහර ආණ්ඩුකාර උතුමානත්වගන්සේගේ ආඥාවලෙස,
 ජ. නොඑල් වාකර්,
 මහසෙක්‍රතාරිස් වලිග.

LAND SALES IN THE EASTERN PROVINCE.

No. 726, E. P.

Colonial Secretary's Office,
Colombo, October 29, 1898.

ON Thursday, December 15, 1898, and following days, at the Kachcheri, the Assistant Government Agent for the Trincomalee District will put up to auction, at his office in Trincomalee, the under-mentioned portions of Crown Land, on the terms authorized by Government.

Sixty-seven allotments of land situated in the Koddiyar division of the Trincomalee District of the Eastern Province.

Lot.	Name of Applicant.	Name of Claimant.	Description.	Extent.		Upset Price.
				A.	R. P.	per Acre. Rs. c.
Preliminary plan 586. Village—Muttur.						
6362	—	Crown	Paddy	0	1 4	60 0
6364	A. Mammatu Kasin	do.	Jungle fit for paddy	0	2 32	40 0
6372	—	do.	do.	2	0 22	20 0
6374	U. Sathakku	do.	do.	3	1 2	20 0
6376	—	do.	do.	1	3 27	20 0
6377	A. Cassim	do.	do.	5	3 7	20 0
6378	M. Marimuttu	do.	do.	3	2 38	20 0
6379	K. Konamalai	do.	do.	2	2 27	20 0
6380	V. Tampimuttu and another	do.	do.	2	2 38	20 0
6381	A. Asanalevvai	do.	do.	7	3 10	20 0
6382	U. Mirasaibu	do.	do.	3	1 27	20 0
6383	P. Allitampi	do.	do.	3	0 28	20 0
6388	—	do.	Paddy	0	1 7	60 0
6390	—	do.	Jungle fit for paddy	3	2 38	20 0
Preliminary plan 638. Village—Muttur.						
7049	A. Umarukatta	Crown	Cocoanut	1	0 19	10 0
7050	P. Aliyar	do.	do.	1	2 30	10 0
7051	K. Kachchumarakayer	do.	do.	0	0 32	10 0
7052	K. Thimboom	do.	do.	1	2 4	10 0
7053	Do.	do.	Sundries	0	3 8	10 0
7054	M. Miradu	do.	Cocoanut	1	2 9	10 0
7055	—	do.	Jungle	1	2 24	10 0
7056	—	do.	Cleared	0	2 26	10 0
7057	U. Levvai Kannī	do.	Cocoanut	0	2 26	10 0
7058	I. Sinnatampi	do.	do.	3	0 34	20 0
7059	—	do.	Jungle	0	2 16	10 0
7060	I. Paikcer	do.	Cocoanut	0	3 11	10 0
7061	C. Sinnatampi and another	do.	do.	1	0 23	10 0
7062	A. Savurimuttu	do.	do.	1	1 22	10 0
7063	—	do.	Well, &c.	0	0 8	10 0
7064	P. Meyadinava	do.	Jungle fit for cocoanut	0	1 17	10 0
Village—Kaddaiparichchan.						
7065	P. V. Muttu Sinnakuddi	Crown	Jungle fit for cocoanut	1	0 16	20 0
7066	—	Vallippillai	do.	0	2 28	20 0
7069	—	M. Periyatampi	do.	1	0 15	60 0
7070	—	Crown	do.	1	2 5	30 0
7074	—	do.	Lime tree and waste	0	1 23	10 0
7075	A. Kantavanam	do.	Cleared land	0	2 13	10 0
7079	—	S. Kathiraveli	Cocoanut	0	2 14	15 0
7080	—	V. Virakatti	do.	0	2 11	20 0
7081	V. Tampaiya	Crown	Cleared land	0	0 35	5 0
Village—Marutadichchenai.						
7085	M. Tiyakapper	Crown	Cocoanut	0	1 10	10 0
7086	A. Tampimuttu	do.	do.	1	0 9	20 0
7088	C. Cettan	do.	Bare	0	0 38	5 0
7093	A. Kantavanam	do.	Cocoanut	0	0 34	20 0
7094	N. Velupillai	do.	Lime trees	0	0 36	10 0
7097	—	V. Kantappan	Cocoanut	0	0 26	20 0
7098	—	N. Kuppaiyer	Bare	0	0 25	20 0
7099	—	do.	Cocoanut	0	0 24	15 0
7100	—	Konattai	do.	0	1 0	25 0
7103	N. Nagamai	Crown	do.	0	1 12	15 0
7104	K. Sinnavan	do.	do.	0	2 35	20 0
Preliminary plan 1,145. Village—Toppur.						
1820	Mirasaipu Kuppaitampi	—	Forest fit for garden	28	1 4	12 50
Default Lands.						
Preliminary plan 2,053. Village—Muddichenai.						
Name of Purchaser.						
6761	Murukapper Tampapillai	—	Paddy	10	0 32	15 0
6765	K. Kaddady Murukan	—	do.	6	1 0	15 0
Preliminary plan 1,629. Village—Pallykudyiruppu.						
4728	Sinnatampi Kantapillai	—	Paddy	0	3 35	15 0
4729	Paikertampi Akamatu Levvai	—	Scrub	0	3 34	20 0

Lot.	Name of Applicant.	Name of Claimant.	Description.	Extent. A. R. P.	Upset Price per Acre.	
					Rs.	c.
		Preliminary plan 830.	Village—Muttur.			
9984	Sekumadar Mukamatu Matar	—	Jungle fit for paddy	17 2 0	12	50
9985	Do.	—	Jungle	20 0 25	12	50
		Preliminary plan 2,037.	Village—Anaitivu.			
6695	V. Chinnatampi and another	—	Jungle	4 0 20	20	0
6696	Do.	—	Paddy	4 1 26	20	0
		Preliminary plan 2,050.	Village—Ichchilampattai.			
6754	Virakatti Pattiniyar	—	Paddy	2 3 16	20	0
		Preliminary plan 2,052.	Village—Ichchilampattai.			
6756	S. Udayar Periatampi and another	—	Paddy	4 0 35	20	0
6757	Suppar Murugan	—	do.	5 2 26	15	0
		Preliminary plan 971.	Village—Mallikaitivu.			
11936	P. Kathiramatampi and another	—	Jungle	10 0 31	20	0
		Preliminary plan 2,238.	Village—Pallykudyiruppu.			
7497	Kantapper Chellappa	—	Jungle	4 1 2	15	0
7498	Do.	—	do.	0 1 13	15	0
		Preliminary plan 975.	Village—Muttur.			
A 352	Segumadar Udaiyar	—	Garden	0 0 28	10	0
11953	Akamatu Neina Muttuvappu	—	do.	0 2 35	10	0

Further information respecting these lands may be obtained from the Surveyor-General, and respecting the conditions of sale from the Assistant Government Agent, Trincomalee.

By His Excellency the Governor's command,

E. NOEL WALKER,
Colonial Secretary.

No. 726, E. P.

கொலோனியல் சர்க்கிழத்தார ஆபீசில்,
கொழும்பில், 1898 ம் ஆண்டு அக்டோபர் 29 ந்த திகதி.

1898 ம் ஆண்டு மார்ச்சு மாதம் 15 ந்த திகதியாகிய வியாளககிழமை மத்தியானம் 12 மணிக்கும் அடுத்த நாட்களிலும் தனது ஆபீசில் கீழ்க்காணத்து உதவ் கவற்றண்டேந்து ஏசனறவாகளால் இதனடியிற சொல்லப் படடிருக்கிற முடிசூரிய காணத்துண்கெளை, அரசாட்சியாரால் உததாவுபண்ணப்பட்டிருக்குட பொருத்தப் பிரகாரம் ஏலததிற்குறி வீற்கபபடும.

67 காணத்துண்கெளை, கீழ மாகாணத்து திரிகோணமலை டிஸ்திரிக்டின் கொட்டியாரா பகுதியிலிருக்கின்றது.

இல.	கேள்வக்காரன.	பிளான இலககம் 586. சூறிச்சி—முதூர்.		விசாலம்.	ஏக்கருக்கு
		உரிததாளியின பெயர்.	வவரம்.		
6362	—	அரசாட்சியார	தெல	0 1 4	60 0
6364	எ. மம்மசூ காசிம்	செடி	வயலுக்கேற்ற காடு	0 2 32	40 0
6372	—	செடி	செடி	2 0 22	20 0
6374	யு. சதக்கு	செடி	செடி	3 1 2	20 0
6376	—	செடி	செடி	1 3 27	20 0
6377	எ. காசிம்	செடி	செடி	5 3 7	20 0
6378	எம். மாரிமுத்து	செடி	செடி	3 2 38	20 0
6379	கே. கொணாமலை	செடி	செடி	2 2 27	20 0
6380	வீ. தம்பமுத்தம்மறு பேரும	செடி	செடி	2 2 38	20 0
6381	எ. அசனலெவ்வை	செடி	செடி	7 3 10	20 0
6382	யு. மீராசா	செடி	செடி	3 1 27	20 0
6383	பி. அலவிததம்பி	செடி	செடி	3 0 28	20 0
6388	—	செடி	நெற்றரை	0 1 7	60 0
6390	—	செடி	நெல்லுக்கேற்ற காடு	3 2 38	20 0
		பிளான இலககம் 638.			
7049	எ. உமறுகத்தார	அரசாட்சியார	தெனனை	1 0 19	10 0
7050	பி. அவியாசா	செடி	தெனனை	1 2 30	10 0
7051	கே. கசகமரககாயர்	செடி	தெனனை	0 0 32	10 0
7052	கே. தீனூரன	செடி	தெனனை	1 2 4	10 0
7053	—	செடி	பலபுரோசனங்கள்	0 3 8	10 0
7054	எம். மீராசா	செடி	தெனனை	1 2 9	10 0
7055	—	செடி	காடு	1 2 24	10 0
7056	—	செடி	சூப்பரவுபண்ணப்பட்ட காடு	0 2 26	10 0
7057	யு. வெவ்வைகணனி	செடி	தெனனை	0 2 26	10 0
7058	ஐ. சீனனததம்பி	செடி	தெனனை	3 0 34	20 0
7059	—	செடி	காடு	0 2 16	10 0
7060	ஐ. பக்கீர்	செடி	தெனனை	0 3 11	10 0
7061	சீ. சீனனததம்பியு மறு பேரும	செடி	தெனனை	1 0 23	10 0
7062	எ. சவுரிமுத்து	செடி	தெனனை	1 1 22	10 0
7063	—	செடி	கிணறு	0 0 8	10 0
7064	பி. பெய்தீனாவார	செடி	தெனனைக்கேற்றகாடு	0 1 17	10 0

இல.	கேள்விக்காரன்.	உரித்தாளியின் பெயர்.	விவரம்.	விசர்லம்.	ஏக்கருக்கு.
				அ. ரூ. ப.	ரூ. ச
சூழிச்சி—கடடைபறிச்சான.					
7065	பி. வி. முத்து சீனனக	அரசாட்சியார	தெனனைக்கேற்றகாடு	1 0 16	20 0
7066	—	வள்ளியப்பிள்ளை	தெனனை	0 2 28	20 0
7069	—	எம். பெரியதம்பி	தெனனை	1 0 15	60 0
7070	—	அரசாட்சியார	தெனனை	1 2 5	30 0
7074	—	ஹெடி	எலும்பிச்சையும வெறுந்தரையும்	0 1 23	10 0
7075	எ. கந்தவனம்	ஹெடி	உப்பரவுபண்ணப்ப டட தரை	0 2 13	10 0
7079	—	எஸ். கதிரவேலி	தெனனை	0 2 14	15 0
7080	—	ஈ. வீரகத்தி	ஹெடி	0 2 11	20 0
7081	வி. தம்பையா	அரசாட்சியார	திருகச்சப்பட்டதரை	0 0 35	5 0
சூழிச்சி—மருதடிச்சேனை.					
7085	எம். கியாகப்பா	அரசாட்சியார	தெனனை	0 1 10	10 C
7086	ஏ. தம்பிமுத்து	ஹெடி	ஹெடி	1 0 9	20 0
7088	சி. சித்தன	ஹெடி	வெறுமையானதரை	0 0 38	5 0
7093	ஏ. கந்தவனம்	ஹெடி	தெனனை	0 0 34	20 0
7094	எஸ். வேலுப்பிள்ளை	ஹெடி	எலும்பிச்சை	0 0 36	10 0
7097	—	வி. கந்தப்பன	தெனனை	0 0 26	20 0
7098	—	என். சூப்பையா	வெறுந்தரை	0 0 25	20 0
7099	—	ஹெடி	தெனனை	0 0 24	15 0
7100	—	கோணுத்தை	ஹெடி	0 1 0	25 0
7103	என். நாகமணி	அரசாட்சியார	ஹெடி	0 1 12	15 0
7104	கே. சினனவன	ஹெடி	ஹெடி	0 2 35	20 0

1820 பிளான இலக்கம் 1,145. சூழிச்சி—தோப்பூர். தோட்டத்திற்கேற்ற காடு 28 1 4 12 50

ஒடுக்க சூழிச்சி—முட்டச்சேனை. பிளான இலக்கம் 2,053. சூழிச்சி—முட்டச்சேனை. கொளவனவுகாரன். வயல 10 0 32 15 0

6761 முருகப்பா தம்பிப்பிள்ளை வயல 6 1 0 15 0

6765 கே. கட்டாடிமுருகன் பிளான இலக்கம் 1,629. சூழிச்சி—பள்ளிகுடியிருப்பு. மந்துகாடு 0 3 35 15 0

4728 சினனத்தம்பி கணவதிப்பிள்ளை பகிர்த்தம்பி அகமது வெலுவை ஹெடி 0 3 34 20 0

9984 பிளான இலக்கம் 830. சூழிச்சி—முதா. சேகுமதார முகமது மதார காடு 17 2 0 12 50

9985 ஹெடி காடு 20 0 25 12 50

6693 பிளான இலக்கம் 2,037. சூழிச்சி—ஆனைத்தீவு. வி. சினனத்தம்பியு மறுபேரும வயல 4 0 20 20 0

6696 ஹெடி வயல 4 1 26 20 0

6734 பிளான இலக்கம் 2,050. சூழிச்சி—ஈச்சிலம்பத்தை. வீரகத்தி பகதினியார வயல 2 3 16 20 0

6756 பிளான இலக்கம் 2,052. எஸ். உடையார பெரிய தம்பியு ஹெடிபேரும வயல 4 0 35 20 0

6757 சுப்பா முருகன் வயல 5 2 26 15 0

11936 பிளான இலக்கம் 971. சூழிச்சி—மலலிகைத்தீவு. பி. கதிராமத்தம்பியு மறுபேரும காடு 10 0 31 20 0

7497 பிளான இலக்கம் 2,238. சூழிச்சி—பலவிசூடியிருப்பு கந்தப்பா செலப்பா காடு 4 1 2 15 0

7498 ஹெடி காடு 0 1 13 15 0

A 352 பிளான இலக்கம் 975. சூழிச்சி—முதா. சேகுமதார உடையார தோட்டம் 0 0 28 10 0

11953 அகமதுநெயிரு முகமது ராப்பு ஹெடி 0 2 35 10 0

இக்காரணிகளைப்பற்றிய மேலதிக விவரம் அளவைத்தலைவரிடத்திலும் விற்பனையின் கொந்தீசுகளைப்பற்றி திரிகோணமலை உதவி ஏசுனரிடத்திலும் மறிந்துக்கொள்ளலாம்.

தேசாதிபதி மகோத்தமா அவர்களினது கட்டளையின்படி, ஈ. நேர்வெல உவாச்சர், இராசாங்க விதிதர்.

No. 727, E. P.

Colonial Secretary's Office,
Colombo, November 1, 1898.

ON Tuesday, December 20, 1898, and the following days, at 12 noon, the Assistant Government Agent for the Trincomalee District will put up to auction, at his office in Trincomalee, the under-mentioned portions of Crown Land, on the terms authorized by Government.

Fifty-three allotments of land situated in the Kaddukulam division of the Trincomalee District of the Eastern Province.

Lot.	Name of Applicant.	Name of Claimant.	Description.	Extent.			Upset Price per Acre.	
				A.	R.	P.	Rs.	c.
Preliminary plan 508. Village—Nilaveli.								
4923	K. Katiramalai and one	Crown	Jungle	2	2	31	12	50
4924	Do.	do.	Jungle and chenai	13	0	24	12	50
4930	—	do.	Open and jungle	6	1	26	12	50
B 164	—	do.	Cocoanut and paddy	6	2	8	12	50
Preliminary plan 509. Village—Nilaveli.								
4933	O. Mammatu Meytin	Crown	Jungle	3	2	24	12	50
Preliminary plan 510. Village—Nilaveli.								
4935	Kadduvava Aliyar	Crown	Jungle	3	3	26	10	0
4936	K. Seeni	do.	do.	2	0	10	10	0
4937	Pakkir Kater	do.	Open land	1	0	32	10	0
4938	Kadduvava Seeni	do.	do.	3	1	0	10	0
Preliminary plan 580. Village—Kumpurupiddi.								
6174	—	Crown	Paddy	6	1	20	12	50
Preliminary plan 715. Village—Kuchchaveli.								
Z 294	—	L. M. Abdulcader	Paddy	10	2	9	12	50
A 295	—	K. Velupillai and K. R. Matarsaib	do.	12	3	18	12	50
B 295	—	Vairavy Nakamuttu	do.	26	2	5	12	50
C 295	—	Kanapatiudayar Katiraman	do.	13	2	10	12	50
Preliminary plan 716. Village—Kuchchaveli.								
D 295	—	S. Velantan	Paddy	4	1	30	12	50
Preliminary plan 727. Village—Tiriyai.								
X 298	—	Temple Pillaiyar Kovil	Paddy	8	2	26	20	0
B 299	—	K. Kantapillai	do.	5	2	9	12	50
C 299	—	Udaiyananchan Vannichiar	do.	5	3	0	12	50
E 299	—	K. Supramaniam	do.	5	0	9	12	50
G 299	—	K. Kanthapillai	do.	4	0	32	12	50
8926	—	K. Umapati	High land	1	0	19	12	50
Preliminary plan 791. Village—Tennamaravadi.								
9555	V. V. Venaithirtan	Crown	Open	4	2	27	12	50
Preliminary plan 1,773. Village—Nilaveli.								
5673	—	Crown	Jungle	0	2	24	10	0
5674	—	do.	do.	3	2	0	10	0
5675	—	do.	do.	3	0	37	10	0
5683	—	do.	do.	10	2	24	10	0
5686	—	do.	do.	9	2	23	10	0
5688	—	do.	Open land	1	1	34	10	0
Preliminary plan 2,417. Village—Madawachchi.								
76303	O. Punchirala	Crown	Young cocoanut	0	1	4	12	50
76304	Do.	do.	Open, uncultivated	0	2	33	12	50
Preliminary plan 1,889. Village—Kumpurupiddi.								
6164	—	Crown	Paddy	1	1	29	12	50
6165	—	do.	do.	4	2	35	12	50
Preliminary plan 1,938. Village—Puluvoddai.								
6337	A. Meytinpichchai	Crown	Paddy	3	0	21	12	50
Preliminary plan 2,049. Village—Puluvoddai.								
6750	K. M. Akamatulevvai	Crown	Jungle	2	0	38	10	0
Preliminary plan 2,057. Village—Kuchchaveli.								
6769½	M. W. Sangarapillai	Crown	Open fit for paddy	1	1	34	12	50
Preliminary plan 2,058. Village—Vitpanaikulam.								
6779	Chellattai and others	Crown	Jungle fit for paddy	4	3	8	12	50
6780	Do.	do.	do.	0	2	29	12	50
Preliminary plan 2,071. Village—Kuchchaveli.								
6843	—	Crown	Jungle	1	2	7	10	0
6846	V. Kappa Udaiyar	do.	do.	1	1	37	10	0
Preliminary plan 2,150. Village—Kuchchaveli.								
7089	V. Mammattutampi	Crown	Open fit for paddy	9	1	38	12	50
Preliminary plan 2,152. Village—Puluvoddai.								
7091	Asanar Sleyman	Crown	Young cocoanut	0	0	21	12	50
Preliminary plan 2,211. Village—Amerivayal.								
7420	Kanther Kasinater	Crown	Open and jungle fit for paddy	2	2	30	12	50
Preliminary plan 2,213. Village—Puluvoddai.								
7428	P. Meytinbawa	Crown	Paddy	1	0	17	12	50

Lot.	Name of Applicant.	Name of Claimant.	Description.	Extent.		Upset Price
				A.	R. P.	per Acre. Rs.
		Preliminary plan 1,611. Village—Nilaveli.				
4449½	Mr. H. V. Lushington	Crown	Reservation	1	2 27	12 50
4451½	Do.	do.	do.	1	0 27	12 50
4453½	Do.	do.	do.	2	0 15	12 50
4464½	Do.	do.	do.	1	0 29	12 50
4476½	Do.	do.	do.	0	2 28	12 50
		Preliminary plan 581. Village—Kumpurupiddi.				
6177	Sitamperi Sinnatampi	Crown	Jungle and paddy	6	3 22	12 50
Y 195	—	Kanda Udayar Konattai	Paddy	20	0 22	15 0
		Preliminary plan 2,554. Village—Nilaveli.				
76893	Mootan Kanthan	Crown	Jungle and open	3	3 14	12 50
76894½	—	do.	Salt swamp	16	1 0	10 0
76894¾	—	do.	do.	19	3 25	10 0

Further information respecting these lands may be obtained from the Surveyor-General, and respecting the conditions of sale from the Assistant Government Agent, Trincomalee.

By His Excellency the Governor's command,

E. NOEL WALKER,
Colonial Secretary.

No. 727, E. P.

கொலோனியல் சர்க்குர்த்தார் ஆபீசில்,
கொழும்பில், 1898 ம் வருஷ கார்த்திகைமீ 1 ந் உ.

1898 ம் ஆண்டு மார்ச்சுமாதம் 20 ந் திகதி செவ்வாய்க்கிழமை மத்தியானம் 12 மணிக்கு மதனையடுத்த நாட்களிலும் தன் ஆபீசில் கீழ் மாகாணத்து திரிக்கோணமலை உதவி சுவற்றணமேந்து ஏசுந்றவர்களால் இந்ளடியிற் சொல்லப்பட்டிருக்கிற முடிக்குரிய காணித்துண்டுகளை, அரசாட்சியாரால் உத்தரவுபண்ணப்பட்டிருக்கும் பொருத்தப்பிரகாரம் வலத்திற்குறி விற்கப்படும்.

53 காணித்துண்டுகள், கீழ் மாகாணத்து திரிக்கோணமலை டிஸ்திரிக்டின் கட்டுக்குளப் பகுதியிலிருக்கின்றது.

பிளான் இலக்கம் 508. குறிச்சி—நிலாவெளி.

இல.	கேள்விக்காரன்.	உரித்தானி.	விவரம்.	விசாலம்.		திட்டவிலை அக்கருக்கு ரூ. ச.
				அ. து. ப.	ரூ. ச.	
4923	கே. கதிரமலையு மறு பெரும்	அரசாட்சியார்	காடு	2	2 31	12 50
4924	—	ஷெ	காடும் சேணயும்	13	0 24	12 50
4930	—	ஷெ	காடும் வெளியும்	6	1 26	12 50
B 164	—	ஷெ	தெண்ணையும் வயலும்	6	2 8	12 50
		பிளான் இலக்கம் 509.				
4933	உ. மம்மது மெய்தின்	அரசாட்சியார்	காடு	3	2 24	12 50
		பிளான் இலக்கம் 510.				
4935	காட்டுவாவா அலியார்	அரசாட்சியார்	காடு	3	3 26	10 0
4936	கே. சீனி	ஷெ	காடு	2	0 10	10 0
4937	பக்கீர் காதர்	ஷெ	திறப்பானதரை	1	0 32	10 0
4938	காட்டுவாவா சீனி	ஷெ	ஷெ	3	1 0	10 0
		பிளான் இலக்கம் 580. குறிச்சி—கும்புறுபிடடி.				
6174	—	அரசாட்சியார்	வயல	6	1 20	12 50
		பிளான் இலக்கம் 715. குறிச்சி—குச்சுவெளி.				
Z 294	—	எஸ். எம். அப்துலகாதர்	வயல	10	2 9	12 50
A 295	—	கே. வேலுப்பிள்ளையும் மதார்சாய்யும்	வயல	12	3 18	12 50
B 295	—	வயிரவி நாகமுத்து	வயல	26	2 5	12 50
C 295	—	கணபதி உடையார் கதி ராமன்	வயல	13	2 10	12 50
		பிளான் இலக்கம் 716.				
D 295	—	எஸ். வேலாயுதன்	வயல	4	1 30	12 50
		பிளான் இலக்கம் 727. குறிச்சி—திரியாய.				
X 298	—	பிள்ளையார்கோவில்	வயல	8	2 26	20 0
B 299	—	கே. கந்தபன்	வயல	5	2 9	12 50
C 299	—	உடையான் நாச்சன் வண்ணிச்சியார்	வயல	5	3 0	12 50
E 299	—	கே. சுப்பிரமணியம்	வயல	5	0 9	12 50
G 299	—	கே. கந்தப்பிள்ளை	வயல	4	0 32	12 50
8926	—	கே. உமாபதி	மேட்டுத்தரை	1	0 19	12 50
		பிளான் இலக்கம் 791. குறிச்சி—தென்னமாவடி.				
9555	வ. வி. வீணதீர்த்தான்	அரசாட்சியார்	திறப்பானதரை	4	2 27	12 50

இல.	கேள்விக்காரன்.	உரித்தரளி.	விவரம்.	விசாலம்.			திட்டவிலை	
				அ.	நூ.	ப.	ரூ.	ச.
		பிளான் இலக்கம் 1,773.	குறிச்சி—நிலாவெளி.					
5673	—	அரசாட்சியார்	காடு	0	2	24	10	0
5674	—	ஹை	காடு	3	2	0	10	0
5675	—	ஹை	காடு	3	0	37	10	0
5683	—	ஹை	காடு	10	2	24	10	0
5686	—	ஹை	காடு	8	2	23	10	0
5688	—	ஹை	திறப்பானதரை	1	1	34	10	0
		பிளான் இலக்கம் 2,417.	குறிச்சி—மதவச்சி.					
76303	ஓ. புஞ்சிமுனை	அரசாட்சியார்	தென்னை	0	1	4	12	50
76304	ஹை	ஹை	செய்கைபண்ணை திறப்பானதரை	0	2	33	12	50
		பிளான் இலக்கம் 1,889.	குறிச்சி—கும்புறுபிடடி.					
6164	—	அரசாட்சியார்	வயல	1	1	29	12	50
6165	—	ஹை	வயல	4	2	35	12	50
		பிளான் இலக்கம் 1,938	குறிச்சி—புலமோட்டை.					
6337	எ. மெய்தின்பிச்சை	அரசாட்சியார்	வயல	3	0	21	12	50
		பிளான் இலக்கம் 2,049.						
6750	கே. எம். அகமதுலெவ்வை	அரசாட்சியார்	காடு	2	0	38	10	0
		பிளான் இலக்கம் 2,057.	குறிச்சி—குச்சுவெளி.					
6769½	எம். டபிள்யூ. சங்கரபிள்ளை	அரசாட்சியார்	நெற்கேற்ற வெளி	1	1	34	12	50
		பிளான் இலக்கம் 2,058.	குறிச்சி—விற்பனாகுளம்.					
6779	செல்லாத்தையு மறுபேரும்	அரசாட்சியார்	நெற்கேற்ற காடு	4	3	8	12	50
6780	ஹை	ஹை	ஹை	0	2	29	12	50
		பிளான் இலக்கம் 2,071.	குறிச்சி—குச்சுவெளி.					
6843	—	அரசாட்சியார்	காடு	1	2	7	10	0
6846	வீ. கப்பலடையார்	ஹை	காடு	1	1	37	10	0
		பிளான் இலக்கம் 2,150.						
7089	வீ. மம்மதுதம்பி	அரசாட்சியார்	நெற்கேற்ற காடு	9	1	38	12	50
		பிளான் இலக்கம் 2,152.	குறிச்சி—புலமோட்டை.					
7091	அசனூர் சிலைமான்	அரசாட்சியார்	தென்னை	0	0	21	12	50
		பிளான் இலக்கம் 2,211.	குறிச்சி—அமரிவயல.					
7420	கந்தர் காசிநாதர்	அரசாட்சியார்	நெற்கேற்ற திறப்பான காடு	2	2	30	12	50
		பிளான் இலக்கம் 2,213.	குறிச்சி—புலமோட்டை.					
7428	பி. மெய்தின்வாவா	அரசாட்சியார்	வயல	1	0	17	12	50
		பிளான் இலக்கம் 1,611.	குறிச்சி—நிலாவெளி.					
4449½	எச். வி. லசிமுறந்துரை அவர்கள்	அரசாட்சியார்	விலக்கிவைக்கப்பட்ட தரை	1	2	27	12	50
4451½	ஹை	ஹை	ஹை	1	0	27	12	50
4453½	ஹை	ஹை	ஹை	2	0	15	12	50
4464½	ஹை	ஹை	ஹை	1	0	29	12	50
4476½	ஹை	ஹை	ஹை	0	2	28	12	50
		பிளான் இலக்கம் 581.	குறிச்சி—கும்புறுபிடடி.					
6177	சிதம்பரி சின்னத்தம்பி	அரசாட்சியார்	வயலும் காடும்	6	3	22	12	50
Y 195	—	கந்தர்உடையார் கோணத்தை	வயல	20	0	22	15	0
		பிளான் இலக்கம் 2554.	குறிச்சி நிலாவெளி.					
76893	முத்தான் கந்தன்	அரசாட்சியார்	காடும் வெளியும்	3	3	14	12	50
76894½	—	ஹை	சவருள்ள சத்தியான தரை	16	1	0	10	0
76894¾	—	ஹை	ஹை	19	3	25	10	0

இக்காணிகளைப்பற்றிய மேலதிக விவரம் அளவடிவத்திலேவரிடத்திலும் விற்பனவின் கொந்தீசுகளைப்பற்றி திரிசோணமலை அரசாட்சியாரின் உதவி ஏசன்மரிடத்திலும் மறிந்துகொள்ளலாம்.

தேசாதிபதி மகோத்தமர் அவர்களினது கட்டளையின்படி,

ஈ. நோவல் உவாக்கர்,

இராசாங்க லிசுதர்.

No. 728, E. P.

Colonial Secretary's Office,
Colombo, November 1, 1898.

ON Tuesday, December 20, 1898, at 12 noon, the Assistant Government Agent for the Trincomalee District will put up to auction, at his office in Trincomalee, the under-mentioned portion of Crown Land, on the terms authorized by Government.

An allotment of land situated in the Kaddukulam division of the Trincomalee District of the Eastern Province.

Preliminary plan 2,554.

Lot.	Village.	Name of Applicant.	Name of Claimant.	Description.	Extent. A. R. P.
76894	Nilaveli	Mr. H. V. Lushington	Crown	Forest	259 0 0

Upset price,—Rs. 15 per acre.

Further information respecting this land may be obtained from the Surveyor-General, and respecting the conditions of sale from the Assistant Government Agent, Trincomalee.

By His Excellency the Governor's command,
E. NOEL WALKER,
Colonial Secretary.

No. 728, E. P.

கொலொனியல் சர்க்கிடுத்தார ஆபிசில்,
கொழும்பில், 1898 ம (வரு) கராத திகைமீ 1 ந் திகதி.

1898 ம ஆண்டு மாகாழிமாதம் 20 ந் திகதியாகிய செவ்வாய்க்கிழமை மத்தியானம் 12 மணிக்கு தன ஆபிசில் கீழ் மாகாணத்து திரிகோணமலை உதவ நவற்ணமேந்து ஏசனறவாகளால இதனடியிற் சொல்லப்பட்டிருக்கிற முடிக்கரிய காணித்துண்டை, அரசாட்சியாரால உதவரவண்ணப்பட்டிருக்கும் பொருத்தப்பிரகாரம் ஏலத்திற்குறி கற்ப்பப்படும்.

ஒரு காணித்துண்டு, கீழ் மாகாணத்து திரிகோணமலை மலத்திற்க்கின கடங்குளைய பகுதியிலிருக்கின்றன.

பிளான இலக்கம் 2,554. உரிததாளி—அரசாட்சியார்.

இல.	குறிச்சி.	கேள்விகாரண பெயர்.	வ்வரம்.	விசாலம். அ. ரூ. ப.	ஏக்கருக்கு ந். ச.
76894	நிலாவெளி	எச். வீ. லகிந்றன் துரை அவர்கள்	நாடு	259 0 0	15 0

இந்தக் காணியைப்பற்றிய மேலதீர்விய அளவைத் தலைவரி—த்திலும் கற்ப்பனயின கொந்தீசுகளைப் பற்றி திருகோணமலை அரசாட்சியாரின உதவ ஏசனறரிடத்திலும் அறிந்துகொள்ளலாம்.

தேசாட்சிபதி மகோத்தமர் அவர்களினது கட்டளையின்படி,

ஈ. நோவெல் உவாகர்,
இராசாங்க வித்தா.

No. 729, E. P.

Colonial Secretary's Office,
Colombo, November 3, 1898.

ON Tuesday, December 13, 1898, and the following days, at 12 noon, the Assistant Government Agent for the Trincomalee District will put up to auction, at his office in Trincomalee, the under-mentioned portions of Crown Land, on the terms authorized by Government.

Ninety-one allotments of land situated in the Kaddukulam, &c., divisions of the Trincomalee District of the Eastern Province.

Preliminary plan 786. Claimant—Crown.

Lot.	Village.	Name of Applicant.	Description.	Extent. A. R. P.	Upset Price per Acre. Rs. c.
G 321	Pulmoddai	S. Katirumera	Open and bushy	4 1 30	12 50
H 321	Do.	do.	do.	4 0 19	12 50
Preliminary plan 2,316.					
75931	Sinnakiniyai	Abdulla Amir	Scrub	0 1 6	13 0
75936	Do.	Pakirpillai Mirasa	—	0 0 14	10 0
Preliminary plan 2,444.					
76423	Kumpurupiddy	Konan Chinnaddi	Occupied	0 0 5	12 50
76424	Do.	Mahankonan	do.	0 0 16	12 50
Preliminary plan 715.					
X 294	Kuchcheveli	Ramalingakurukal Kartikesapillai	Paddy	7 2 29	12 50
Defau't Lands.					
Preliminary plan 2,049.					
Name of Purchaser.					
6751	Pulmoddai	Pakkir Akamatulevvai	Paddy	1 3 19	20 0

Lot.	Village.	Name of Purchaser.	Description.	Extent.		Upset Price per Acre.	
				A.	R. P.	Rs.	c.
Preliminary plan 2,010.							
6543	Kandalkadu	Achchipillai Sinnattampi	Paddy	4	0 23	12	50
6544	Do.	do.	do.	0	1 10	12	50
6548	Do.	A. H. Utumalevvai Maraikar Hajjar	do.	7	1 8	12	50
6549	Do.	Velanther Kartikesu	do.	8	2 22	12	50
6550	Do.	do.	do.	0	1 13	12	50
6551	Do.	do.	do.	0	3 37	12	50
6552	Do.	Kantapper Ramalingam	do.	5	0 7	12	50
6545	Do.	Kuppaitampi Sekumatar	do.	3	1 9	12	50
6546	Do.	do.	do.	0	0 24	12	50
6547	Do.	do.	do.	0	0 26	12	50
Preliminary plan 2,012.							
6562	Kandalkadu	Perupillai Muhaiatheenvava	do.	30	1 34	12	50
Preliminary plan 2,038.							
6699	Kiliveddi	Nallatampi Sinnappu	do.	4	2 25	22	0
6701	Do.	do.	do.	2	3 11	15	0
Preliminary plan 2,040.							
6719	Do.	Kaliapper Sittakkuddi	do.	0	3 30	15	0
6720	Do.	Sanmukam Konamalai and one	do.	2	2 0	15	0
6721	Do.	Katiravelu Saravanamuttu and one	do.	1	1 20	15	0
Preliminary plan 2,052.							
6755	Dehilampattai	Ariaperumal Kanavati	do.	12	1 12	25	0
Preliminary plan 2,053.							
6762	Muddichenai	Viriadappan Velupullai and one	do.	5	2 32	15	0
6616	Kinniyai	Sinnattampi Vappu	do.	9	2 5	15	0
6617	Do.	do.	do.	0	1 2	20	0
6618	Do.	Sekusaib Katermasthan	do.	5	1 12	30	0
6619	Do.	Abtulcader Muhaiateenvava	do.	10	3 10	15	0
6620	Do.	Mirasaibu Mahatu Meytin	do.	1	1 29	11	0
6628	Do.	do.	do.	3	1 9	15	0
6629	Do.	Mirasaibu Mahatu Meytin	do.	0	0 8	15	0
6630	Do.	do.	do.	0	0 38	15	0
6631	Do.	do.	do.	0	0 18	15	0
Preliminary plan 2,046.							
6737	Pulmoddai	Mirasaivu Ayina	do.	3	2 24	15	0
Preliminary plan 2,025.							
6632	Kinniyai	Maraikayer Muhamateenvava and one	do.	6	0 10	20	0
6633	Do.	Sinnathampi Senimamatu and one	do.	11	1 33	20	0
Preliminary plan 2,063.							
6785	Kandalkada	Kanavatipillai Vallipurampillai	do.	7	0 0	30	0
Preliminary plan 723.							
W 298	Kuchcheveli	Kanavatipillai Vallipurampillai	do.	8	3 24	12	50
Preliminary plan 1,452.							
3553	Kanniyai	Kanavatipillai Vallipurampillai	do.	9	3 7	20	0
Preliminary plan 546.							
5375	Do.	Abutulcader Mohamatutampi Maraikar	do.	5	0 10	12	50
Preliminary plan 2,018.							
6580	Tampalakam	A. H. Utumalevvai Maraikayer	do.	0	1 19	15	0
6583	Do.	do.	do.	0	0 15	15	0
6585	Do.	do.	do.	4	0 18	15	0
6587	Do.	do.	do.	1	3 38	15	0
6588	Do.	do.	do.	3	2 5	30	0
6589	Do.	do.	do.	2	0 19	15	0
Preliminary plan 2,078.							
6864	Do.	Kaliappar Subaramaniam	do.	1	0 18	15	0
6865	Do.	do.	do.	2	0 36	30	0
6866	Do.	do.	do.	0	0 28	15	0
6867	Do.	do.	do.	1	0 19	30	0
Preliminary plan 2,084.							
6889	Kandalkadu	Murukapper Tamotaram	do.	6	2 26	12	50
6890	Do.	Kurunati Nakamuttu	do.	1	0 38	15	0
Preliminary plan 547.							
Q 175	Kinniyai	Nurtin Sarippu	do.	8	0 10	15	0
Preliminary plan 15.							
813	Kuchcheveli	K. M. M. Kabibu Saibu	do.	7	3 13	12	50
Preliminary plan 715.							
W 294	Do.	Velupillai Umaipakan	do.	5	0 8	12	50

Lot.	Village.	Name of Purchaser.	Description.	Extent.		Upset Price
				A.	R. P.	per Acre. Rs. c.
I 299	Siriyai	Preliminary plan 727. Kanapatipillai Vallipurampillai	Paddy	11	0 7	12 50
6324	Do.	Preliminary plan 1,935. Komaru Subramaniam	do.	0	3 28	12 50
6325	Do.	do.	do.	1	0 37	12 50
6326	Do.	K. M. M. Kabibu Saibu	do.	1	2 33	12 50
6253	Kappalurai	Preliminary plan 1,908. Katiramer Konamalai	do.	12	1 22	12 50
1323	Kinniyai	Preliminary plan 1,088. Kanapatipillai Vallipurampillai and two	do.	14	1 2	25 0
B 3	Sampur	Preliminary plan 983. Kantapper Verakutti	do.	1	0 36	12 50
49	Do.	do.	do.	1	0 12	12 50
5730	Do.	Preliminary plan 1,778 Marimuttu Kadiramampai	do.	7	1 14	15 0
47	Do.	Preliminary plan 983. Kurunatapillai Mutatampi	do.	3	0 37	12 50
50	Do.	do.	do.	3	2 30	12 50
Y 2	Do.	Katiraveli Katamuttu	do.	1	2 22	12 50
Z 2	Do.	do.	do.	0	2 25	12 50
7582	Topur	Preliminary plan 2,264. Pakkirtampilevvai Umarulevvai	do.	1	1 32	30 0
7584	Do.	Sinivarisai Vapputampi	do.	0	0 16	20 0
8557	Andankulam	Preliminary plan 689. Ilayatampi Sivakurunatar	do.	16	3 35	12 50
8543	Do.	Murukapper Vairamuttu	do.	6	2 28	12 50
9767	Tampalakam	Preliminary plan 811. Kanapatipillai Vallipurampillai	do.	26	1 39	12 50
25	Topur	Preliminary plan 982. Mirasaibu Mamsa and one	do.	3	1 31	12 50
4716	Kankuveli	Preliminary plan 1,627. Konamalai Nakamuttu and two	do.	15	3 5	12 50
8925	Tiriyai	Preliminary plan 727. Kanapatipillai Vallipurampillai	do.	5	3 19	12 50
7001	Tampalakam	Preliminary plan 2,121. Mohamatu Assen Sheriff	do.	0	1 10	15 0
7002	Do.	do.	do.	6	1 7	20 0
7003	Do.	do.	do.	0	1 26	15 0
7004	Do.	do.	do.	1	2 9	20 0
7005	Do.	do.	do.	1	0 22	20 0
7006	Do.	do.	do.	3	1 32	20 0
7305	Kavaddikuda	Preliminary plan 2,187. Sinnattan Supiramaniam	do.	3	3 39	12 50
76667	Kinniyai	Preliminary plan 2,492. Kupaiyar Velupillai	do.	0	1 28	20 0
76671	Do.	Tampapillai Velanthan	do.	0	0 35	15 0
76672	Do.	do.	do.	0	0 29	25 0
76939	Town of Trincomalee	Preliminary plan 2,651. Muruker Velan	Jungle	17	0 30	10 0
76896	Ralapanawa	Preliminary plan 2,556. Kadithekamarala	Suitable for paddy	0	1 26	10 0
76897	Do.	do.	do.	0	2 19	10 0

Further information respecting these lands may be obtained from the Surveyor-General, and respecting the conditions of sale from the Assistant Government Agent, Trincomalee.

By His Excellency the Governor's command,

E. NOEL WALKER,
Colonial Secretary.

No. 729, E. P.

கொலோனியல் சுககிடுததார ஆபீசில்,
கொழும்பில், 1898 ம் ஆண்டு கார்த்திகை மீ 3 ந் வ.

1898 ம் ஆண்டு மார்ச்சுமாதம் 13 ந் திகதி செவ்வாய்க்கிழமை பிற்பகல் 12 மணிகளும் அடுத்த நாட்களிலும் தன் ஆபீசில் கீழ்க்காணத்தகு திரிகோணமலை உதவ கவண்மேந்து ஏசுந்ரவர்களால் இதனடியிற் சொல்லப்பட்டிருக்கிற முடிக்கூரிய காணித் துண்டுகளை, அரசாட்சியாரால் உதவவுபண்ணப்பட்டிருக்கும் பொருத்தப்பிரகாரம் ஏலத்திற்குறி விற்கப்படும்.

91 காணித் துண்டுகள், கீழ்க்காணத்தகு திரிகோணமலை டிஸ்திரிக்கின கட்டுக்குளம் தம்பலகமம் கொட்டியாரா பகுதிகளிலிருக்கின்றது.

பிளான இலக்கம் 786. கேள்விகாரண—எஸ். கதிருமீரா.

இல.	குறிச்சி.	உரிததாளியின பெயர்.	விவரம்.	விசாலம்.	திட்டவீலை
G 321	புலமோட்டை	அரசாட்சியார	கிறப்பும் பதையும	அ. நூ. ப.	ஏக்கருக்கு ரூ. ச.
H 321	ரெடி	ரெடி	ரெடி	4 1 30	12 50
75931	பிளான இலக்கம் 2,360. கேள்விகாரண—அ. அமீரா.	அரசாட்சியார	பததை	4 0 19	12 50
75936	ரெடி	அரசாட்சியார	—	0 1 6	12 0
76423	பிளான இலக்கம் 2,444. கேள்விகாரண—கொ. சின்னட்டி.	அரசாட்சியார	சூடியிருப்பு	0 0 14	10 0
76424	ரெடி	அரசாட்சியார	சூடியிருப்பு	0 0 5	12 50
X 294	பிளான இலக்கம் 715. கேள்விகாரண—இ. கார்த்திகேசிபிள்ளை.	அரசாட்சியார	சூடியிருப்பு	0 0 16	12 50
6751	புலமோட்டை	பிளான இலக்கம் 2,049. கேள்விகாரண—கொளவனவுகாரண.	தெற்றரை	7 2 29	12 50
6543	கண்டலகாடு	பிளான இலக்கம் 2,010.	ரெடி	1 3 19	20 0
6544	ரெடி	ஆ. சின்னத்தம்பி	ரெடி	4 0 23	12 50
6548	ரெடி	ரெடி	ரெடி	0 1 10	12 50
6549	ரெடி	எ. எச். உ. மரக்காயா கச்சியார	ரெடி	7 1 8	12 50
6550	ரெடி	வே. கார்த்திகேசு	ரெடி	8 2 22	12 50
6551	ரெடி	ரெடி	ரெடி	0 1 13	12 50
6552	ரெடி	ரெடி	ரெடி	0 3 37	12 50
6545	ரெடி	க. இராமலிங்கம்	ரெடி	5 0 7	12 50
6546	ரெடி	க. செஞ்சுமதாரா	ரெடி	3 1 9	12 50
6547	ரெடி	ரெடி	ரெடி	0 0 24	12 50
6562	கண்டலகாடு	பிளான இலக்கம் 2,012.	ரெடி	0 0 26	12 50
6699	கிளிவெட்டி	பி. முகையதீனவாவா	ரெடி	30 1 34	12 50
6701	ரெடி	பிளான இலக்கம் 2,038.	ரெடி	4 2 25	22 0
6719	கிளிவெட்டி	ந. சின்னப்ப	ரெடி	2 3 11	15 0
6720	ரெடி	ரெடி	ரெடி	0 3 30	15 0
6721	ரெடி	பிளான இலக்கம் 2,040.	ரெடி	2 2 0	15 0
6755	ஈச்சிலம்பத்தை	கா. சித்தககுட்டி	ரெடி	1 1 20	15 0
6762	முட்டிச்சேனை	ச. கோணமலை	ரெடி	12 1 12	25 0
6616	கிணியா	க. சரவணமுத்து	ரெடி	5 2 32	15 0
6617	ரெடி	பிளான இலக்கம் 2,052.	ரெடி	9 2 5	15 0
6618	ரெடி	அ. கணவதி	ரெடி	0 1 2	20 0
6619	ரெடி	பிளான இலக்கம் 2,053.	ரெடி	5 1 12	20 0
6620	ரெடி	வீ. அ. வேலுப்பிள்ளை	ரெடி	10 3 10	15 0
6628	ரெடி	பிளான இலக்கம் 2024.	ரெடி	1 1 29	11 0
6629	ரெடி	சி. வாப்பு	ரெடி	3 1 9	15 0
6630	ரெடி	ரெடி	ரெடி	0 0 8	15 0
6631	ரெடி	ரெடி	ரெடி	0 0 38	15 0
6737	புலமோட்டை	பிளான இலக்கம் 2,046.	ரெடி	0 0 18	15 0
6632	கிணியா	மீ. அயினியா	ரெடி	3 2 24	15 0
6633	ரெடி	பிளான இலக்கம் 2,025.	ரெடி	6 0 10	20 0
6785	கண்டலகாடு	ம. முகையதீனவா	ரெடி	11 1 33	20 0
W 298	சூச்சுவெளி	சி. சீனிமமமது	ரெடி	7 0 0	30 0
		பிளான இலக்கம் 2,063.	ரெடி	8 3 24	12 50
		பிளான இலக்கம் 723.	ரெடி		
		க. வலவிபுரம்பிள்ளை	ரெடி		

இல.	குறிச்சி.	உரித்தானியின் பெயர்:	விவரம்.	விசாலம்.		திட்டவிலை	
				அ. மு. ப.	ரூ. ச.	ரூ.	ச.
3553	கிணியா	பிளான இலக்கம் 1,452. க. வலவிபுரம்பிள்ளை	நெற்றரை	9	3	7	20 0
5375	கிணியா	பிளான இலக்கம் 546. அ. முகமதுதம்பி மரக்காயா	செடி	5	0	10	12 50
6580	தம்பலகமம்	பிளான இலக்கம் 2,018. எ. எச். உதுமாவெவ்வை மரக்காயா	செடி	0	1	19	15 0
6583	செடி	செடி	செடி	0	0	15	15 0
6585	செடி	செடி	செடி	4	0	18	15 0
6587	செடி	செடி	செடி	1	3	38	15 0
6588	செடி	செடி	செடி	3	2	5	30 0
6589	செடி	செடி	செடி	2	0	19	15 0
6864	தம்பலகமம்	பிளான இலக்கம் 2,078. கா. சுப்பிரமணியம்	செடி	1	0	18	15 0
6865	செடி	செடி	செடி	2	0	36	30 0
6866	செடி	செடி	செடி	0	0	28	15 0
6867	செடி	செடி	செடி	1	0	19	30 0
6889	கண்டலுகர்டு	பிளான இலக்கம் 2,084. மு. தாமோதரம்	செடி	6	2	26	12 50
6890	செடி	சூ. நாகமுத்து	செடி	1	0	30	15 0
Q 175	கிணியா	பிளான இலக்கம் 547. நா. சரிப்பு	செடி	8	0	10	15 0
813	சூச்சுவளி	பிளான இலக்கம் 15. சே. எம். எம். கவிப்புசாயப	செடி	7	3	13	12 50
W 294	சூச்சுவளி	பிளான இலக்கம் 715. வே. உமைபாசன	செடி	5	0	8	12 50
I 299	இரியாய	பிளான இலக்கம் 727. க. வலவிபுரம்பிள்ளை	செடி	11	0	7	12 50
6324	இரியாய்	பிளான இலக்கம் 1,935. சூ. சுப்புரமணியம்	செடி	0	3	28	12 50
6325	செடி	செடி	செடி	1	0	37	12 50
6326	செடி	சே. எம். எம். கவிப்புசாயப	செடி	1	2	33	12 50
6253	கப்பலதுறை	பிளான இலக்கம் 1,908. க. கோணமலை	செடி	12	1	22	12 50
1323	கிணியாய	பிளான இலக்கம் 1,088. க. வலவிபுரம்பிள்ளையு மறு	செடி	14	1	2	25 0
B 3	சம்பூர்	பிளான இலக்கம் 983. க. வீரகத்தி	செடி	1	0	36	12 50
49	செடி	செடி	செடி	1	0	12	12 50
5730	சம்பூர்	பிளான இலக்கம் 1,778. மா. கஜிராமத்தம்பி	செடி	7	1	14	15 0
47	சம்பூர்	பிளான இலக்கம் 983. சூ. மூத்தத்தம்பி	செடி	3	0	37	12 50
50	சம்பூர்	சூ. மூத்த தம்பி	செடி	3	2	30	12 50
Y 2	செடி	க. காதமுத்து	செடி	1	2	22	12 50
Z 2	செடி	செடி	செடி	0	2	25	12 50
7582	தோப்பூர்	பிளான இலக்கம் 2,264. ப. உமறுவெவ்வை	செடி	1	1	32	30 0
7584	செடி	சி. வரப்புத்தம்பி	செடி	0	0	16	20 0
8557	ஆண்டாங்குளம்	பிளான இலக்கம் 689. இ. சிவசூருநாதா.	செடி	16	3	35	12 50
8543	செடி	மு. வயிரமுத்து	செடி	6	2	28	12 50
9767	தம்பலகமம்	பிளான இலக்கம் 811. க. வலவிபுரம்பிள்ளை	செடி	26	1	39	12 50
25	தோப்பூர்	பிளான இலக்கம் 982. மீ. மாம்சா	செடி	3	1	31	12 50
4716	கங்குவளி	பிளான இலக்கம் 1,627. கொ. நாகமுத்து மறுபேரும	செடி	15	3	5	12 50
8925	இரியாய	பிளான இலக்கம் 727. க. வலவிபுரம்பிள்ளை	செடி	5	3	19	12 50
7001	தம்பலகமம்	பிளான இலக்கம் 2,121. மு. அசன சாய்பு	செடி	0	1	10	15 0
7002	செடி	செடி	செடி	6	1	7	20 0
7003	செடி	செடி	செடி	0	1	26	15 0
7004	செடி	செடி	செடி	1	2	9	20 0
7005	செடி	செடி	செடி	1	0	22	20 0
7006	செடி	செடி	செடி	3	1	32	20 0
7305	கவாட்டிசூர்	பிளான இலக்கம் 2,187. சி. சுப்பிரமணியம்	தோட்டம்	3	3	39	12 50

இல.	குறிச்சி.	உரித்தாளியின் பெயர்.	விவரம்.	இடடவிலை	
				வீசாலம். அ. ரூ. ப.	எக்கருக்கு ரூ. ச.
			பிளான இலக்கம் 2,492.		
76667	கிணியா	கு. வேலுப்பிள்ளை	தோட்டம்	0 1 28	20 0
76671	ஹெ.	ச. வேலாயுதன்	ஹெ.	0 0 35	15 0
76672	ஹெ.	ஹெ.	ஹெ.	0 0 29	25 0
			பிளான இலக்கம் 2,561. கொளவனவுகாரண—முருகர்வேலன்.		
76939	இரிசோணமலை	பட்டணம் அரசாட்சியார்.	காடு	17 0 30	10 0
			பிளான இலக்கம் 2,556. கொளவனவுகாரண—தந்தாதத்தை கமரா.		
76896	மலப்பளவை	அரசாட்சியார்	நெல்லுக்கே		
			ற்ற. காடு	0 1 26	10 0
76897	ஹெ.	ஹெ.	ஹெ.	0 2 19	10 0

இக்காணிக்களுக்கெல்லாம் மேலதிக விவரம் அளவைத்தலைவரிடத்திலும், வீற்பனவன் கொந்தீச்சுகளைப் பற்றி இரிசோணமலை அரசாட்சியாரின் உதவி ஓசனறரிடத்திலும் மறிந்துகொள்ளலாம்.

தேசாதிபதி மகோதமர் யவர்களினது கட்டணியின்படி,
ஈ. நேரவெல உவாககா,
இராசாங்க விசிதா.

No. 730, E.P.

Colonial Secretary's Office,
Colombo, November 4, 1898.

ON Tuesday, December 20, 1898, at 12 noon, the Assistant Government Agent for the Trincomalee District will put up to auction, at his office in Trincomalee, the under-mentioned portions of Crown Land, on the terms authorized by Government.

Thirty-seven allotments of land situated in the Tampalakam division of the Trincomalee District of the Eastern Province.

Lot.	Village.	Name of Applicant.	Description.	Extent.		Upset Price per Acre.
				A. R. P.	Rs. c.	
Preliminary plan 2,350. Claimant—Crown.						
76042	Kinniyai	Adam Bawa Abdul Cader.	Paddy field	2 1 28		20 0
76043	Do.	do.	Suitable for paddy	1 2 7		10 0
76044	Do.	Abdulpillai M. Casim	do.	9 1 0		10 0
76045	Do.	Matar Ibrahim	do.	5 3 37		10 0
76046	Do.	do.	do.	2 0 34		10 0
76047	Do.	Sinna Vapu Hadju Meydin	High ground	0 0 22		10 0
76048	Do.	do.	Paddy field	8 1 39		15 0
Preliminary plan 1,143. Claimant—Crown.						
1816	Tampalakam	—	Swamp	5 0 7		10 0
Preliminary plan 711. Claimant—Crown.						
8821	Chinanvadi	Kater Mira Rawutter	Cocoonut garden	3 1 2		30 0
8824	Do.	M. Umboey and two others	Jungle	2 3 31.		12 0
Preliminary plan 541. Claimant—Crown.						
5147	Kinniyai	Alvar Sakara	Jungle fit for sundries	1 0 21		12 50
5148	Do.	C. Abdul Cader	do.	1 3 38		12 50
5149	Do.	S. Pakkirtampi	do.	1 0 18		12 50
5150	Do.	A. Ahamatu	do.	0 3 28		12 50
5151	Do.	P. H. Ismail and others	do.	2 1 2		12 50
5152	Do.	P. Romlin and others	do.	1 1 29		12 50
Default Lands.						
Preliminary plan 615.						
Name of Purchaser.						
6786	Do.	Abtulkader Meytin Bawa	Paddy	20 2 0		10 0
Preliminary plan 2,912.						
6555	Kandalkadu	Pirupillai Muheitin Bawa	Paddy	1 1 26		10 0
6556	Do.	do.	do.	0 0 36		10 0
6557	Do.	do.	do.	0 0 9		10 0
6558	Do.	do.	do.	0 0 34		10 0
6559	Do.	do.	do.	21 1 27		12 50
6560	Do.	do.	do.	0 2 37		10 0
6561	Do.	do.	do.	20 1 38		12 50
Preliminary plan 2,024.						
6628	Kinniyai	Mirasaipu Mahatu Meytin	Paddy	3 1 9		15 0
6629	Do.	do.	do.	0 0 8		15 0
6630	Do.	do.	do.	0 0 38		15 0
6631	Do.	do.	do.	0 0 18		15 0
Preliminary plan 2,078.						
6868	Tampalakam	Miskinpillai Mahat	Paddy	4 0 0		30 0
6869	Do.	do.	do.	9 0 0		12 50
6870	Do.	do.	do.	0 0 35		12 50

Lot.	Village.	Name of Purchaser.	Description.	Extent. A. R. P.	Upset Price per Acre. Rs. c.
6891	Kandalkadu	Ponniah Periyatampi	Paddy	2 2 15	12 50
6892	Do.	do.	do.	1 3 19	15 0
6554	Kappalturai	Katiramer Konamalai	Paddy	2 2 6	12 50
4849	Kinniyai	Vapu Hadjiar Seyatu Mammatu	Paddy	10 1 0	10 0
5764	Tampalakam	Kantapper Kanapatipillai	Garden	0 0 13	10 0
75928	Sinnakinniyai	Vapu Hadjiar Seyatu Mammatu	Waste	1 1 26	10 0

Further information respecting these lands may be obtained from the Surveyor-General, and respecting the conditions of sale from the Assistant Government Agent, Trincomalee.

By His Excellency the Governor's command,
E. NOEL WALKER,
Colonial Secretary.

No. 730, E. P.

கொலோனியல் சுககிற்றத்தாரா ஆபீசில்,
கொளும்படி, 1898 ம் (ஒரு) கார்த்திகைமீ 4 ந் வ.

1898 ம் ஆண்டு மார்ச்சுமாதம் 20 ந் திகதி செவ்வாய்க்கிழமை பிற்பகல் 12 மணிக்கு தன் ஆபீசில் கீழ் மாகாணத்து திரிகோணமலை உதவி சேவற்றமேந்து ஏசுன்றவர்களால் இதனடியிற் சொல்லப்பட்டிருக்கிற முடிக்கூரிய காணித்துண்டுகளை, அரசாட்சியாரால் உதரவுண்ணப்பட்டிருக்கும் பொருத்தப்பிரகாரமல்ல தற்கூறி விடப்பட்டும்.

37 காணித்துண்டுகள், கீழ் மாகாணத்து திரிகோணமலை டிஸ்ட்ரிக்டின தமபலகமப் பகுதியில் ருககின்றது.

பிளான இலககம் 2,350. உரித்தாளி—அரசாட்சியார்.

இல.	குறிச்சி.	கேள்விக்காரனின் பெயர்.	வியலம்.	விசாலம். அ. மூ. ப.	திட்டவிலை ஏக்கருக்கு. ரூ.
76042	கிணியா	ஆ. அப்துலகாதா	வயல	2 1 28	20
76043	ரெடி	ரெடி	நெற்கேற்ற தரை	1 2 7	10
76044	ரெடி	அ. எம். காசிம்	ரெடி	9 1 0	10
76045	ரெடி	மா. இவ்ருகிம்	ரெடி	5 3 37	10
76046	ரெடி	ரெடி	ரெடி	2 0 34	10
76047	ரெடி	சி. வா. கச்சுமெய்தீன்	மேட்டுத்தரை	0 0 23	10
76048	ரெடி	ரெடி	வயல	8 1 39	15
பிளான இலககம் 1,143.					
1816	தமபலகமம்	சுகதியானதரை		5 0 7	10
பிளான இலககம் 711.					
8821	சீனனவாடி	காதா மீரா ருவத்தா	தென்னதேரட்டம்	3 1 2	30
8824	ரெடி	எம். உமவாயு மறுபேரும்	காடு	2 3 31	12
பிளான இலககம் 541.					
5147	கிணியா	அ. சேககரா	பலபுரோசனங்களுக்கேற்றகாடு	1 0 21	12-50
5148	ரெடி	சி. அம்துலகாதா	ரெடி	1 3 38	12-50
5149	ரெடி	எஸ். பக்கோத்தம்பி	ரெடி	1 0 18	12-50
5150	ரெடி	எ. அகமது	ரெடி	0 3 28	12-50
5151	ரெடி	பி. எச். இஸ்மாயிலு மறுபேரும்	ரெடி	2 1 2	12-50
5152	ரெடி	பி. நமுள்ளிணு மறுபேரும்	ரெடி	1 1 29	12-50

பிளான இலககம் 615. ஒடுக்குப்பணங் கட்டத்தவறின காணிகள்.

இல.	குறிச்சி.	கேள்விக்காரனின் பெயர்.	வியலம்.	விசாலம். அ. மூ. ப.	திட்டவிலை ஏக்கருக்கு. ரூ.
6786	கிணியா	அப்துலகாதா முகைய தீனவாவா	வயல	20 2 0	10
பிளான இலககம் 2,012.					
6555	கண்டலகாடு	பீரூப்பிளான முகைய தீனவாவா	வயல	1 1 26	10
6556	ரெடி	ரெடி	வயல	0 0 36	10
6557	ரெடி	ரெடி	வயல	0 0 9	10
6558	ரெடி	ரெடி	வயல	0 0 34	10
6559	ரெடி	ரெடி	வயல	21 1 27	12-50
6560	ரெடி	ரெடி	வயல	0 2 37	10
6561	ரெடி	ரெடி	வயல	20 1 38	12-50

இல.	குறிச்சி.	கேள்விக்காரின் பெயர்.	விவரம்.	கிட்டவிகி விசாலம். ஏக்கருக்கு	
				அ. ரு. ப.	சூ.
பிளான இலக்கம் 2,024.					
6628	கிணியா	மிராசாயவு மாகாத்து மெய்தீன	வயல	3	1 9 15
6629	செடி	செடி	வயல	0	0 8 15
6630	செடி	செடி	வயல	0	0 38 15
6631	செடி	செடி	வயல	0	0 18 15
பிளான இலக்கம் 2,078.					
6868	தம்பலகமம்	மிஸ்கினாயினை மாகாத்து	வயல	4	0 0 30
6869	செடி	செடி	வயல	9	0 0 12.50
6870	செடி	செடி	வயல	0	0 35 12.50
பிளான இலக்கம் 2,084.					
6891	கண்டலகாடு	பொன்னையா பெரியதம்பி	வயல	2	2 15 12.50
6892	செடி	செடி	வயல	1	3 19 15
பிளான இலக்கம் 2,011.					
6554	கப்பலதூரை	கதிராமா கோணமலை	வயல	2	2 6 12.50
பிளான இலக்கம் 1,666.					
4849	கிணியா	வாப்புக்கச்சியா செய்யது மம்மது	வயல	10	1 0 10
பிளான இலக்கம் 1,791.					
5764	தம்பலகமம்	கந்தப்பா கணவதிப்பள்ளி தோட்டம்		0	0 13 10
பிளான இலக்கம் 2,316.					
75928	கிணையா	வாப்புக்கச்சியா செய்யது மம்மது புலனதரை		1	1 26 10

இக்காரணிகளைப்பற்றிய மேலதிக விவரம் அளவைத் தலைவரிடத்திலும் விற்பனவின் கொந்திசுகளைப் பற்றி திரிகோணமலை உதவி ஏசுன்றரிடத்திலும் மறிந்துகொள்ளலாம்.

தேசாதிபதி மகோத்தமா அவர்களினது கட்டளையின்படி,

ஈ. நோவெல் உவாக்கர்,

இராசாங்க விசிகர்.

No. 731, E. P.

Colonial Secretary's Office,
Colombo, November 8, 1898.

ON Tuesday, December 20, 1898, and the following days, at 12 noon, the Government Agent for the Eastern Province will put up to auction, at his office in Batticaloa, the under-mentioned portions of Crown Land, on the terms authorized by Government.

Lot.	Village.	Name of Applicant.	Description.	Extent.		Upset Price per Acre.	
				A.	R. P.	Rs.	c.
Preliminary plan 1,252.—Manmunai pattu.							
2809	Tevilamunai	M. Kunchilayappodi	Paddippalaikkadu	17	1 36	10	0
2811	Do.	do.	Nediamadukkadu	3	2 16	10	0
2812	Do.	do.	do.	15	0 15	10	0
2813	Do.	I. Muttappodi	do.	84	1 22	10	0
2814	Do.	K. Palakan, &c.	Nediamadupulukunavi-vaikkalkadu	20	0 25	10	0
2815	Do.	do.	do.	13	0 20	10	0
2817	Do.	General sale	Kalaipoddachenai	4	3 35	10	0
2818	Do.	K. Palakan	Nediamadukkadu	5	3 27	10	0
2820	Do.	General sale	do.	11	2 35	10	0
2821	Do.	K. Palakan	Jungle and field	30	2 6	10	0
2822	Ampilanturai	K. Chinnattampi	Milattuchenaikkadu	8	0 27	10	0
2823	Do.	General sale	do.	10	3 27	10	0
2824	Do.	N. Chempappodi	do.	16	3 4	10	0
2825	Do.	General sale	Chinnattalavaikkadu	16	2 8	10	0
2826	Do.	do.	do.	9	3 25	10	0
2827	Do.	Vaikali	Aiyerkulam	5	2 30	10	0
2829	Do.	General sale	Jungle	3	0 34	10	0
2830	Do.	do.	Manalpidiattumunmari	12	3 6	10	0
Preliminary plan 2,506.							
76756	Paddippalai	P. B. Kattamuttu	—	8	2 30	12	50
76757	Ampilanturai	do.	—	3	1 18	12	50
Preliminary plan 499.							
4787	Ampilanturai	Mailippodi Kunchilayappodi	Paddippalawelippumi	13	3 3	10	0
4788	Do.	I. Isuppulevvai	Tikkiriyankaddu	1	1 22	10	0
4793	Do.	T. Velappodi (defaulter)	Fit for paddy	10	2 25	10	0
4795	Do.	I. Katirkamappodi	Kulavadimadukkadu	7	3 4	10	0
4796	Do.	P. Kantappodi, &c.	Karaimadduchotiyankulat-tukkadu	15	3 15	10	0
4800	Do.	I. Katirkamappodi	Vaddavanpumi	7	3 35	10	0

Lot.	Village.	Name of Applicant.	Description.	Extent.		Upset Price per Acre.	
				A.	R. P.	Rs.	c.
4801	Ampilanturai	K. Mailipodi	Kalaipoddakuda	10	3 10	10	0
4801½	Do.	do.	do.	4	0 9	10	0
4802	Do.	V. Kumampodi, &c.	Fit for paddy	16	2 16	10	0
4803	Do.	do.	do.	6	0 25	10	0
4815	Do.	P. Muttan, &c.	Arasadittimpumi, fit for cocoanuts	3	1 11	10	0
4821	Do.	M. Palakappodi	do.	0	2 8	10	0
4829	Do.	K. Kanapatimunnilai	Paddippalaikudiyiruppupumi	5	0 33	10	0
Preliminary plan 2,448.—Porativu.							
76439	Mandur	K. Haiyatampi	Palamunaikkadu	0	2 2	10	0
76440	Do.	K. Vairen	Palamunaivalavu	0	0 23	10	0
76449	Do.	K. Katiraveli, &c.	Palamunaikkadu	8	2 31	10	0
76451	Do.	V. Venasakan, &c.	do.	3	2 36	10	0
76455	Do.	K. Kantappan	Viraiyadiyalavu	1	0 7	10	0
76465	Do.	V. V. Vinasittampi Udaiyar	Navalkadu	164	1 0	12	50
76467	Do.	do.	Field	2	0 12	12	50
76468	Do.	do.	Palaimunaikkadu	27	1 15	10	0
76473	Do.	K. A. Marimuttu	Navalkadu	20	2 0	10	0
Preliminary plan 406.—Sammanturai.							
3652	Mandur	V. Nakappan	Jungle	43	2 0	10	0
3653	Do.	S. V. Vimappodi	do.	48	0 0	10	0
3655	Do.	V. Nakappan and A. Kanapati	Open and jungle land	1	3 17	10	0
Preliminary plan 1,151.—Karaivaku pattu.							
7840½	Mavadippalli	S. Sein Mowlana	Fit for paddy	0	2 4	10	0
Preliminary plan 926.—Nadukadu pattu.							
11475	Varippattanchenai	P. H. Mirasaivu.	Atikarimadukkadu	13	1 8	10	0
11476	Do.	do.	do.	14	1 21	10	0
11477	Do.	General sale	do.	12	3 17	10	0
11478	Do.	do.	do.	10	2 11	10	0
11479	Do.	do.	do.	12	0 26	10	0
11480	Do.	do.	do.	13	0 36	10	0
Preliminary plan 1,008.							
338	Mallikaittivu	A. Utumalevvai	Fit for paddy	32	3 32	10	0
Preliminary plan 346.—Akkarai pattu.							
2594	Karunkoddittivu	P. H. Meyetinava	Fit for paddy	22	0 10	10	0
Preliminary plan 1,708.							
5233	Patankadu	L. Utumalevvai	Fit for paddy	14	0 13	10	0
Preliminary plan 1,169.—Panama.							
2052	Pottuvil	Mr. I. E. Carey	Uranikkadu	16	1 0	10	0
Preliminary plan 2,402. Eravur.							
76237	Vantarumulai	S. Akamatulevvai	Fit for cocoanut	6	0 0	10	0
76238	Do.	do.	do.	6	3 18	10	0
76239	Kaltuvankeni	A. Akamatulevvai	do.	1	3 24	10	0

Further information regarding these lands and conditions of sale may be obtained from the Government Agent, Eastern Province, Batticaloa.

By His Excellency the Governor's command,
E. NOEL WALKER,
Colonial Secretary.

No. 731, E. P.

கொலோனியல் சகலத்தார் ஆபீசில்
கொழும்பில், 1898 ம் வருஷ கார்த்திகைமீ 8 ந் உ.

1898 ம் ஆண்டு மார்ச்சுமீ 20 ந் திகதியாகிய செவ்வாய்க்கிழமையிற் மதனையடுத்த நாட்களிலும் கிழக்கு மாகாணத்த கவர்ணமேந்த வசன்வர்கள் தனது ஆபீசில் இதனடியிற் சொல்லப்படடிருக்கிற மூடிக்குரிய காணித்துண்டுகளை, அரசாட்சியாரால் உத்தரவுபண்ணப்படடிருக்கும் பொருத்தப்பிரகாரம் எலத்திற் கூறி விற்பார்.

படம் 1,252, மண்முனைப்பற்று.

இல.	குறிச்சி.	கேள்விகாரனின் பெயர்.	விலரம்.	தரிப்புவிசை	
				வீசர்லம், அ. து. ப.	அக்கருக்கு. ரூ. ச.
2809	குறிச்சி.	கேள்விகாரனின் பெயர்.	விலரம்.	வீசர்லம், அ. து. ப.	அக்கருக்கு. ரூ. ச.
2811	தெவிலாழுனை	முருகுசினையாப்போடி	பட்டிப்பனைக்காடு	17 1 36	10 0
2812	செடி	செடி	நெடியமடுக்காடு	3 2 16	10 0
2813	செடி	இ. மூத்தாப்போடி	செடி	15 0 15	10 0
2814	செடி	ச. பாலகன்	செடி	84 1 22	10 0
2815	செடி	செடி	நெடியமடுப்புக்கு நா விகாயக்கால காடு	20 0 25	10 0
			செடி	13 0 20	10 0

இல.	குறிச்சி.	கேள்விக்காரனின் பெயர்.	விலரம்.	விசாலம்.		தரிப்புவிலை அக்கருக்கு.	
				அ. நூ. ப.	ரூ. ச.		
2817	தெவிலாமுனை	பொதுவிற்பனவு	காலிபோட்டசேனை	4	3	35	10 0
2818	றை	க. பாலகன்	நெடியமடுக்காடு	5	3	27	10 0
2820	றை	பொதுவிற்பனவு	றை	11	2	35	10 0
2821	றை	க. பாலகன்	காடும் வயலும்	30	2	6	10 0
2822	அம்பிளாந்துறை	க. சின்னத்தம்பி	மிலாத்தச்சேனைக் காடு	8	0	27	10 0
2823	றை	பொதுவிற்பனவு	றை	10	3	27	10 0
2824	றை	ந. செம்பாப்போடி	றை	16	3	4	10 0
2825	றை	பொதுவிற்பனவு	சின்னத்தளவாய் காடு	16	2	8	10 0
2826	றை	றை	றை	9	3	25	10 0
2827	றை	வைகாளி	ஐயாகுளம்	5	2	30	10 0
2829	றை	பொதுவிற்பனவு	காடு	3	0	34	10 0
2830	றை	றை	மனலபுட்டி ஆத்து முன்மாரி	12	3	6	10 0
படம 2,506.							
76756	பட்டிப்பளை அம்பிளாந்துறை	பொ. த. காத்தமுத்து	—	8	2	30	12 50
76757	றை	றை	—	3	1	18	12 50
படம் 499.							
4787	அயிலாந்துறை	மயிலிப்போடி குஞ்சினையாப்போடி	பட்டிப்பளை வெளிப்பூமி	13	3	3	10 0
4788	றை	இ. ஈசுப்புவெல்கை	திக்கிரியன்காடு	1	1	22	10 0
4793	றை	தொ. வேலாப்போடி வாயிதாகட்டாதவன	வேளாண்மைப்பூமி	10	2	25	10 0
4795	றை	இ. கதிர்காமப்போடி	கனாலவழிமடுக்காடு	7	3	4	10 0
4796	றை	ப. கந்தப்போடியு மறுபேரும்	காரைமேட்டு சோதையன்ருளக்காடு	15	3	15	10 0
4800	றை	இ. கதிர்காமப்போடி	வட்டவான்பூமி	7	3	35	10 0
4801	றை	க. மயிலிப்போடி	காலிபோட்டசூடா	10	3	10	10 0
4801½	றை	றை	றை	4	0	9	10 0
4802	றை	வடகுமாணிப்போடியு மறுபேரும்	வேளாண்மைப்பூமி	16	2	16	10 0
4803	றை	றை	றை	6	0	25	10 0
4815	றை	ப. முத்தானு மறுபேரும்	அரசடித்திவுப்பூமி	3	1	11	10 0
4821	றை	மு. பாலகப்போடி	றை	0	2	8	10 0
4829	றை	க. கணபதிமுன்னிலை	பட்டிப்பளை குழியிருப்புப்பூமி	5	0	33	10 0
படம் 2,228, போரதிவுப்பற்று.							
76439	மண்டர்	க. இளையதம்பி	பாலமுனைக்காடு	0	2	2	10 0
76440	றை	க. வைரன்	பாலமுனைவளவு	0	0	23	10 0
76449	மண்டர்	க. கதிர்வேலியு மறுபேரும்	பாலமுனைக்காடு	8	2	31	10 0
76451	றை	வி. வினாசகன்	றை	3	2	36	10 0
76455	றை	க. கந்தப்பன்	வீரையடிவளவு	1	0	7	10 0
76465	றை	வ. வி. வினாசித்தம்பி உடையார்	நாவல்காடு	164	1	0	12 50
76467	றை	றை	வயல்	2	0	12	12 50
76468	றை	றை	பாலமுனைக்காடு	27	1	15	10 0
76473	றை	க. அ. மாரிமுத்து	நாவல்காடு	20	2	0	10 0
படம 406, சம்மாந்துறை.							
3652	மண்டர்	வ. நாகப்பன்	காடு	43	2	0	10 0
3653	றை	சி. வ. வீமாப்போடி	காடு	48	0	0	10 0
3655	றை	வ. நாகப்பன்	வெட்டையும் காடும்	1	3	17	10 0
படம் 1,151, கரைவாகுப்பற்று.							
1840½	மாவடிப்பள்ளி	செ. செய்னமவுலாணை	வேளாண்மைப்பூமி	0	2	4	10 0
படம் 926, நாடுகாடுப்பற்று.							
11475	வரிபத்தன்சேனை	பொ. த. மீராசாய்வு	அக்கரைமடுக்காடு	13	1	8	10 0
11476	றை	றை	றை	14	1	21	10 0
11477	றை	பொதுவிற்பனவு	றை	12	3	17	10 0
11478	றை	றை	றை	10	2	11	10 0
11479	றை	றை	றை	12	0	26	10 0
11480	றை	றை	றை	13	0	36	10 0
படம் 1,008.							
338	மலலிகைத்திவு	அ. உதுமாலெவ்வை	வேளாண்மைசெய்கைக்கேற்றப்பூமி	32	3	32	10 0

இல.	குறிச்சி.	கேள்விக்காரனின் பெயர்.	விவரம்.	விசாலம். அ. ஆ. ப.	தரிப்புவிசை அக்கருக்கு. ரூ. ப. ச.
2594	கருங்கொடடித் திவு	பெர. த மெய்யதின்வாவா	படம் 346, அக்கரைப்பற்று. வேளாண்மைசெய் கைக்கேற்றபூமி	22 0 10	10 0
5233	பணங்காடு	ஆ. உதுமாலெவவை	படம் 1,708. வேளாண்மைசெய் கைக்கேற்றபூமி	14 0 13	10 0
2052	பொத்துவில்	மெஸ்தர் ஜே. இ. கேரித்துரை	படம் 1,169, பாணகைப்பற்று. ஊரணிக்காடு	16 1 0	10 0
76237	வந்தாறுமலை	சி. அகமதுலெவவை	படம் 2,402, ஏறூர்ப்பற்று. தென்னம்பிள்ளைக் கேற்றது	6 0 0	10 0
76238	ஹெ.	ஹெ.	ஹெ.	6 3 18	10 0
76239	கருவன்கேணி	அ. அகமதுலெவவை	ஹெ.	1 3 24	10 0

இக்காணிக்கையற்றிய மேலதிகமான விளம்பரங்களையும் விற்பனவின் கொந்தீசுகளையும்பற்றி மட்டக்களப்பு அரசாட்சி ஏசன்றுத்துரை யவர்களிடம் வினாவி அறிந்துக்கொள்ளலாம்.

தேசாதிபதி மகோத்தமர் அவர்களினது கட்டளையின்படி,

ஈ. நோவெல் உவாக்கர்,

இராசாங்க லிசுர்.

LAND SALES IN THE NORTH-WESTERN PROVINCE.

No. 1,288, N.-W. P.

Colonial Secretary's Office,
Colombo, October 29, 1898.

ON Wednesday, January 18, 1899, at 1 o'clock P.M., the Government Agent for the North Western Province will put up to auction, at his office in Kurunegala, the under-mentioned portions of Crown Land, on the terms authorized by Government.

Twenty-five allotments of land situated in the Katugampola hatpattu division of the Kurunegala District of the North-Western Province.

Lot.	Village.	Name of Applicant.	Name of Claimant.	Description.	Extent.		
					A.	R.	P.
Preliminary plan 1,523.							
7958	Wettewa	Averegodamukalana	Crown	Forest	26	1	24
7959	Do.	do.	do.	do.	43	3	37
K 647	Do.	Paragahamulahena	Mudiyanselage Balahami and Ukku Banda	Low jungle	5	1	22
7930	Kalagedara	Averegodamukalana	Crown	Forest	107	3	19
7961	Udawelawatta	do.	do.	do.	71	1	19
7962	Religala	do.	do.	do.	29	1	34
Upset price,—Rs. 55 per acre.							
Preliminary plan 1,528.							
7982	Meddepola	Taranemukalana	Crown	Forest	19	2	11
7984	Do.	Potgulamukalana	do.	Forest, and contains valuable timber	102	2	20
7985	Palkada	Kiriwanemukalana	do.	Forest	56	0	25
Upset price,—Lots 7,982 and 7,985 Rs. 60 per acre ; lot 7,984 Rs. 70 per acre.							
Preliminary plan 1,535.							
8050	Dombagahagedara	Dummaladeniyamukalana	Crown	Forest	65	3	0
8051	Dombagahagedara and Baddeggedara	Kongahamukalana	do.	do.	88	1	33
8052	Erepola	Paragahamukalana	do.	do.	13	1	2
O 649	Dambagahagedara	Walaketiyahena	H. M. Appuhami and Dingiri Banda	Low jungle	3	2	3
Upset price,—Rs. 40 per acre.							
Preliminary plan 1,364.							
7169	Wellarawa	Wewelagaremukalana	Crown	Forest	9	0	25
7170	Do.	do.	do.	do.	12	0	0
7171	Do.	do.	do.	do.	7	1	29
7172	Do.	do.	do.	do.	10	2	0
Upset price,—Rs. 50 per acre.							
Preliminary plan 1,421.							
7411	Udawela	Galagawakele	Crown	Chena and jungle	33	0	0
7412	Nawasigahawatta and Udawela	Galagawakelemukalana	do.	High jungle	93	2	14
7413	Nabirittankadawala	Nabirittankadawakele	do.	Chena jungle	17	2	35
7414	Do.	Vidanegamamukalana	do.	High jungle	371	3	18
7415	Do.	Vidanegamakele	do.	Chena jungle	62	2	3
Q 638	Do.	Bopitigamawaha-kumbura	L. A. Kalunaide and two others	Field	6	3	28
R 638	Do.	Kalunaidegewatta	L. A. Kalunaide	Cocoanut and tobacco garden	1	3	36
7416	Do.	Batalahenyayamukalana	Crown	High jungle	71	3	24

Upset price,—Lots 7,411, 7,413, and 7,415 Rs. 35 per acre ; lot 7,412, 7,414, and 7,416 Rs. 50 per acre ; lot Q 638 Rs. 10 per acre ; lot R 638 Rs. 25 per acre.

Further information respecting these lands may be obtained from the Surveyor-General, and respecting the conditions of sale from the Government Agent, North-Western Province.

By His Excellency the Governor's command,

E. NOEL WALKER,
Colonial Secretary.

No. 1,288, N.-W. P.

වම 1898 ක්වු මක්කෝඩර් මස 29 වෙනි දින කොළඹ මහසෙනෙවිවරයාගේ නමින් පවත්වාන ලදී.

මෙහි දිසාවේ කුරුමාගල ආණ්ඩුවේ ඒජන්තලායයන්ගේ විසින් මෙහි පහත සඳහන්වන ආණ්ඩුව සත්කම ඉඩම් ආණ්ඩුවේ නියෝගවල ප්‍රකාරයට වම 1899 ක්වු ජනවාරි මස 18 වෙනි දිනවු බදාදා දවල් එකට කුරුමාගල කවිවෙරියේදී වෙන්දේසිකර විකුණනට යෙදෙනවා ඇත.

මෙහි දිසාවේ කුරුමාගල පලාතේ කටුගම්පල ගත්පත්තුවේ පිහිටා තිබෙන බිම්කැබලි 25ක්.

සිතියම 1,523. අයිතිකම කිසිත්තා—රජසත්තක.

නො.	ගම.	ඉඩමේ නම.	අන්දම.	මහත.
			අ. ර. ප.	අ. ර. ප.
7958	වැත්තැව	අවිච්චිගොඩ මුකලාන	මුකලාන	26 1 24
7959	එම	එම	එම	43 3 37
අයිතිකම කිසිත්තා—මුදියන්දේලාගේ බාලගාමි සහ උත්තමගම.				
K 647	එම	පරගමමුලගේන	පාන කැලේ	5 1 22
අයිතිකම කිසිත්තා—රජසත්තක.				
7960	තාලේගෙදර	අවිච්චිගොඩ මුකලාන	මුකලාන	107 3 19
7961	උඩවෙලවත්ත	එම	එම	71 1 19
7962	රැලිගල	එම	එම	29 1 34
නියමකරණලද මුදල අත්කරගත් රුපියල් 55යි.				
සිතියම 1,528.				
7982	මැද්දේපොල	තරවේ මුකලාන	මුකලාන	19 2 11
7984	එම	පොත්ගල මුකලාන	මුකලාන (වවනා ලී තිබේ)	102 2 20
7985	පල්කඩ	තිරිවානේ මුකලාන	මුකලාන	56 0 25
නොමිමර 7982 සහ 7985ගේ ඉඩම් කැබලි දෙකට නියමකරණලද මුදල අත්කරගත් රුපියල් 60යි.				
7984ගේ ඉඩම්කැබලිලට නියමකරණලද මුදල අත්කරගත් රුපියල් 70යි.				
සිතියම 1,535.				
8050	දෙඹගහගෙදර	දුම්මලදෙනි මුකලාන	මුකලාන	65 3 0
8051	එම සහ බැද්දේගෙදර	කෝත්තා මුකලාන	එම	88 1 33
8052	ඇරපොල	පරගම මුකලාන	එම	13 1
අයිතිකම කිසිත්තා—එච්. ඇම්. අප්පුගාමි සහ ඩී.ගීර්ඩන්ඩා.				
O 649	දඹගහගෙදර	වලකැව්තාගේන	ලදුකැලේ	3 2 3
නියමකරණලද මුදල අත්කරගත් රුපියල් 40යි.				
සිතියම 1,364. අයිතිකම කිසිත්තා—රජසත්තක.				
7169	වැල්ලරව	වේවැල්අහාරේ මුකලාන	මුකලාන	9 0 25
7170	එම	එම	එම	12 0 0
7171	එම	එම	එම	7 1 9
7172	එම	එම	එම	10 2 0
නියමකරණලද මුදල අත්කරගත් රුපියල් 50යි.				
සිතියම 1,421.				
741	උඩවෙල	ගල්ගාමාකැලේ	හේන සහ කැලේ	33 0 0
7411	තවසි.තවත්ත සහ උඩවෙල	ගලගාමාකැලේ මුකලාන	උස්කැලේ	93 2 14
7413	තාබිරිත්තත්තවල	තාබිරිත්තත්තවල කැලේ	හේන කැලේ	17 2 35
7414	එම	විදුනගම මුකලාන	උස්කැලේ	371 3 18
7415	එම	විදුනගමකැලේ	හේන කැලේ	62 3
අයිතිකම කිසිත්තා—ඇල්. කච්චිදේ සහ තවත් දෙන්නෙක්.				
Q 638	එම	බෝපිටිගමවහකුඹුර	කුඹුර	6 3 28
අයිතිකම කිසිත්තා—ඇල්. ඒ. කච්චිදේ.				
R 638	එම	කච්චිදේගේ වත්ත	පොල් සහ දුම්කොල වවාපු ඉඩම	1 3 36
අයිතිකම කිසිත්තා—රජසත්තක.				
7416	එම	බතල හේන්ගාම මුකලාන	උස්කැලේ	71 3 24
නොමිමර 7411, 7413 සහ 7415 ඉඩම් කැබලි තුනට නියමකරණලද මුදල අත්කරගත් රුපියල් 35යි.				
එම 7412, 7414 සහ 7416 එම එම 50යි.				
එම Q 638 ඉඩම් කැබලිලට එම එම 10යි.				
එම R 638 එම එම 25යි.				

මෙම ඉඩම් ගැණ වැඩිදුර කාරණ සර්වේශ්වර්ණලායයන්ගෙන්ද, විකිනීමේ කොන්දේසි ගැණ කාරණ වසම් දිසාවේ ආණ්ඩුවේ ඒජන්තලායයන්ගෙන්ද දැනගනට පුළුවන.

ගරුකර ආණ්ඩුකාර උතුමානත්තන්ගේ ආඥාවලය,
ජ. නොඑල් වාකර්,
මහසෙනෙවිවරයාගේ මහලය.

No. 1,289, N.-W. P.

Colonial Secretary's Office,
Colombo, November 3, 1898.

ON Tuesday, December 13, 1898, at 1 o'clock P.M., the Assistant Government Agent for the Puttalam District will put up for sale or settlement, at his office in Puttalam, the under-mentioned portions of Crown Land, on the terms authorized by Government.

Sixteen allotments of land situated in the Kalpitiya and Puttalam divisions of the Puttalam District of the North-Western Province.

Preliminary plan 1,916.

Lot.	Village.	Name of Claimant.	Description	Extent.		Upset Price per Acre.	
				A.	R. P.	Rs.	c.
E 842	Kandakuli	Crown	Cocoanut garden	8	2 30	35	0
Preliminary plan 1,917.							
F 842	Anivasal	Crown	Cocoanut garden	1	2 8	50	0
Preliminary plan 2,110.							
10339	Mundel	Crown	Jungle	5	2 34	12	50
Preliminary plan 1,905							
9776	Sinnaweli	Crown	Low jungle	226	3 20	12	50
9777	Do.	do.	do.	125	3 27	15	0
9778	Do.	do.	Tank	2	2 19	10	0
9779	Do.	do.	Low jungle	7	0 25	15	0
9780	Do.	do.	do.	3	2 8	15	0
9781	Do.	do.	Cocoanut land	4	3 24	12	50
9782	Do.	do.	Cleared jungle	1	1 7	15	0
9783	Do.	do.	Cocoanut garden	1	1 10	30	0
9784	Do.	do.	do.	2	3 16	30	0
9785	Do.	do.	do.	1	0 30	15	0
9786	Do.	do.	do.	0	1 12	15	0
9787	Do.	do.	do.	0	3 4	60	0
Preliminary plan 1,703.							
8616	Uhanpitiya	Crown	Jungle	43	1 19	30	0

Further information respecting these lands may be obtained from the Surveyor-General, and respecting the conditions of sale from the Assistant Government Agent, Puttalam.

By His Excellency the Governor's command,

E. NOEL WALKER,
Colonial Secretary.

No. 1,289, N.-W. P.

වම් 1898 ක්වු නොවැම්බර් මස 3 වෙනි දින කොළඹ මහසෙනෙවුකාරිස් උත්තාන්සේනේ කන්තෝරුවේදීය.

මෙම දිනවේ පුත්තලම් දිස්ත්‍රෙක්කේ උපරිච්ඡන්දනාන්සේ විසින් මෙහි සහන සඳහන්වෙන ආණ්ඩුව සන්තක ඉඩම් ආණ්ඩුවේ නියෝගවල ප්‍රකාරව වම් 1898 ක්වු දෙසැම්බර් මස 13 වෙනි දිනවු අහඹු වාදු දවල් එකට පුත්තලම් කවිවේරියේදී වෙත්දේසියර විකුණනට හෝ අයිතිවාසිකම නිවැරදිවට සෙදෙ නවා ඇත.

වැඩි දිනවේ පුත්තලම් දිස්ත්‍රෙක්කේ කල්පිටිය සහ කොට්ඨාසයේ පිහිටා තිබෙන බිම්කැබෙලි 16ක්.

සිතියම 1,916.

කො.	ගම.	අයිතිකම කියන්නා.	අන්දම.	මහත.		අඩුකොවන විවිකාකම.	
				අ. රු. ප.	රු. ශ.		
E 842	කන්ඩකුලි	රජසන්තක	පොල්වත්ත	8	2 30	35	0
				සිතියම 1,917.			
F 842	අනිව.සල්	රජසන්තක	එම	1	2 8	50	0
				සිතියම 2,110.			
10339	මුන්දල්	රජසන්තක	කැලේ	5	2 34	12	50
				සිතියම 1,905.			
9776	සිමාවලි	රජසන්තක	ලඳුකැලේ	226	3 20	12	50
9777	එම	එම	එම	125	3 27	15	0
9778	එම	එම	වැව	2	2 19	10	0
9779	එම	එම	ලඳුකැලේ	7	0 25	15	0
9780	එම	එම	එම	3	2 8	15	0
9781	එම	එම	පොල්වත්ත	4	3 24	12	50
9782	එම	එම	එලිකරපු කැලේ	1	1 7	15	0
9783	එම	එම	පොල්වත්ත	1	1 10	30	0
9584	එම	එම	එම	2	3 16	30	0
9785	එම	එම	එම	1	0 30	15	0
9786	එම	එම	එම	0	1 12	15	0
9787	එම	එම	එම	0	3 4	60	0
සිතියම 1,703.							
8616	උගම්පිටිය	රජසන්තක	කැලේ	43	1 19	30	0

මෙම ඉඩම් ගැන වැඩිදුර කාරණ සර්වේසර්ජන් උත්තාන්සේනේද, විකිනීමේ කොන්දේසි ගැන කාරණ පුත්තලම් දිස්ත්‍රෙක්කේ උපරිච්ඡන්දනාන්සේනේද දැනගන්නට පුළුවන.

ගරුඥර ආණ්ඩුකාර උතුමානවතන්සේනේ ආඥව ලෙස,
ඒ. නොඑල් වාකර්,
මහසෙනෙවුකාරිස් වම්ස.

No. 1,289 N.-W. P.

கொலோனியல் சர்க்கிளித்தாரா ஆபீசில்,
கொழும்பில் 1898 ம் ஆண்டு கார்த்திகைமீ 3 ந் வ.

1898 ம் ஆண்டு மாகாணபிரதம 13 ந் திகதி செவ்வாய்க்கிழமை பகல 1 மணிகளுக்கு புத்தளம் தன ஆபீசில் வடமேன் மாகாணத்து உதவி கவர்ணமேந்த ஏசனறவாகளால் இதனடியிற் சொல்லப்பட்டிருக்கிற முடிக்கூரிய காணித்துணடுகளை, அசாட்சியாரால் உத்தரவுபண்ணப்பட்டிருக்கும் பொருத்தப் பிரகாரம் ஏலத்திற்கு விற்கப்படும் அல்லது முடித்துக்கொள்ளப்படும்.

16 காணித்துணடுகள், வடமேன்மாகாணத்து புத்தளம் டிஸ்திரிக்கின கற்பிட்டி பகுதியிலிருக்கின்றன.

பிரான இலக்கம் 1,916.

இல.	சூழ்ச்சி	உரிதாளியின் பெயர்.	விவரம்.	நிதானித்த விலை விசாலம். ஏக்கருக்கு. அ. மூ. ப. ரூ. ச.
E 842	கண்டகுகுளி	முடிக்கூரியது	தென்னந்தோட்டம்	8 2 30 35 0
F 842	ஆணைவாசல	முடிக்கூரியது	தென்னந்தோட்டம்	1 2 8 50 0
10339	முந்தல	முடிக்கூரியது	காடு	5 2 34 12 50
9776	சிடாவெளி	முடிக்கூரியது	சிறுகாடு	226 3 20 12 50
9777	செடி	செடி	செடி	125 3 27 15 0
9778	செடி	செடி	குளம்	2 2 19 10 0
9779	செடி	செடி	சிறுகாடு	7 0 25 15 0
9780	செடி	செடி	செடி	3 2 8 15 0
9781	செடி	செடி	தென்னம்பினை	
9782	செடி	செடி	தரை	4 3 24 12 50
9783	செடி	செடி	வெளிசாக்கின்காடு	1 1 7 15 0
9784	செடி	செடி	தென்னந்தோட்டம்	1 1 10 30 0
9785	செடி	செடி	செடி	2 3 16 30 0
9786	செடி	செடி	செடி	1 0 30 15 0
9787	செடி	செடி	செடி	0 1 12 15 0
8616	உவான்பிட்டிய	முடிக்கூரியது	காடு	0 3 4 60 0

பிரான இலக்கம் 1703.

இக்காணிகளைப்பற்றிய மேலதனமான விளம்பரங்களை எர்வேயர் ஜெனறலதுரை யவர்களிடத்திலும் விற்பனைவின் கொந்திசுகளைப்பற்றி வடமேன்மாகாணத்து உதவி அசாட்சி ஏசனறரிடத்திலும் மறிந்துகொள்ளலாம்.

தேசாஜிபதி டீகோத்தமர் அவர்களினது கட்டலையின்படி,
ஈ. நோவெல் உவாககர்.
இராசாங்க விதிதர்.

No. 1,290, N.-W. P. Colonial Secretary's Office,
Colombo, November 3, 1898.

ON Thursday, December 15, 1898, at 1 o'clock P.M., the Assistant Government Agent for the Puttalam District will put up for sale or settlement, at his office in Puttalam, the under-mentioned portions of Crown Land, on the terms authorized by Government.

Ninety-two allotments of land situated in the Puttalam pattu of the Puttalam District of the North-Western Province.

Preliminary plan 1,891,
Village—Tetapola or Chettichena.
Claimant—Crown.

Lot.	Description.	Extent. A. R. P.	Upset Price per Acre. Rs. c.
Q 837	Jungle	9 3 22	20 0
9700	Jungle and open	3 2 17	15 0
9701	Do.	11 2 0	15 0
9702	Do.	11 1 0	15 0
9703	Do.	10 3 9	15 0
9704	Do.	10 3 34	15 0
9705	Do.	9 1 11	15 0
9706	Do.	10 0 0	15 0
9707	Do.	8 3 19	15 0
R 837	Do.	9 0 16	15 0
S 837	Do.	8 2 2	15 0
T 837	Do.	8 1 10	15 0

Lot.	Description.	Extent. A. R. P.	Upset Price per Acre. Rs. c.
U 837	Jungle and open	7 3 11	15 0
V 837	Do.	7 1 2	15 0
W 837	Do.	6 2 31	15 0
X 837	Do.	6 0 36	15 0
Y 837	Do.	5 3 13	15 0
Z 837	Do.	5 3 36	15 0
A 838	Do.	6 0 9	15 0
B 838	Do.	5 3 19	15 0
C 838	Do.	5 3 23	15 0
D 838	Do.	5 1 30	15 0
E 838	Do.	4 1 15	15 0

Village—Tetapola or Chettichena.
Claimant—Late Proctor Muttukumaru and others.

9708	Open land and jungle	21 1 20	15 0
F 838	Cocconut garden	1 1 16	20 0
G 838	Jungle	18 2 38	17 50
9709	Do.	2 0 5	15 0

Village—Puludiwasal.
Claimant—Crown.

9709	Jungle	5 2 12	20 0
9710	Do.	5 2 0	20 0
9711	Do.	5 1 2	20 0
9712	Do.	6 1 0	20 0
9713	Do.	5 2 31	20 0
9714	Do.	6 2 38	20 0
9715	Do.	6 3 26	20 0
9716	Do.	7 1 10	20 0

Lot.	Description.	Extent.		Upset price per Acre.		Lot.	Description.	Extent.		Upset Price per Acre.			
		A.	R.	P.	Rs.			c.	A.	R.	P.	Rs.	c.
H 838	Jungle	8	1	3	20	0	C 839	Jungle	4	2	15	20	0
I 838	Do.	2	0	16	25	0	D 839	Do.	1	3	14	20	0
J 838	Do.	2	1	30	25	0	E 839	Do.	10	3	37	20	0
K 838	Do.	3	1	21	25	0	F 839	Do.	11	2	20	20	0
L 838	Do.	4	0	13	25	0	G 839	Do.	10	2	3	20	0
M 838	Do.	4	2	30	25	0	H 839	Do.	10	1	18	20	0
N 838	Do.	4	3	28	25	0	I 839	Do.	9	2	13	20	0
O 838	Do.	5	1	19	25	0	J 839	Do.	9	1	32	20	0
P 838	Do.	0	2	38	25	0	K 839	Do.	9	2	11	20	0
Q 838	Do.	3	3	14	25	0	L 839	Do.	9	2	18	15	0
R 838	Do.	1	0	39	25	0							
S 838	Do.	3	3	9	25	0							
T 838	Do.	0	3	31	25	0							
U 838	Do.	4	1	22	25	0							
V 838	Do.	1	0	34	25	0							
W 838	Do.	4	3	15	25	0							
X 838	Do.	1	1	35	25	0							
Y 838	Do.	4	2	20	25	0							
Z 838	Do.	2	3	10	25	0							
A 839	Do.	4	3	35	25	0							
B 839	Do.	3	2	15	25	0							

Village—Puludiwasal.
Claimant—A. de Rosairo and others.

M 839	Tank	0	2	17	10	0
-------	------	---	---	----	----	---

Claimant—Crown.

9717	Jungle	12	0	23	15	0
9718	Do.	10	2	4	15	0
9719	Do.	10	0	0	15	0

Village.	Name of Claimant.	Description.	Extent.		Upset Price per Acre.		
			A.	R.	P.	Rs.	c.
9720	Puludiwasal	Crown	12	0	36	15	0
N 839	Do.	do.	3	1	9	15	0
O 839	Do.	do.	71	0	0	12	50
P 839	Do.	M. K. Peer Mohamado and others	6	3	19	15	0
9721	Do.	T. N. P. M. Meedin Marikkar	60	3	0	20	0
9722	Do.	do.	0	3	1	20	0
9723	Do.	do.	4	2	6	60	0
Q 839	Do.	M. K. Peer Mohamado and others	2	0	16	15	0
R 839	Do.	do.	12	1	12	15	0
S 839	Do.	do.	51	0	0	12	50
T 839	Do.	A. de Rosairo and others	6	0	32	10	0
U 839	Do.	do.	9	1	5	15	0
V 839	Do.	do.	24	1	22	12	50
W 839	Do.	M. P. Mohamado and others	10	2	21	15	0
X 839	Do.	do.	1	0	34	10	0
Y 839	Do.	do.	19	3	0	15	0
A 840	Do.	W. M. M. Kandu Marikar	10	2	21	12	50
B 840	Do.	do.	15	3	14	15	0
C 840	Do.	W. M. M. Kandu Marikar	44	0	17	15	0
D 840	Do.	do.	1	3	9	12	50
E 840	Do.	do.	0	0	31	12	50
Z 839	Do.	M. P. Mohamado and others	8	1	14	12	50

Further information respecting these lands may be obtained from the Surveyor-General, and respecting the conditions of sale from the Assistant Government Agent, Puttalam.

By His Excellency the Governor's command,

E. NOEL WALKER,
Colonial Secretary.

වම් 1898 ක්වු තොවුම්බර් මස 3 වෙනි
No. 1,290, N.-W.P. දින කොළඹ මහසෙනෙවුනාරිජලන්
තාන්සේගේ කන්තෝරුවේදිස.

වම් දිසාවේ පුත්තලම් දිස්ත්‍රික්කවේ උපළිස්සනලන්
තාන්සේ විසින් මෙහි පහත සඳහන්වෙහ ආණ්
ඩුව සන්තක ඉඩම් ආණ්ඩුවේ නියෝගවල ප්‍රකාරයට
වම් 1898 ක්වු දෙසැම්බර් මස 15 වෙනි දිනවු බ්‍රිතන්
පකින්ද එකට පුත්තලම් කම්බේරිසේදි වෙන්දේසිකර
විකුණන්ට හෝ අයිතිවාසිකම් බේරන්ට යෙදෙනවා
ඇත.

වම් දිසාවේ පුත්තලම් පලාතේ පුත්තලම් පන්කුවේ
පිහිටා තිබෙන බිම්කැබෙලි 92ක්.

සිතියම 1,891. අයිතිකම් කියත්තා—ආණ්ඩුව.

තො.	භම.	අන්දම.	මහත.	අක්කර
			අ. රු. ප.	සකම්ල.
Q 837	තේනාපල			
	තොණගන්			
	සෙව්විසේ			
	ක	කැලේ සක		
		එලිබිම	9 3 22	20 0

තො.	භම.	අන්දම.	මහත.	අක්කර
			අ. රු. ප.	සකම්ල.
9700	පුළුදවාසල			
	තොණගන්			
	සෙව්විසේ			
	ක	එම	3 2 17	15 0
9701	එම	එම	11 2 0	15 0
9702	එම	එම	11 1 0	15 0
9703	එම	එම	10 3 9	15 0
9704	එම	එම	10 3 34	15 0
9705	එම	එම	9 1 11	15 0
9706	එම	එම	10 0 0	15 0
9707	එම	එම	8 3 19	15 0
R 837	එම	එම	9 0 16	15 0
S 837	එම	එම	8 2 2	15 0
T 837	එම	එම	8 1 10	15 0
U 837	එම	එම	7 3 11	15 0
V 837	එම	එම	7 1 2	15 0
W 837	එම	එම	6 2 31	15 0
X 837	එම	එම	6 0 36	15 0
Y 837	එම	එම	5 3 13	15 0
Z 837	එම	එම	5 3 36	15 0

නො.	ගම.	අන්දම.	මහත. අ. රු. ප.	අක්කර ගකමිල. රු. ය.
A 838	පුඵද්වාසල	නොහොත් සෙවිසියේ කැලේ සහ හ	6 0 9	15 0
B 838	එම	එම	5 3 19	15 0
C 838	එම	එම	5 3 23	15 0
D 838	එම	එම	5 1 30	15 0
E 838	එම	එම	4 1 15	15 0
අයිතිකම් කියත්තා—පැයියිය පෙරකඳුරු මුත්තු කුමාර සහ තවත් අසවමත්.				
9708	කේසල නොහොත් වෙවිසියේ හ	කැලේ සහ එලිබිම	21 1 20	15 0
F 838	එම	පොල්වත්ත	1 1 16	20 0
G 838	එම	කැලේ	18 2 38	17 50
9709½	එම	එම	2 0 5	15 0
අයිතිකම් කියත්තා—ආණ්ඩුව.				
9709	පුඵද්වාසල	කැලේ	5 2 12	20 0
9710	එම	එම	5 2 0	20 0
9711	එම	එම	5 1 2	20 0
9712	එම	එම	6 1 0	20 0
9713	එම	එම	5 2 31	20 0
9714	එම	එම	6 2 38	20 0
9715	එම	එම	6 3 26	20 0
9716	එම	එම	7 1 10	20 0
H 838	එම	එම	8 1 3	20 0
I 838	එම	එම	2 0 16	25 0
J 838	එම	එම	2 1 30	25 0
K 838	එම	එම	3 1 21	25 0
L 838	එම	එම	4 0 13	25 0
M 838	එම	එම	4 2 30	25 0

නො.	ගම.	අන්දම	මහත. අ. රු. ප.	අක්කර ගකමිල. රු. ය.
N 838	පුඵද්වාසල	කැලේ	4 3 28	25 0
O 838	එම	එම	5 1 19	25 0
P 838	එම	එම	0 2 38	25 0
Q 838	එම	එම	3 3 14	25 0
R 838	එම	එම	1 0 39	25 0
S 838	එම	එම	3 3 9	25 0
T 838	එම	එම	0 3 31	25 0
U 838	එම	එම	4 1 22	25 0
V 838	එම	එම	1 0 34	25 0
W 838	එම	එම	4 3 15	25 0
X 838	එම	එම	1 1 35	25 0
Y 838	එම	එම	4 2 20	25 0
Z 838	එම	එම	2 3 10	25 0
A 839	එම	එම	4 3 35	25 0
B 839	එම	එම	3 2 15	25 0
C 839	එම	එම	4 2 15	20 0
D 839	එම	එම	1 3 14	20 0
E 839	එම	එම	10 3 37	20 0
F 839	එම	එම	11 2 20	20 0
G 839	එම	එම	10 2 3	20 0
H 839	එම	එම	10 1 18	20 0
I 839	එම	එම	9 2 13	20 0
J 839	එම	එම	9 1 32	20 0
K 839	එම	එම	9 2 11	20 0
L 839	එම	එම	9 2 18	15 0
අයිතිකම් කියත්තා—ඒ. ඩී. රෙකාරු සහ තවත් අය.				
M 839	පුඵද්වාසල	වැව	0 2 17	10 0
අයිතිකම් කියත්තා—ආණ්ඩුව සත්තක.				
9717	පුඵද්වාසල	කැලේ	12 0 23	15 0
9718	එම	එම	10 2 4	15 0
9719	එම	එම	10 0 0	15 0
9720	එම	එම	12 0 36	15 0
N 839	එම	වත්ත	3 1 9	15 0

නො.	ගම.	අයිතිකම් කියත්තා.	අන්දම.	මහත. අ. රු. ප.	අක්කර ගකමිල. රු. ය.
O 839	පුඵද්වාසල	ආණ්ඩුව	කැලේ	71 0 0	12 50
P 839	එම	ඇම්. ජේ. පී. මහමමදු සහ තවත් අය	එම	6 3 19	15 0
9721	එම	පී. ඇන්. පී. ඇම්. මිසදීන් මරිකාලේ	එම	60 3 0	20 0
9722	එම	එම	වත්ත	0 3 1	20 0
9723	එම	එම	එම	4 2 6	60 0
Q 839	එම	ඇම්. ජේ. පී. මහමමදු සහ තවත් අය	වෙල	2 0 16	15 0
R 839	එම	එම	වැව	12 1 12	15 0
S 839	එම	එම	කැලේ	51 0 0	12 50
T 839	එම	ඒ. ඩී. රෙකාරු සහ තවත් අය	වැව	6 0 32	10 0
U 839	එම	එම	කැලේ	9 1 5	15 0
V 839	එම	එම	එම	24 1 22	12 50
W 839	එම	ඇම්. පී. මොහමමදු සහ තවත් අය	වැව	10 2 21	15 0
X 839	එම	එම	කැලේ	1 0 34	10 0
Y 839	එම	එම	වෙල	19 3 0	15 0
A 840	එම	ඩබ්ලිව්. ඇම්. ඇම්. කන්ඩුමරික්කාලේ	කැලේ	10 2 21	12 50
B 840	එම	එම	වෙල	15 3 14	15 0
C 840	එම	එම	කැලේ	44 0 17	15 0
D 840	එම	එම	එම	1 3 9	12 50
E 840	එම	එම	එම	0 0 31	12 50
Z 839	එම	ඇම්. පී. මහමමදු සහ තවත් අය	එම	8 1 14	12 50

මෙම ඉඩම් ගැණ වැඩිදුර කාරණා සර්වේඤ්චන්ද්‍රත්නාත්සේනෙත්තු, විකිනිමේ කොන්දේසි ගැණ කාරණ පුත්තලමිදිප්පික්කේ උපඵජන්තලත්නාත්සේනෙත්තු දුකගන්ට පුඵවත.

ගරුභර ආණ්ඩුකාර උතුරුතන්වත්සේනෙත්තු ආදා වලස,
 ඊ. තොළුල් වාකර්,
 මහසෙනෙකාරිස් වමිත.

1,290 N.-W. P. கொ. சக்கித்தார் ஆபிசில்,
கொழும்பு, 1898 ம் வரு கார்த்திகைமீ 3 ன் உ.

1898 ம் வரு மார்கனிமீ 15 ன் திகதி, விபரம் கீழ்க் குறிப்பிட்டுள்ள பின்னரம் 1 மணிக்கு புத்தளம் தன் ஆபிசில் வட மேன்மாகாணத்து உதவி சுவர்ணமேந்த ஏசன்மவர்க ளால் இதனடியிற் சொல்லப்பட்டிருக்கிற முடிக்குரிய காணித்துண்டுகளை, அரசாட்சியாரால் உத்தரவுபண்ண ப்பட்டிருக்கும் பொருத்தப் பிரகாரம் ஏலத்திற்குறி வி ற்கப்படும் அல்லது தீர்த்துக்கொள்ளப்படும்.

92 காணித்துண்டுகள், வடமேன் மாகாணத்து புத்த ளம் டி.ஸ்திரிக்கின் புத்தளம்பற்று பகுதியிலிருக்கின் றது.

பிளான் இலக்கம் 1891.

குறிச்சி—தேத்தாபொல அல்லது செட்டிச்சேனை.
உரித்தாளி—முடிக்குரியது.

இல.	விபரம்.	அ. று. ப.	ரு. ச.
Q 837	காடு	9 3 22	20 0
குறிச்சி—புளுதிவாசல அல்லது செட்டிச்சேனை.			
9700	காடும் வெளியும்	3 2 17	15 0
9701	ஹே	11 2 0	15 0
9702	ஹே	11 1 0	15 0
9703	ஹே	10 3 9	15 0
9704	ஹே	10 3 34	15 0
9705	ஹே	9 1 11	15 0
9706	ஹே	10 0 0	15 0
9707	ஹே	8 3 19	15 0
R 837	ஹே	9 0 16	15 0
S 837	ஹே	8 2 2	15 0
T 837	ஹே	8 1 10	15 0
U 837	ஹே	7 3 11	15 0
V 837	ஹே	7 1 2	15 0
W 837	ஹே	6 2 31	15 0
X 837	ஹே	6 0 36	15 0
Y 837	ஹே	5 3 13	15 0
Z 837	ஹே	5 3 36	15 0
A 838	ஹே	6 0 9	15 0
B 838	ஹே	5 3 19	15 0
C 838	ஹே	5 3 23	15 0
D 838	ஹே	5 1 30	15 0
E 838	ஹே	4 1 15	15 0

குறிச்சி—தேத்தாபொல அல்லது செட்டிச்சேனை.
உரித்தாளி—காலஞ்சென்றுபோன முத்துகுமாருபெரு க்கோரும் மற்றவர்களும்.

9708	வெளிநிலமும் காடும்	21 1 20	15 0
F 838	தென்னந்தோட் டம்	1 1 16	20 0
G 838	காடு	18 2 38	17 50
9709½	ஹே	2 0 5	15 0

குறிச்சி—புளுதிவாசல.
உரித்தாளி—முடிக்குரியது.

இல.	விபரம்.	அ. று. ப.	ரு. ச.
9709	காடு	5 2 12	20 0
9710	ஹே	5 2 0	20 0
9711	ஹே	5 1 2	20 0
9712	ஹே	6 1 0	20 0
9713	ஹே	5 2 31	20 0
9714	ஹே	6 2 38	20 0
9715	ஹே	6 3 26	20 0
9716	ஹே	7 1 10	20 0
H 838	ஹே	8 1 3	20 0
I 838	ஹே	2 0 16	25 0
J 838	ஹே	2 1 30	25 0
K 838	ஹே	3 1 21	25 0
L 838	ஹே	4 0 13	25 0
M 838	ஹே	4 2 30	25 0
N 838	ஹே	4 3 28	25 0
O 838	ஹே	5 1 19	25 0
P 838	ஹே	0 2 38	25 0
Q 838	ஹே	3 3 14	25 0
R 838	ஹே	1 0 39	25 0
S 838	ஹே	3 3 9	25 0
T 838	ஹே	0 3 31	25 0
U 838	ஹே	4 1 22	25 0
V 838	ஹே	1 0 34	25 0
W 838	ஹே	4 3 15	25 0
X 838	ஹே	1 1 35	25 0
Y 838	ஹே	4 2 20	25 0
Z 838	ஹே	2 3 10	25 0
A 839	ஹே	4 3 35	25 0
B 839	ஹே	3 2 15	25 0
C 839	ஹே	4 2 15	20 0
D 839	ஹே	1 3 14	20 0
E 839	ஹே	10 3 37	20 0
F 839	ஹே	11 2 20	20 0
G 839	ஹே	10 2 3	20 0
H 839	ஹே	10 1 18	20 0
I 839	ஹே	9 2 13	20 0
J 839	ஹே	9 1 32	20 0
K 839	ஹே	9 2 11	20 0
L 839	ஹே	9 2 18	15 0

உரித்தாளி— . த. ரொசாயரும் மற்றவரும்.
குளம் 0 2 17 10 0

9717	காடு	12 0 23	15 0
9718	ஹே	10 2 4	15 0
9719	ஹே	10 0 0	15 0
பிளான் இலக்கம் 1,891.			
9720	காடு	12 0 36	15 0
N 839	தோட்டம்	3 1 9	15 0

இல.	குறிச்சி.	உரித்தாளியின் பெயர்.	விவரம்.	விசாலம்.	ஏக்கருக்கு
O 839	புளுதிவாசல	முடிக்குரியது	காடு	71 0 0	12 50
P 839	ஹே	அம். கெ. பிரமுகமதம் மற்ற வரும்	காடு	6 3 19	15 0
9721	ஹே	தி. அன். பி. அம். மீதின் மரைக்கார	காடு	60 3 0	20 0
9722	ஹே	ஹே	தோட்டம்	0 3 1	20 0
9723	ஹே	ஹே	ஹே	4 2 6	60 0
Q 839	ஹே	அம். கெ. பி. முகமதம் மற்ற வரும்	வயல	2 0 16	15 0
R 839	ஹே	ஹே	குளம்	12 1 12	15 0
S 839	ஹே	ஹே	காடு	51 0 0	12 50

இல.	குறிச்சி.	உரித்தாளியின் பெயர்.	விவரம்.	நிதானித்த விசை	
				விசாலம்.	ஏக்கருக்கு.
T 839	புளுதிவாசல்	எ. த. ரொசாயரும் மற்ற வரும்	குளம்	அ. தூ. ப.	ரூ. ச.
U 839	செடி	செடி	காடு	6 0 32	10 0
V 839	செடி	செடி	காடு	9 1 5	15 0
W 839	செடி	அம். பீ. முகமதும் மற்றவரும்	குளம்	24 1 22	12 50
X 839	செடி	செடி	காடு	10 2 21	15 0
Y 839	செடி	செடி	காடு	1 0 34	10 0
A 840	செடி	டபினியு. அம். அம். கண்டு மரைக்கார்	வயல	19 3 0	15 0
B 840	செடி	செடி	காடு	10 2 21	12 50
C 840	செடி	செடி	வயல	15 3 14	15 0
D 840	செடி	செடி	காடு	44 0 17	15 0
E 840	செடி	செடி	காடு	1 3 9	12 50
Z 839	செடி	அம். பீ. முகமதும் மற்றவரும்	காடு	0 0 31	12 50
				8 1 14	12 50

இக்காணிகளைப்பற்றிய மேலதனமான விளம்பரங்களை செர்வேயர் ஜெனறல்துறை அவர்களிடத்திலும் விற்பனாவின் கொந்திசுகளைக் குறித்து வடமேன்மாகாணத்து உதவி அரசாட்சி ஏசன்றரிடத்திலும் மறிந்துகொள்ளலாம்.

தேசாதிபதி மகோத்தமர் அவர்களினது கட்டளையின்படி,
ஈ. நோவல் உவாக்கர்,
இராசாங்கலித்தர்.

LAND SALES IN THE PROVINCE OF UVA.

No. 326, P. OF U.

Colonial Secretary's Office,
Colombo, November 4, 1898.

ON Tuesday, December 13, 1898, at 1 P.M., the Government Agent for the Province of Uva will put up to auction, at his office in the Kachcheri, the under-mentioned portions of Crown Land, on the terms authorized by Government.

Two allotments of land situated in the Wiyalua division of the Badulla District of the Province of Uva.

Preliminary plan 812. Claimant—Crown.

Lot.	Village.	Name of Applicant.	Description.	Extent. A. R. P.	Upset Price per Acre. Rs.
2847	Komarike in Oyapalata	For general sale	Garden and jungle, contains tamarind, arecanut, jak, and cocoanut	9 3 20	10
9123	Godunna in Wiyalupalata	Preliminary plan 3,235. For general sale	Old field, now chena	5 1 13	10

Seven allotments of land situated in the Udukinda division of the Badulla District of the Province of Uva.

Preliminary plan 127. Claimant—Crown.

355	Galahitiya in Gampaha korale	Wetakada Siyatu of Gampaha korale	Garden	0 1 37	10
356	Do.	do.	do.	0 3 25	10
357	Do.	do.	do.	0 2 17	10
V 578	Moretota in Dehiwinipalata	Preliminary plan 3,515. Claimant—Kinagahagedara Punchirala, now claimed by Crown. Ambawela Hin Banda	Paddy field	0 1 34	10
9746	Mahawela in Dehiwinipalata	Claimant—Crown. Ambawela Hin Banda	Paddy field	2 2 10	10
9747	Do.	do.	do.	1 1 37	10
9748	Do.	do.	do.	0 2 38	10

Two allotments of land situated in the Yatikinda division of the Badulla District of the Province of Uva.

Preliminary plan 595. Claimant—Kira.

G 65	Udakiruwa in Pattipola korale of Yatikinda	Mr. D. C. Kotalawala	Light jungle and scrub	17 2 6	20
------	--	----------------------	------------------------	--------	----

The land is said to contain plumbago.

C 5

Lot.	Village.	Name of Applicant.	Description.	Extent. A. R. P.	Upset Price per acre. Rs.
Preliminary plan 813. Claimant—Crown.					
2850	Wattepanguwa in Bogoda korale of Yatikiinda	Messrs. A. T. Retie, R. H. Eliot, and two others	Patana and jungle	52 2 30	10
Four allotments of land situated in the Buttala division of the Badulle District of the Province of Uva.					
Preliminary plan 3,059. Claimant—Crown.					
8889	Udagangoda in Kandukara korale	For general sale	Paddy field	0 2 11	10
8890	Do.	do.	do.	0 2 9	10
Preliminary plan 2,937. Claimant—Wijeyaratna Mudiyansele Punchirala and Kalu Banda.					
U 373	Gamawela in Kandukara korale of Buttala	For sale or settlement	Chena	3 0 27	10
V 373	Do.	do.	do.	0 0 20	10
This land lies near Maryland estate.					
An allotment of land situated in the Wellawaya division of the Badulla District of the Province of Uva.					
Preliminary plan 752. Claimant—Crown.					
2634	Nikapota in Kandapalle korale	C. C. Sadayan Kangani	Patana and scrub	7 2 36	10
Further information regarding these lands may be obtained from the Surveyor-General, and regarding conditions of sale from the Government Agent, Province of Uva.					

By His Excellency the Governor's command,
E. NOEL WALKER,
Colonial Secretary.

No. 326, P. OF U.

වම් 1898 ක්වු කොවුම්බර් මස 4 වෙනි දින කොළඹ මහසෙනෙවුන්ගේ උන්කාන්සේනේ කන්කෝරුවේදීය.

උඩ දිසාවේ ආණ්ඩුවේ ඒජන්ත උන්කාන්සේ විසින් මෙහි පහත සඳහන් වෛත ආණ්ඩුව සන්තක ඉඩම් ආණ්ඩුවේ නියෝගවල ප්‍රකාරයට වම් 1898 ක්වු දෙසැම්බර් මස 13 වෙනි දිනවු අභ්‍යරුවාද පස්වරු එකේ කනිසමට බදු පවතිනුයේදී වෙන්දේසිකර විකුණනුට යෙදෙනවාය.

උඩ දිසාවේ බදු පලාතේ විසඳව කොට්ඨාසයේ පිහිටා තිබෙන බිම්කැබලි 2ක්.
සිතියම 812. අයිතිකම කියන්නා—රජසන්තක.

කො.	ගම.	ඉල්ලුම්කාරයා.	අන්දම.	මහත. අ. රු. ප.
2847	බිසපලාත කෝමාරිකේ	විකිනිමට	පොල්, පුවක්, කොස් ඇති වත්ත	9 3 20
සිතියම 3,235.				
9123	විසඳව පලාත ගෝඩුන්සේ	විකිනිමට	පරත කුඹුරක්වු දූනට හේන	5 1 13
උඩ දිසාවේ බදු පලාතේ උඩුකිඳ කොට්ඨාසයේ පිහිටා තිබෙන බිම්කැබලි 7ක්. සිතියම 127.				
355	ගම්පහකෝරලේ ගලකිටියාවේ ගම්පහකෝරලේ වැටකඩ සියාතු	වත්ත		0 1 37
356	එම	එම	එම	0 3 25
357	එම	එම	එම	0 2 17
සිතියම 3,515. අයිතිකම කියන්නා—කිනගහගෙදර පුත්චිරල, දුන් රජසන්තකයි.				
V 578	දෙහිවිනිපලාත මොරතොට	අඹේවල හිත්බන්ඩා	කුඹුර	0 1 34
අයිතිකම කියන්නා—රජසන්තක.				
9746	දෙහිවිනිපලාත මහවෙල	අඹේවල හිත්බන්ඩා	එම	2 2 10
9747	එම	එම	එම	1 1 37
9748	එම	එම	එම	0 2 38

අක්කරයක් රුපියල් 10යේ සිට පටන්ගනු ලැබේ.
උඩ දිසාවේ බදු පලාතේ පරිකිඳකොට්ඨාසයේ පිහිටා තිබෙන බිම්කැබලි 2ක්.
සිතියම 595. අයිතිකම කියන්නා—කිර.

G 65	පරිකිඳ පරිපලකෝරලේ උඩ කිරුව	ඩී. සී. කොහලාචල උන්කාන්සේ	ලපරි කැලේ	17 2 6
අක්කරයක් රුපියල් 20 සිට විකුණනු ලැබේ. මේ ඉඩමේ මිනිරන් තිබෙන බව කියයි. සිතියම 813. අයිතිකම කියන්නා—රජසන්තක.				
2850	පරිකිඳ පලාත බෝගොඩකෝරලේ වත්තේපත්ඉව	ඒ. ජේ. රැවි, ආර්. එම්. එලියව් මහත් වරු සහ තවත් දෙදෙනෙක්	පහත සහ කැලෑව	52 2 30
උඩ දිසාවේ බදු පලාතේ වුත්තල කොට්ඨාසයේ පිහිටා තිබෙන බිම්කැබලි 4ක්. සිතියම 3,059.				
8889	කුඳකරකෝරලේ උඩගත් ගොඩ	විකිනිමට	කුඹුර	0 2 11
8890	එම	එම	එම	0 2 9

නො.	ගම.	ඉල්ලුම්කාරයා.	අත්දම.	මහත. අ. රු. ප.
U 373	සිහියම 2,937.	අසිතිකම කියන්නා—විජයරත්නමුදියන්සේලාගේ පුංචි රු සහ කළුබන්ඩා.	සේන	3 0 27
V 373	—	බේරිමට නොහොත් විකිනීමට එම	එම	0 0 20

මේ ඉඩම මේරිලාන්ඩ් වත්ත ලග පිහිටා තිබේ.
 ලාච්ඡිකාවේ බදු පලාතේ වැල්ලවා කොට්ඨාසයේ පිහිටා තිබෙන බිම්කැබලි එකක්.
 සිහියම 752.

2634	කන්දපල්ලකෝරලේ නික පොත	සී. නා. මා. සුබසන් කන්කානි	පහත සහ ලපරි කැලේ	7 2 36
------	-----------------------	----------------------------	------------------	--------

අක්කරයක් රූපියල් 10යේ සිට විකුනනු ලැබේ.
 මෙම ඉඩම් ගැණ වැඩිදුර කාරණා සර්වේසර්ජන් ජනරාල් ජනාන්සේගෙන්ද, විකිනීම ගැණ තොරතුරු ලාච්ඡිකාවේ ආණ්ඩුවේ ඒජන්ත ජනාන්සේගෙන්ද දැනගත යුතුයි.
 ගරුකර ආණ්ඩුකාර උතුමානවතන්සේගේ ආඥාවලෙස,
 ජ. තෝමස් වාකර්,
 මහසෙක්කාරිස් වමිහ.

No. 327, P. OF U.

Colonial Secretary's Office,
 Colombo, November 8, 1898.

ON Tuesday, December 20, 1898, at 1 P.M., the Government Agent for the Province of Uva will put up to auction for default of payment of instalments due, at his office in the Kachcheri, the under-mentioned portions of Crown Land, on the terms authorized by Government.

Eighteen allotments of land situated in the Wellawaya division of the Badulla District of the Province of Uva. Preliminary plan 2,930. Claimant—Crown.

Lot.	Village.	Name of Purchaser at previous sale.	Description.	Extent. A. R. P.
39	Sudupanawela	P. D. Dissanayaka Don Samuel Weera-koon Appuhami	Field	0 3 38
132	Do.	do.	do.	3 0 15
133	Do.	do.	do.	1 1 26
134	Do.	do.	do.	1 1 23
135	Do.	do.	do.	1 2 39
136	Do.	do.	do.	1 3 9
137	Do.	do.	do.	1 2 1
138	Do.	do.	do.	1 0 35
139	Do.	do.	do.	2 0 17
140	Do.	do.	do.	1 3 23
152	Do.	Madugolla Kiniwantu	do.	2 1 38
175	Do.	Madugolla Jayarinhami	do.	1 3 17
177	Do.	do.	do.	2 1 12
178	Do.	G. Siyatu	do.	2 1 9
179	Do.	R. Siyatu	do.	0 3 21
181	Do.	W. Kiri Banda	do.	2 2 2
188	Do.	K. Appuhami	do.	2 0 4
189	Do.	do.	do.	2 0 11

Upset price,—Rs. 10 per acre.

Further information regarding these lands may be obtained from the Surveyor-General, and regarding the conditions of sale from the Government Agent, Province of Uva.

By His Excellency the Governor's command,
 E. NOEL WALKER,
 Colonial Secretary.

No. 327, P. OF U.

වමි 1898 ක්වු නොවැම්බර් මස 8 වෙනි දින කොළඹ මහසෙක්කාරිස් උත්තාන්සේගේ කන්කෝරුවේදීය.

ලාච්ඡිකාවේ ආණ්ඩුවේ ඒජන්ත ජනාන්සේ විසින් මෙහි පහත සඳහන්වෙන ආණ්ඩුව සත්තක ඉඩම් වලට මුළු ගනනින් ගෙවන කොට්ඨාස නොගෙවූ බැවින් එම ඉඩම් ආණ්ඩුවේ නියෝගවල ප්‍රකාරයට වමි 1898 ක්වු දෙසැම්බර් මස 20 වෙනි දිනවූ අහහරුවාදා පස්වරු එකට බදු කම්බේරියේදී වෙන්දේසිකර විකුනවන බව දන්වනු ඇත.

ලාච්ඡිකාවේ බදු පලාතේ වැල්ලවා කොට්ඨාසයේ පිහිටා තිබෙන බිම්කැබලි 18ක්.
 සිහියම 2,930. අසිතිකම කියන්නා—රජසත්තක.

නො.	ගම.	ඉල්ලුම්කාරයාගේ නොහොත් මුල් ගැනුම්කාරයාගේ නම.	අත්දම.	මහත. අ. රු. ප.
39	සුදුපානාවෙල	පී. ඩී. දිසානායක, දෙවන සැමුවෙල් විර කෝත් අප්පුහාමි	කුඹුර	0 3 38
132	එම	එම	එම	3 0 15
133	එම	එම	එම	1 1 26
134	එම	එම	එම	1 1 23

C 5*

නො.	නම.	ඉල්ලීමකාරයාගේ නොහොත් මුල්ගැනුම්කාරයාගේ නම.	අයදුම.	මහත. අ. ර. ප.
135	සුද්ධානාවෙල	පී. ඩී. දිසානායක, දෙව් සැමුවෙල් විර කෝන් අප්පුහාමි	කුඹුර	1 2 39
136	එම	එම	එම	1 3 9
137	එම	එම	එම	1 2 1
138	එම	එම	එම	1 0 35
139	එම	එම	එම	2 0 17
140	එම	එම	එම	1 3 23
152	එම	මඩුගොල්ලේගෙදර කිරිවත්තේ, ජයසිරිහාමි	එම	2 1 38
175	එම	එම	එම	1 3 17
177	එම	—	එම	2 1 12
178	එම	පී. සිසානු	එම	2 1 9
179	එම	ආර්. සිසානු	එම	0 3 21
181	එම	වඩලිම්. කිරිවත්තා	එම	2 2 2
188	එම	කේ. අප්පුහාමි	එම	2 0 4
189	එම	එම	එම	2 0 11

අක්කරයක් රූපිතල් 10යේ සිට පටන්ගනු ලැබේ.

මෙම ඉඩම් ගැන වැඩිදුර කාරණා සර්වේසර්ජනරාල්ලන්සාන්සේගෙන්ද, විකුණුම් ගැණ තොරතුරු ලැබේ ආණ්ඩුවේ ඒජන්තලන්සාන්සේගෙන්ද දැනගත යුතුයි.

ගරාභර ආණ්ඩුකාර උතුමානත්තන්සේගේ ආඥාව ලෙස,

ජී. නොඑල් වාකර්,
මහසේනුකාරිස් මමිහ.

No. 328, P. OF U.

Colonial Secretary's Office,
Colombo, November 8, 1898.

ON Tuesday, December 20, 1898, at 1 o'clock P.M., the Government Agent for the Province of Uva will put up to auction, at his office in the Kachcheri, the under-mentioned portions of Crown Land, on the terms authorized by Government.

Ten allotments of land situated in the Udükinda division of the Badulla District of the Province of Uva.

Preliminary plan 791. Village—Palleperuwa in Dehiwinipalata.

Lot.	Name of Applicant.	Name of Claimant.	Description.	Extent. A. R. P.
2749	Ana Ismail Lebbe	Crown	Patana	1 1 0
Preliminary plan 2,974. Village—Moratota in Dehiwinipalata.				
8831	Mr. J. W. de Silva	Crown	Patana and a little forest	17 0 39
L 883	For general sale or settlement	do.	Scrub and old paddy land	1 0 32
8832	Mr. J. W. de Silva	do.	Patana	62 1 25 ^c
8833	For general sale or settlement	do.	Swamp	2 3 23
Upset price,—Rs. 10 per acre.				
8834	For general sale or settlement	do.	Encroachment by Watta-gedara estate	0 0 36
8835	Do.	do.	do.	0 0 20
8836	Do.	do.	do.	0 1 20
8837	Do.	do.	do.	0 0 8

Lots 8,834, 8,835, 8,836, and 8,837 will be sold at upset price of Rs. 15 per acre.

Preliminary plan 737. Village—Ettampitiya Udagama in Dehiwinipalata.

2550	D. Appusinno	Crown	Scrubby patana and a few trees	10 3 3
------	--------------	-------	--------------------------------	--------

Eleven allotments of land in the Wellassa division of the Badulla District of the Province of Uva.

Preliminary plan 815. Village—Hamapola in Nilgala korale.				
2854	Meragalagedara Niyandiya	Crown	Paddy field	0 1 36
2855	Kahatawattagedara Maniha	do.	Land suited for paddy	0 1 15
Preliminary plan 816. Village—Hamapola in Nilgala korale.				
2856	Aruluwinne Sella	Crown	Paddy field	1 2 14
B 91	For sale or settlement	do.	do.	1 2 24
C 91	Do.	Mulatakumburagedara Maniha	do.	1 2 30
D 91	Do.	do.	do.	0 0 38
E 91	Do.	do.	do.	0 2 28
Preliminary plan 817. Village—Hamapola in Nilgala korale.				
2857	Elekewelegedara Dingiriya	Crown	Paddy field	0 1 20
F 91	For sale or settlement	V. Dingiriya	Land suitable for paddy	0 1 33
G 91	Do.	V. Vidane Duraya Ranhinga	Paddy field	1 0 8
Preliminary plan 807. Village—Kanawegolla in Wegam pattu.				
2829	Gorakawela Appuhamy	Dissanayaka Crown	Patana and scrub	0 0 33

Upset price,—Rs. 10 per acre.

* Less reservation for path to be marked.

Further information regarding these lands may be obtained from the Surveyor-General, and regarding conditions of sale from the Government Agent, Uva.

By His Excellency the Governor's command,

E. NOEL WALKER,
Colonial Secretary.

No. 328, P. OF U.

වම 1898 ක්වු නොවැම්බර් මස 8 වෙනි දින කොළඹ මහසෙනෙකාරිස්ථානයේ කන්තෝරුවේදී.

ඉ දිසාවේ ආණ්ඩුවේ ඒජන්තලත්තාන්සේ විසින් මෙහි පහත සඳහන්වෙන ආණ්ඩුව සන්තක ඉඩම් ආණ්ඩුවේ නියෝගවල ප්‍රකාරයට වම 1898 ක්වු අවුරුද්දේ දෙසැම්බර් මස 20 වෙනි දිනවු අහගරු වාද එකේ කතිසමට බදු එකවරින්දේදී වෙන්දේසිකර විකුණනට යෙදෙනවා ඇත.

ඉඵ දිසාවේ බදු එකවරින්දේදී වෙන්දේසිකර විකුණනට යෙදෙනවා ඇත.
 සිතියම 791. අයිතිකම කියන්නා—රජසන්තක.

නො.	ගම.	ඉල්ලුම්කාරයා.	අන්දම.	මහත. අ. රු. ප.
2749	දෙහිවිනි පලාත පල්ලේ පේරුවේ	ආනා. ඉස්මයිල් ලෙබ්බේ	පහත	1 1 0
8831	දෙහිවිනි පලාත මොර නොට	ජේ. ඩබ්ලිව්. ඩී. සිල්වාලත්නාගේ	පහත සහ පොඩ්කැලෑ බ්ම	17 0 39
L 383	එම	විකිනිමට නොහොත් බේරිමට	පරන කුඹුර	1 0 32
8832	එම	ජේ. ඩබ්ලිව්. ඩී. සිල්වාලත්නාගේ	පහත*	62 1 25
8833	එම	විකිනිමට නොහොත් බේරිමට	මඩවගුර	2 3 23
8834	එම	එම	වත්තේගෙදර වත්තට අල්ලාගන්නබෙන	0 0 36
8835	එම	එම	එම	0 0 20
8836	එම	එම	එම	0 1 20
8837	එම	එම	එම	0 0 8

නොමමර 8834, 3835, 8836, 8837 සහ බිම්කට්ටි අක්කරයක් රුපියල් 15෦෦ සිට පටන්ගනු ලැබේ.
 සිතියම 737.

2550	දෙහිවිනිපලාත ඇවත් පිටියේ උඩගම	ඩී. අප්පසිඤ්ඤා	සිතිය කැලේ	10 3 3
------	-------------------------------	----------------	------------	--------

ඉඵ දිසාවේ බදු එකවරින්දේදී වෙන්දේසිකර විකුණනට යෙදෙනවා ඇත.
 සිතියම 815.

2854	නිල්ගලකෝරලේ ගම පොලගම	මිරිගලගෙදර නියන්දසා	කුඹුර	0 1 36
2855	එම	කහටවත්තේගෙදර මැනිකා	වී වැපිරිමට හොඳ බ්ම	0 1 15
2856	එම	අරඑවත්තේ ගෙල්ලා	කුඹුර	1 2 14
1391	එම	විකිනිමට නොහොත් බේරිමට	එම	1 2 24
C 91	එම	අයිතිකම කියන්නා—මුලගේ කුඹුරේගෙදර මැනිකා	එම	1 2 30
D 91	එම	විකිනිමට නොහොත් බේරිමට	එම	0 0 38
E 91	එම	එම	එම	0 2 28

2857	එම	සිතියම 817. අයිතිකම කියන්නා—රජසන්තක. ඇලකවෙලගෙදර ඩික්කිරියා	එම	0 1 20
F 91	එම	අයිතිකම කියන්නා—වී. ඩික්කිරියා. විකිනිමට නොහොත් බේරිමට	වී වැපිරිමට හොඳ බ්ම	0 1 33
G 91	එම	අයිතිකම කියන්නා—වී. මිදුනදුරු රත්කිරියා. විකිනිමට නොහොත් බේරිමට	කුඹුර	1 0 8

2829	මැදගත්පත්තුවේ කනවැ ගොල්ලේගම	සිතියම 807. අයිතිකම කියන්නා—රජසන්තක. ගොරකවෙල දිසානායකඅප්පහාමි	පහත සහ සිතියකැලේ	0 0 33
------	-----------------------------	---	------------------	--------

අක්කරයක් රුපියල් 10෦෦ සිට පටන්ගනු ලැබේ.

* පාරට ඉඩඅරින තෙක බලනු.

මෙම ඉඩම් ගැණ වැඩිදුර කාරණා සර්වේශ්වර්ජනලත්තාන්සේගෙන්ද, විකිනුම් ගැණ කොරතුරු ඉඵ දිසාවේ ආණ්ඩුවේ ඒජන්තලත්තාන්සේගෙන්ද දැනගත හුනුයි.

ගරුගර ආණ්ඩුකාර උතුමානත්තන්සේගේ අභෞලය,
 ඊ. නොඑල් වාකර්,
 මහසෙනෙකාරිස් වමික.

NOTICE UNDER ORDINANCE No. 1 OF 1897.

[An Ordinance relating to Claims to Forest, Chena, Waste, and Unoccupied Lands.]

Order under Section 2 ~~of Ordinance No. 1 of 1897~~, declaring the Land to be Crown Property.

In the matter of lands commonly called and known as Talagulana, Pellaledeniya, Kongahagawadeniya, and Batahena (lots 12,850, 12,851, 12,852, 12,853, 12,855, 12,856, and 12,857), situate in the village of Horagala in the Matara-Morawak korale, in the Southern Province, and of the Ordinance No. 1 of 1897.

THE notice required by section 1 of the Ordinance No. 1 of 1897 having been duly published in the *Government Gazette* and in two of the newspapers published in the Island, the first of such publications in the said *Gazette* having been in the *Gazette* No. 5,545 dated 22nd April, 1898, in respect of the above-named lands, and no claim having been made to the said lands or to any interest therein within the period of three months from the said date of the said notice:

I, John Penry Lewis, Special Officer appointed under section 28 of Ordinance No. 1 of 1897, under and by virtue of the powers vested in me in that behalf by section 2 of the said Ordinance, do hereby on this twenty-second day of July, 1898, order and declare that the said lands, commonly called and known as Talagulana, Pellaledeniya, Kongahagawadeniya, and Batahena (lots 12,850, 12,851, 12,852, 12,853, 12,855, 12,856, and 12,857), situate in the village of Horagala in the Matara-Morawak korale, in the Southern Province, and shown as lots 12,850, 12,851, 12,852, 12,853, 12,855, 12,856, and 12,857 in preliminary plan 4,647 of lands situate in the said village, a certified copy whereof is

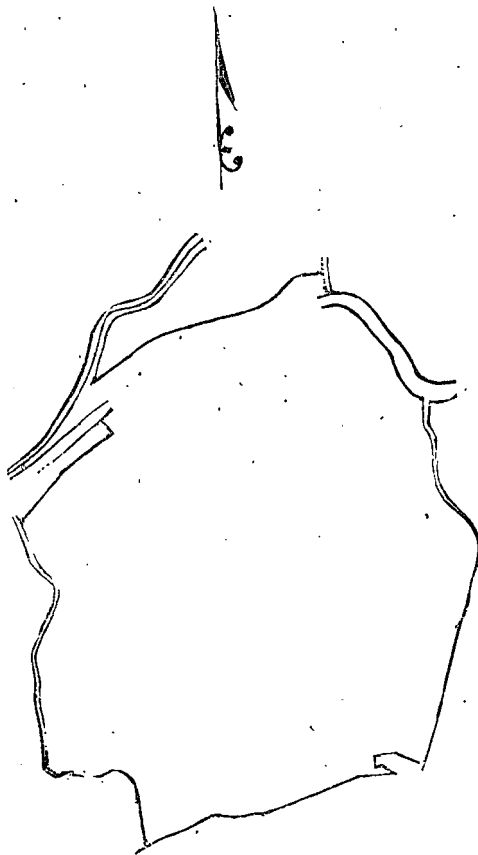

Surveyor-General's Office,
Colombo, August 4, 1898.

4,647
12,850 to 12,853 & 12,855 to 12,857

ALFRED E. WACKRILL,
Acting Assistant Surveyor-General.

hereunto annexed, and containing in extent 124 acres 2 roods and 7 perches, and bounded as follows: on the north by Kapuwawatta *alias* Hewanketeokanda (lot 12,854 in preliminary plan 4,647) claimed by Atanikitage Ukuhami, the Nil-ganga; on the east by the Talagulanedola and Batahena belonging to Crown; on the south by Talagulanadeniya belonging to Crown, Talagulanehena belonging to Crown, and Kalugaladeniya belonging to Crown; on the west by Horagaloda, belonging to Crown and the Kapuwadola—are the property of the Crown.

Matara, the 22nd day of July, 1898.

J. P. LEWIS,
Special Officer.

Order made under Section 4 of Ordinance No. 1.

In the matter of the lands commonly called or known as Hangarankanda and Getabarukanda, situate in the village of Kotapola, in the Matara-Morawak korale, in the Southern Province.

WHEREAS in pursuance of section 1 of the Ordinance No. 1 of 1897 it was duly declared and notified on the Sixth day of May, One thousand Eight hundred and Ninety-eight, that if no claim to the lands commonly called or known as Hangarankanda and Getabarukanda, situate in the village of Kotapola in the Matara-Morawak

korale, in the Southern Province, containing in extent two hundred and seventy acres and thirty-seven perches (270A. 37P.), and shown as lots 12,833, 12,834, 12,835, 12,836, 12,829, 12,830, 12,837, 12,839, 12,840, 12,847, 12,846, 12,848, and 12,841 in preliminary plan 4,647, was made to the Special Officer appointed under Ordinance No. 1 of 1897,



4,647

12,833, 12,834, 12,835, 12,836, 12,829, 12,830, 12,837, 12,839, 12,840, 12,847, 12,848, 12,846, and 12,841

Surveyor-General's Office,
Colombo, March 8, 1898.

P. D. WARREN,
Assistant Surveyor-General.

within the period of three months from the date of such declaration and notice, such land would be deemed the property of the Crown and dealt with on account of the Crown; and whereas one Mantrige Adirian of Kotapola made claim to half of a portion of the said land, commonly called or known as Hangarankanda, containing in extent one hundred and thirty-two acres two roods and thirty perches (132A. 2R. 30P.), and shown as lots 12,834, 12,836, 12,837, 12,846, and 12,847 in preliminary plan 4,647, and I, John Penry Lewis, being appointed Special Officer under the said Ordinance, made due inquiry into such claim; and whereas I and the said claimant have, with the consent of His Excellency the Governor, come to an agreement in writing concerning the said portion under section 4, sub-section 1, of the said Ordinance:

It is hereby ordered, in pursuance of the agreement afore-mentioned, that the said Mantrige Adirian do pay to the Assistant Government Agent at Matara a sum of Rupees six hundred and fifty (Rs. 650) on or before the Sixth day of November, One thousand Eight hundred and Ninety-eight, and thereupon the said claimant shall be declared to be the purchaser of a portion of the said Hangarankanda, situate at Kotapola in the Matara-Morawak korale, in the Southern Province, containing in extent sixty-four acres two roods and eleven perches (64A. 2R. 11P.), as described in the annexed plan 4,647 (lots 12,837, 12,846, and 12,847), and bounded as follows : on the north by a portion

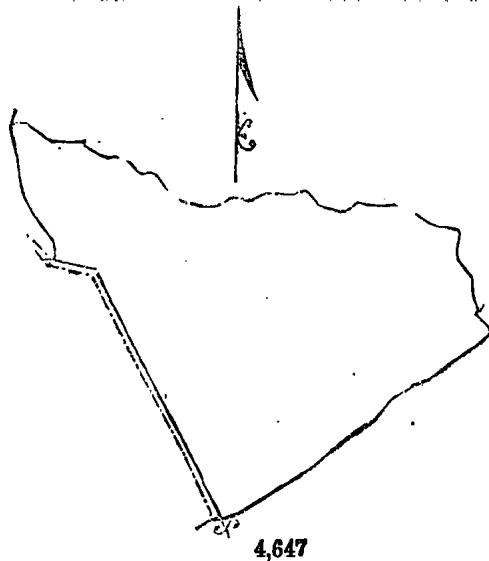

4,647
12,837, 12,846, and 12,847

Surveyor-General's Office,
Colombo, August 29, 1898.

ALFRED E. WACKRILL,
Acting Assistant Surveyor-General.

of Hangarankanda and the reservation of the Galdola (lot 12,836 in preliminary plan 4,647) ; on the east by Weraniyahenawatta belonging to Crown (lot 12,838 in preliminary plan 4,647), and the reservation of the high road from Matara to Deniyaya (lot 12,848 in preliminary plan 4,647) ; on the south by the reservation of the high road from Matara to Deniyaya (lot 12,848 in preliminary plan 4,647), and another portion of Hangarankanda (lot 12,839 in preliminary plan 4,647) ; on the west by a portion of Hangarankanda (lot 12,839 in preliminary plan 4,647) and the footpath from Waralla to Getabarukanda Vihare :

It is further ordered, in pursuance of the aforesaid agreement, that in failure of payment of the said sum of rupees Six hundred and fifty (Rs. 650) on or before the due date, the said portion of Hangarankanda shall be declared to be the property of the Crown :

It is also hereby ordered, in pursuance of the agreement, afore-mentioned, that the remaining portion of the said land called Hangarankanda, situate in the village of Kotapola in the Matara-Morawak korale, in the Southern Province, containing in extent sixty-eight acres and nineteen perches (68A 19P.), as described in the annexed plan 4,647 (lots 12,834 and 12,836), bounded on the north by a portion of Hangarankanda (lot 12,833 in preliminary

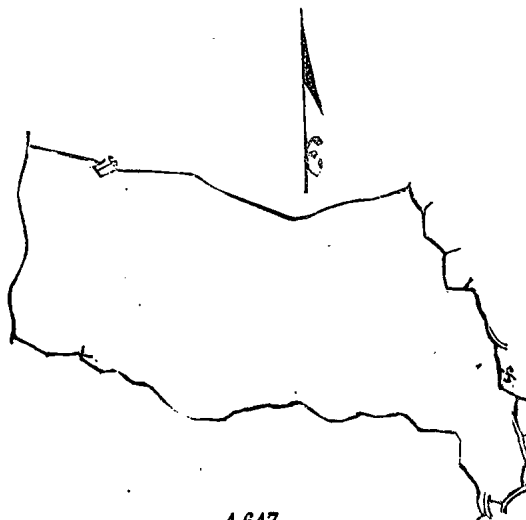

4,647
12,834 and 12,836

Surveyor-General's Office,
Colombo, August 29, 1898.

ALFRED E. WACKRILL,
Acting Assistant Surveyor-General.

plan 4,647) and the Halgasmulledola (lot 12,835 in preliminary plan 4,647) ; on the east by Halgasmullehena sold by Crown to D. J. Wiraman (lots 6,794 and 6,792 in preliminary plan 792), Halgasmullehena sold by Crown to Don Bastian Kumarasinha (lot 6,791 in preliminary plan 792) Wilehenadeniya sold by Crown to the late James de Silva, Mudaliyar (title plan 98,131), and Weraniyawatta alias Galgodagawawatta sold by Crown to Don Johannes Abeywardana Jayasinha (title plan 94,952) ; on the south by a portion of Hangarankanda (lot 12,837 in preliminary plan 4,647) ; on the west by the footpath from Waralla to Getabarukanda Vihare, be, and it hereby is, declared the property of the Crown.

Matara, 8th September, 1898.

J. P. LEWIS,
Special Officer.

Order under Section 2 of Ordinance No. 1 of 1897, declaring the Land to be Crown Property.

In the matter of lands commonly called and known as Hangarankanda and Getabarukanda (lots 12,833, 12,834, 12,835, 12,836, 12,829, 12,830, 12,837, 12,839, 12,840, 12,847, 12,848, 12,846, and 12,841), situate in the village of Kotapola in the Matara-Morawak korale, in the Southern Province, and of the Ordinance No. 1 of 1897.

THE notice required by section 1 of the Ordinance No. 1 of 1897 having been duly published in the *Government Gazette* and in two of the newspapers published in the Island, the first of such publications in the said *Gazette* having been in the *Gazette* No. 5,549 of 6th May, 1898, in respect of the above-named lands, and no claim having been made to the lots 12,833, 12,835, 12,829, 12,830, 12,839, 12,840, 12,848, and 12,841, or to any interest therein within the period of three months from the said date of the said notice :

I, John Penry Lewis, Special Officer appointed under Ordinance No. 1 of 1897, under and by virtue of the powers vested in me in that behalf by section 2 of the said Ordinance, do hereby on this Sixth day of August, 1898, order and declare that the following lands, both commonly called and known as Hangarankanda and Getabarukanda, situate in the village of Kotapola in the Matara-Morawak korale, in the Southern Province, and shown respectively as lots 12,833, 12,835, 12,829, and 12,830, and lots 12,839, 12,840, 12,848, and 12,841 in preliminary plan 4,647 of lands situate in the said village, a certified copy whereof is hereunto annexed, and containing in extent respectively (1) sixty



Surveyor-General's Office,
Colombo, August 29, 1898.

ALFRED E. WACKRILL,
Acting Assistant Surveyor-General.

acres three roods and thirty-four perches (60A. 3R. 34P.); (2) seventy-six acres two roods and thirteen perches (76A. 2R. 13P.): (1) bounded on the north by the footpath leading from the high road to Getabarukanda Vihare ; on the east

by Galgodahena *alias* Anakkalahena (lot N 320 in preliminary plan 792) sold by Crown to J. D. Wiraman, Anakkalaudahadeniya (lot 12,831 in preliminary plan 4,647) belonging to Crown, Lindagawahena (lot M 320 in preliminary plan 792) belonging to D. J. Wiraman, Wadugewattadola, Wadugewattadeniya sold by Crown to Don Andris Wijesiri Jayawardana (title plan 85,060), Halgasmullehena sold by Crown to D. J. Wiraman (lots 6,795 and 6,794 in preliminary plan 792); on the south by a portion of Hangarankanda (lot 12,834 in preliminary plan 4,647); on the west by the footpath from Waralla to Getabarukanda Vihare and by a portion of Getabarukanda (title plan 94,957); and (2) bounded on the north by the footpath from Waralla to Getabarukanda Vihare; on the east by a portion of Hangarankanda (lots 12,837 and 12,846 in preliminary plan 4,647), Weraniyahenawatta *alias* Galdolagawawatta (lot 12,838 in preliminary plan 4,647); on the south by the high road from Matara to Deniyaya, Kudaludeniya belonging to Crown (lot 12,845 in preliminary plan 4,647), Kudaludeniya-kumbura claimed by Don Abraham Abeywardana Jayasinha Gunaratna and others (lots M 331, N 331, L 331, K 331, and J 331 in preliminary plan 814), Kudaludeniya claimed by Don Abraham Abeywardana Jayasinha Gunaratna and others (lot 12,844 in preliminary plan 4,647), and the high road from Matara to Deniyaya; on the west by Ulundupitiya-okanda sold by Crown to Liyanage Don Andris (title plan 93,536), Ulundupitiyadeniya belonging to Crown (lots 12,842 and 12,843 in preliminary plan 4,647), Paranawatta belonging to James Wiraman and others, Arachchigewatta belonging to the heirs of Don Andris Abeygunawardana, Polwattawila belonging to the heirs of Don Andris Abeygunawardana, Polwattawilagawa-okanda sold by Crown to the late Don Andris Abeygunawardana (title plan 145,535), Polwattawilaudahakoratuwawatta belonging to Liyanage Adrian and others, Polwattawelawatta belonging to Liyanage Adrian and others, Gallindagawa-okanda claimed by Hedawattege Jayan, and the footpath from Waralla to Getabarukanda Vihare—are the property of the Crown.

Matara, 6th August, 1898.

J. P. LEWIS,
Special Officer.

Agreement under Section 4 of Ordinance No. 1

In the matter of the lands commonly called or known as Talagulana, Kapuwawatta, Pellaledeniya, Kongahagawadeniya, and Batahena, situate in the village of Horagala in the Matara-Morawak korale, in the Southern Province, and of the Ordinance No. 1 of 1897.

WHEREAS, in pursuance of section 1 of the Ordinance No. 1 of 1897, it was duly declared and notified on the Twenty-second day of April, One thousand Eight hundred and Ninety-eight, that if no claim to the lands commonly called or known as Talagulana, Kapuwawatta, Pellaledeniya, Kongahagawadeniya, and Batahena, situate in the village of Horagala in the Matara-Morawak korale, in the Southern Province, containing in extent one hundred and twenty-six acres and one perch (126A. 1r.), and shown as lots 12,850, 12,851, 12,852, 12,853, 12,854, 12,855, 12,856, and 12,857 in preliminary plan 4,647, was made to the Special Officer appointed under Ordinance No. 1 of

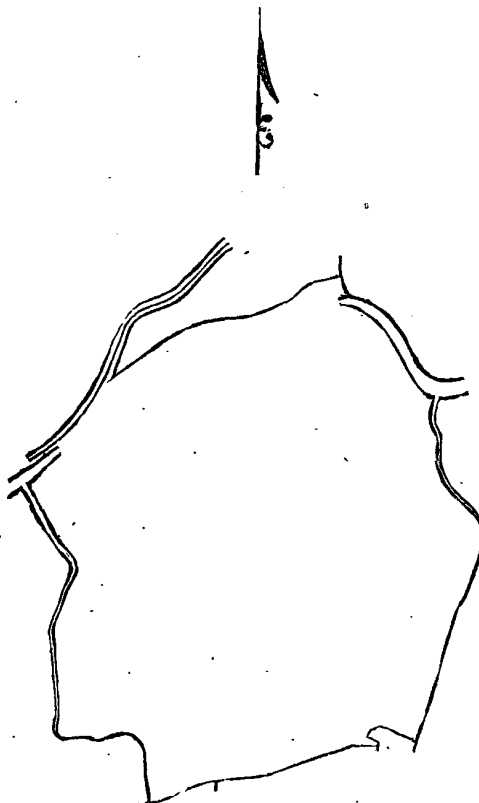

Surveyor-General's Office,
Colombo, September 7, 1898.

4,647
12,850 to 12,857

ALFRED E. WACKRILL,
Acting Assistant Surveyor-General.

1897, within the period of three months from the date of such declaration and notice, such land would be deemed the property of the Crown and dealt with on account of the Crown; and whereas one Atanikitage Ukkunhamy of Waralla

made claim to that portion of the said land commonly called or known as Kapuwawatta *alias* Hewanketeokanda, in extent one acre one rood and thirty-four perches (1A. 1R. 34P.), and I, John Pansy Lewis, being appointed Special Officer under the Ordinance, made due inquiry into such claim; and whereas I and the said claimant have come to an agreement in writing concerning the said portion under section 4, sub-section 1, of the said Ordinance:

It is hereby ordered, in pursuance of the agreement afore-mentioned, that the said Atanikitage Ukkahamy do pay to the Assistant Government Agent at Matara a sum of rupees fifteen (Rs. 15) on or before the Thirty-first day of November, One thousand Eight hundred and Ninety-eight, and thereupon the claimant shall be declared to be the purchaser of the said land Kapuwawatta *alias* Hewanketeokanda, situate in the village of Horagala in the Matara-Morowak korale, in the Southern Province, containing in extent one acre one rood and thirty-four perches (1A. 1R. 34P.), as described in the annexed plan 4,647 (lot 12,854), bounded as follows: on the north by the Nil-ganga; on

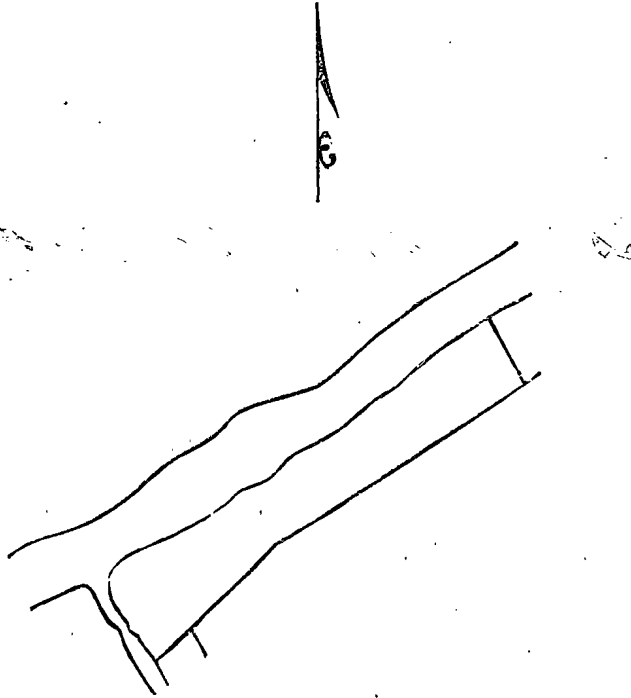

4,647
12,854

Surveyor-General's Office,
Colombo, September 7, 1898.

ALFRED E. WACKRILL,
Acting Assistant Surveyor-General.

the east by the Talagulanadola and Batahena belonging to Crown; on the south by Talagulanedeniya belonging to Crown, Talagulanahena belonging to Crown, and Kalugaladeniya belonging to Crown; and on the west by Horagal-goda belonging to Crown and the Kapuwadola.

It is further ordered, in pursuance of the said agreement, that in failure of payment of the said sum of rupees fifteen on or before the due date, the said land Kapuwawatta *alias* Hewanketeokanda shall be declared to be the property of the Crown.

Matara, August 5, 1898.

J. P. LEWIS,
Special Officer.

Order under Section 2 of Ordinance No. 1 of 1897, declaring the Land to be Crown Property.

In the matter of the land commonly called and known as Waljambuhena, situate in the village of Midigama, in the Matara-Weligam korale, in the Southern Province, and of the Ordinance No. 1 of 1897.

THE notice required by section 1 of the Ordinance No. 1 of 1897, having been duly published in manner prescribed by that section, and no claim having been made to the said land or to any interest therein within the period of three months from the date of the said notice :

I, John Penry Lewis, Special Officer appointed under section 28 of Ordinance No. 1 of 1897, under and by virtue of the powers vested in me in that behalf by section 2 of the said Ordinance, do hereby on this Seventeenth day of September, One thousand Eight hundred and Ninety-eight, order and declare that the said land, commonly called and known as Waljambuhena, situate in the village of Midigama, in the Matara-Weligam korale, in the Southern

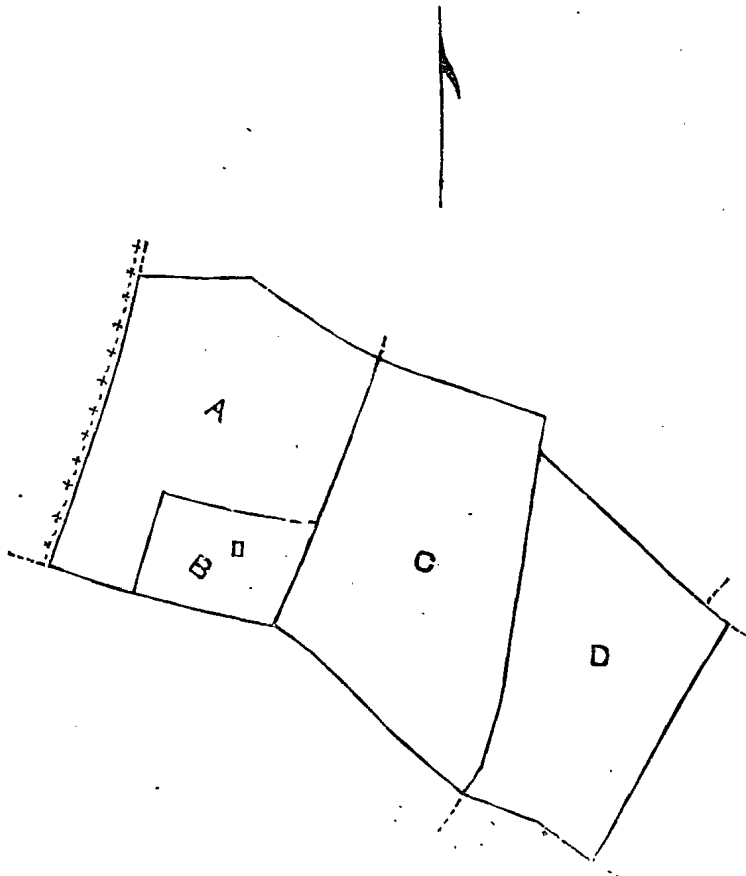

Scale : 4 chains to the inch.

Containing in extent :—

	A.	R.	P.
A	2	2	8
B	0	2	22
C	3	0	0
D	2	1	2
	<u>8</u>	<u>1</u>	<u>32</u>

Surveyor-General's Office,
Colombo, January 20, 1898.

P. D. WARREN,
Assistant Surveyor-General.

Province, and shown as lots A, B, C, D in the plan dated 17th December, 1897, made by Mr. J. A. Booy, Licensed Surveyor, of lands situate in the said village, a certified copy whereof is hereunto annexed; and containing in extent about 8 acres 1 rood and 32 perches, and bounded as follows: on the north by Aludombawatta belonging to Don Sedris de Silva Gunasila Jayawardena and others, Laʷulugahakoratuwa belonging to Paragahawattege Babiana, Ratajumbugahawatta belonging to Eboris Perera and others, Ambagahawatta belonging to Welhenakankanage Odris and others, on the east by Dolehena claimed by Welhenakankanage Odris and others, on the south by Pattuwedeniya belonging to Vidanapatiranage Nicholas and others, Kongasdeniya belonging to Rayigama Korlage Salmon and others, on the west by Aludombehena belonging to Crown and the boundary of the Matara District—is the property of the Crown.

Matara, the 17th day of September, 1898.

J. P. LEWIS,
Special Officer.

Order under Section 2 ~~of Ordinance No. 1 of 1897~~, declaring the Land to be Crown Property.

In the matter of the land commonly called and known as Kekunadurakele, situate in the villages of Kekunadura and Parawahera in the Matara-Wellaboda pattuwa, in the Southern Province, and of the Ordinance No. 1 of 1897.

THE notice required by section 1 of the Ordinance No. 1 of 1897 having been duly published in manner prescribed by that section, and no claim having been made to the said land or to any interest therein within the period of three months from the date of the said notice :

I, John Penry Lewis, Special Officer appointed under section 28 of Ordinance No. 1 of 1897, under and by virtue of the powers vested in me in that behalf by section 2 of the said Ordinance, do hereby on this Eighth day of October, One thousand Eight hundred and Ninety-eight, order and declare that the said land, commonly called and

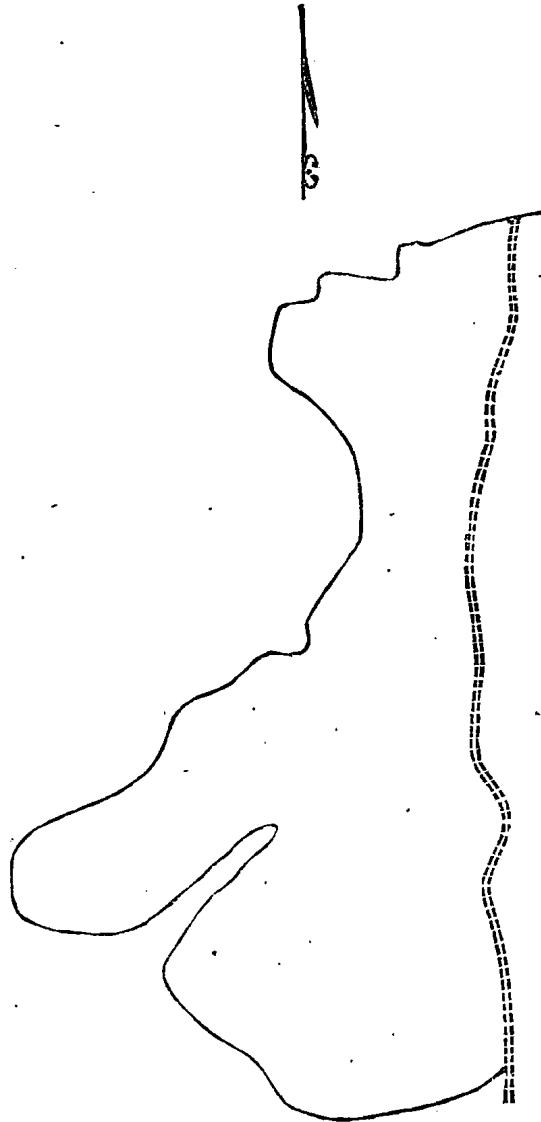

Surveyor-General's Office,
Colombo, October 5, 1897.

35A 1R. 37P.

P. D. WARREN,
Assistant Surveyor-General.

known as Kekunadurakele, situate in the villages of Kekunadura and Parawahera in the Matara-Wellaboda pattuwa, in the Southern Province, and shown as that portion of Kekunadurakele lying to the east of the Kekunadura tank, in preliminary plan No. 3,296 of lands situate in the said village, a certified copy whereof is hereunto annexed ; and containing in extent about 35 acres 1 rood and 37 perches, and bounded as follows : on the north, west, and south by the Kekunadura tank, and on the east by the minor road from Kekunadura to Aparekka—is the property of the Crown.

Matara, the 8th day of October, 1898.

J. P. LEWIS,
Special Officer.

Order under Section 2 ~~of Ordinance No. 1 of 1897~~, declaring the Land to be Crown Property.

In the matter of land commonly called and known as Gorogodella forest, situate in the village of Diviture, in the Galle-Gangaboda pattu, in the Southern Province, and of the Ordinance No. 1 of 1897.

THE notice required by section 1 of the Ordinance No. 1 of 1897 having been duly published in the *Government Gazette* and in two of the newspapers published in the Island in manner prescribed by that section in respect of the above-named land, and no claim having been made to the said land or to any interest therein within the period of three months from the date of the said notice :

I, Herbert Wace, Government Agent of the Southern Province, under and by virtue of the powers vested in me in that behalf by section 2 of the said Ordinance, do hereby on this Eighth day of October, 1898, order and declare

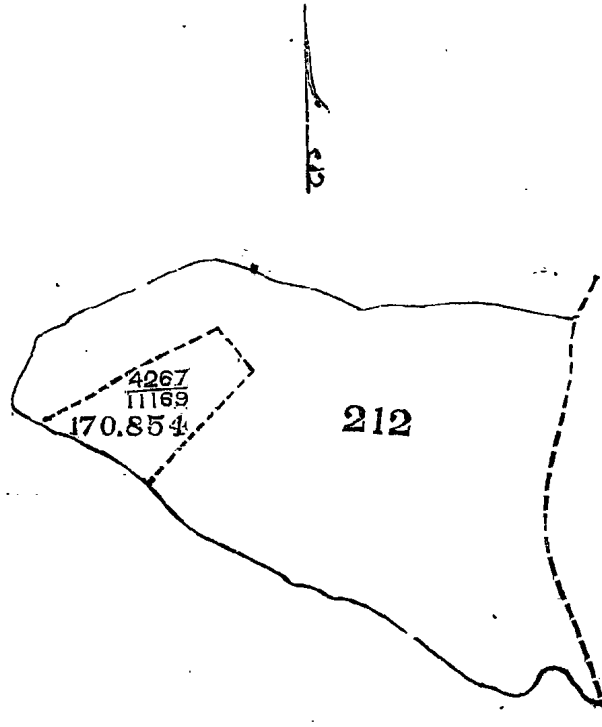

Surveyor-General's Office,
Colombo, January 13, 1898.

P. D. WARREN,
Assistant Surveyor-General.

that the said land, commonly called and known as Gorogodella forest, situate in the village of Diviture, in the Galle-Gangaboda pattu, in the Southern Province, and shown as lot 212 in village plan dated 23rd July, 1861, of lands situate in the said village, a certified copy whereof is hereunto annexed; and containing in extent about twenty-three acres, and bounded as follows: north by Kosgahawilakumbura, south by Dediwila, east by Kosgaha and Dediwila-kumbura, and west by portion of Gorogoda forest and land described in title plan No. 170,854—is the property of the Crown.

Galle Kachcheri,
The 8th day of October, 1898.

H. WACE,
Government Agent.

Order under Section 2 of Ordinance No. 1 of 1897, declaring the Land to be Crown Property.

In the matter of land commonly called and known as Karangahawaladuwa forest, situate in the village of Diviture, in the Galle-Gangaboda pattu, in the Southern Province, and of the Ordinance No. 1 of 1897.

THE notice required by section 1 of the Ordinance No. 1 of 1897 having been duly published in manner prescribed by that section, and no claim having been made to the said land or to any interest therein within the period of three months from the date of the said notice:

I, Herbert Wace, Government Agent of the Southern Province, under and by virtue of the powers vested in me in that behalf by section 2 of the said Ordinance, do hereby on this 15th day of October, 1898, order and declare that the said land commonly called and known as Karangahawaladuwa forest, situate in the village of Diviture, in the

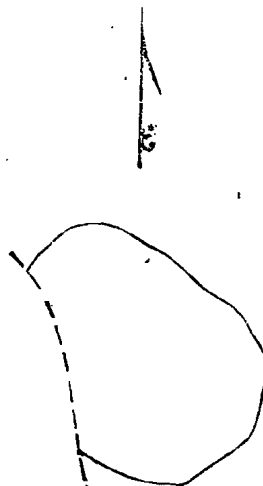

Surveyor-General's Office,
Colombo, January 13, 1898.

P. D. WARREN,
Assistant Surveyor-General.

Galle-Gangaboda pattu, in the Southern Province, and shown as lot 519 in village plan dated 23rd July, 1861, of lands situate in the said village, a certified copy whereof is hereunto annexed; and containing in extent about 8

acres, and bounded as follows: north by Uramalahena, south by Ginigalmanana east by Uramalahena, Udumulla, and west by portion of Karangahawelabedda—is the property of the Crown.

Galle Kachcheri,
The 15th day of October, 1898.

H. WACE,
Government Agent.

Order under Section 2 of Ordinance No. 1 of 1897, declaring the Land to be Crown Property.

In the matter of land commonly called and known as Duwawalakanda forest, situate in the village of Diviture, in the Galle-Gangaboda pattu, in the Southern Province, and of the Ordinance No. 1 of 1897.

THE notice required by section 1 of the Ordinance No. 1 of 1897 having been duly published in manner prescribed by that section, and no claim having been made to the said land or to any interest therein within the period of three months from the date of the said notice:

I, Herbert Wace, Government Agent of the Southern Province, under and by virtue of the powers vested in

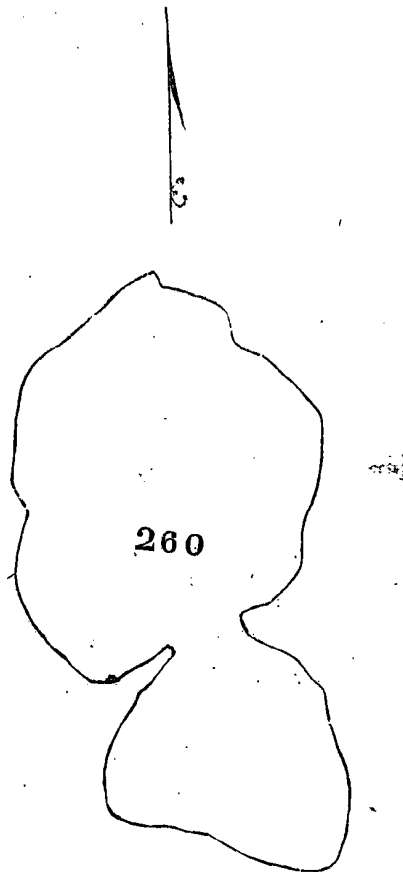

Surveyor-General's Office,
Colombo, January 13, 1898.

P. D. WARREN,
Assistant Surveyor-General.

me in that behalf by section 2 of the said Ordinance, do hereby on this 15th day of October, 1898, order and declare that the said land, commonly called and known as Duwawalakanda forest, situate in the village of Diviture, in the Galle-Gangaboda pattu, in the Southern Province, and shown as lot 260 in village plan dated 23rd July, 1861, of lands situate in the said village, a certified copy whereof is hereunto annexed; and containing in extent about twenty-five acres, and bounded as follows: north by Miriswattemananakumbura, south by Duwapara-addarakumbura, east by Horawahallakumbura, and west by Duwawalapara-addarakumbura—is the property of the Crown.

Galle Kachcheri,
The 15th day of October, 1898.

H. WACE,
Government Agent.

SALES OF ARRACK, TOLL, AND OTHER RENTS.

NOTICE is hereby given that the Government Agent for the Central Province will receive sealed tenders for the purchase of the under-mentioned Toll Rents of the Central Province from January 1 to December 31, 1899. The tenders, which must be in sealed envelopes superscribed "Tender for Toll Rents," will be received at the Kandy Kachcheri until 12 o'clock noon on Monday, November 21, 1898, when they will be opened, and all persons making tenders will be required to be present or to satisfy the Government Agent by some duly accredited agents that the tender is made bona fide. If the tenders are not satisfactory, the rents will be sold immediately by public auction.

The person whose tender is selected by the Government Agent for submission to the Governor will be required to deposit at once one-tenth of the purchase amount in cash, and should the tender be accepted by His Excellency the Governor, to furnish approved security for one-half of the whole purchase amount, or in cash for one-third of the whole purchase amount, within thirty days of the date of the receipt by him of the notification of the Governor's acceptance of his offer.

He will also be required to deposit money to pay the fees of the Crown Counsel for examining and giving his opinion on the title deeds of properties tendered by him as security, and for examining and settling the security bond, and the fees charged by the Crown Proctor for examining documents and drawing the security bond, and also the expenses for appraising the properties and of registering the security bond.

All title deeds tendered as security should be accompanied by a certificate obtained from the Registrar of Lands that the lands to which they relate are unencumbered. This certificate must be obtained at the cost of the party offering the security.

Further information can be obtained on application to the Government Agent.

Municipal Tolls.

- 1. Peradeniya bridge and Iriyagama road toll.
2. Katugastota bridge and road toll.
3. Gonawatta ferry and Talatu-oya bridge. Payment of toll at either place on the same day will clear the other.
4. Halloluwa ferry.
5. Ilukmodara and Kundasale ferries.

Government Tolls.

- 1. Ramboda road toll and toll at Tawalantenna. Payment of toll at either place, on the same day will clear the other.
2. Pannal-oya bridge.
3. Bambarakele-Kodigaha road toll.
4. Gondennawa road toll.
5. Teldeniya bridge and Kengalla road toll.
6. Kaluda Ella-Perabahutenna road toll.
7. Balakaduwa road toll.
8. Kolongahamulla road toll.
9. Weragantota ferry.

Kandy Kachcheri, November 8, 1898.

ALLANSON BAILEY, Government Agent.

මෙහි පහත සඳහන් වන මහලු දිසාවේ පාලම් රේන්ද වර්ෂ 1899 ක්වූ ජනවාරි මස 1 වෙනි දින පටන් දෙසැම්බර් මස 31 වෙනි දින දක්වා ආණ්ඩු වෙන් බදුගැනීමට එවකලද මුද්‍රලත් ඉල්ලුම්පත් මහලු දිසාවේ ආණ්ඩුවේ ඒජන්තලන්තාන්සේ විසින් භාර ගනු ලැබේ.

මතුකි මුද්‍ර ලත් ඉල්ලුම්පත් මතුපිට ගෙවත් ඇත්වි ලොප් ලබා "Tender for Toll Rents" පාලම් රේන්ද සඳහා ඉල්ලුම්පත්‍රය සහ වාසගම ඇතුළු වර්ෂ 1898 වේ නොවැරදි මස 21 වෙනි සඳුදා දවල් 12 වනතුරු

මහලුවර කවිවේරියට භාරගනු ලැබේ. එවිට එහිදී ඒවායේ මුද්දර කඩා බලනවා ඇත. තවද ඉල්ලුම්පත්‍ර දිසවිත සෑමදෙනාම ඉදිරිපිටට ඇවිදිත් (නැතහොත් තමන් විසින් වෙන අගෙකුට නිසි බලයක්දී ඔහු එවා භෝ) ඒ දෙනලද ඉල්ලුම්පත්‍ර සැබෑවූ ඇත්තේ ඒවා බවට ඒජන්තලන්තාන්සේට ඒත්තුගන්වනට ඕනෑම. ඉල්ලුම්පත්‍ර ඒත්තුගන්වා, ලෙස නොතිබුනොත් එව ලේම එම රේන්ද ප්‍රසිධි වෙන්දේසිකර විකුනනට ගෙදේ.

ආණ්ඩුවේ ඒජන්තලන්තාන්සේ විසින් උතුමානන් වහන්සේ වෙත ඔප්පුකර සිටීමට ගෝරුගන්නාලද ඉල්ලුම්පත්‍රය අයිතිකාරයා විසින් ඉල්ලාපු ගණනෙන් දහගෙන් කොටසකට වැටගෙන මුද්‍රලත්ගණන සල්ලී වලින් වහාම ඇප නිබන්ධ ඕනෑවා සමඟකුත් නොව එම ඉල්ලීම උතුමානන්වහන්සේ විසින් භාරගන්නට ගෙදුනිතම ඔහුගේ ඉල්ලීම උතුමානන්වහන්සේ විසින් ඒත්තුගන්වන දුනුදුගත් දන පටන් නිස්දවසක් ඇතුලතදී එම ඉල්ලු ගණනෙන් දෙනෙක් පංඉවකට වටිනා ඇප ඒත්තුගන් මුද්‍ර ඔප්පුවලින් ගෝ තුනෙන් පංඉව කට වටිනා ඇප මුද්‍රලෙන් ගෝ කඩා සම්පුණ්ණ කරනනට ඕනෑම.

ඇප පිණිස නිවනලද ඔප්පු සෝදිසිනිරීම සඳහා ආණ්ඩුවේ අදවකාන්තලන්තාන්සේට ගෙවිය යුතු ගාස්තු වද, ඇප ඔප්පු සෑදීමටද, ඒවා සෝදිසිකර සම්පුර්ණ කෙරීමටද, ඉඩම් තක්සේරුකෙරීමට සහ ඇපවර්ජු රෙජිස්තර් කෙරීමට ගෙවිය යුතු ගාස්තුන් ඉහු විසින් ගෙවනට ඕනෑම.

ඇප වෙනුවෙන් නිවනලද ඉඩම්වල ඔප්පු ඒවා මීට ප්‍රථම ඇපේකට නොගොත් උකසකට යටත් නැති බවට ඉඩම් ලියාපදිංචිකරණ රෙජිස්ත්‍රාර්තූනගෙන් සහතිකපත්‍රයක් ලබාගත යුතුයි. මෙම සහතිකපත්‍රය ලබාගැනීමට ඕනෑකරණ විසදීම ඇපගබන අය විසින් දරිය යුතුයි.

මේ ගැණ වැඩිදුර කාරණ ආණ්ඩුවේ ඒජන්තලන්තාන්සේගෙන් ඉල්ලීමකල විට දැනගන්ට පුළුවන.

නාගරිකසභාවට අයිති පාලම් රේන්ද.

- 1. පේරාදෙණියේ පාලම සහ ඊරියගම පාරේ රේන්දයද.
2. කටුගස්තොට පාලම සහ පාරේ රේන්දය.
3. ගෝනවත්තේ තොටුපල සහ තලාතුමයේ පාලම.
මෙයින් එක රේන්දපලකදී රේන්දකාසි ගෙවීමෙන් එදවස තුලදී අනිකට රේන්දකාසි ගෙවීමෙන් නිදහස්ය.
4. හල්මුවේ තොටුපල.
5. ඉරික්මෝදර සහ කුත්වසාලේ තොටුපල.

ආණ්ඩුවේ පාලම් රේන්ද.

- 1. රම්බොඩ පාරේ රේන්දය සහ තවලන්තෑන්ගේ රේන්දය. මෙයින් එක රේන්දපලකදී රේන්දකාසි ගෙවීමෙන් ඒ දවස තුලදී අනිකට රේන්දකාසි ගෙවීමෙන් නිදහස්ය.
2. පන්තල්මයේ පාලම.
3. බිබරකුලේ කොහිගහපාරේ රේන්දය.
4. ගොන්දෙන්නාවේ පාරේ රේන්දය.
5. තෙල්දෙණියේ පාලම සහ කෙත්ගල්ලේ පාරේ රේන්දය.
6. කඵදුඇල, පෙරබහුගැන්ගේ පාරේ රේන්දය.
7. බලකඩුවේ පාරේ රේන්දය.
8. කොලොන්නගමුල පාරේ රේන්දය.
9. වේරගමතොට තොටුපල.

ඇලක්සන් ඩේලි, ආණ්ඩුවේ ඒජන්තලන්තාන්සේ.

වර්ෂ 1898 ක්වූ නොවැරදි මස 8 වෙනි දින මහලුවර කවිවේරියේදීය.

NOTICE is hereby given that on Friday, November 25, 1898, at 2 P.M., will be put up for re-sale at the Kandy Kachcheri, at the risk of the original purchasers, the under-mentioned Toll Rents of the Central Province from December 1 to 31, 1898, the original purchasers of which may have failed on or before that date to pay the instalments for the month of October, 1898.

The purchasers at the re-sale will be required to deposit one-tenth of the purchase amount on the day of sale.

Further conditions will be read and explained on the day of sale.

Description of Rents.

Madawala road	Katugastota bridge
Bowwagama bridge	Nalanda bridge
Bambarakele-Kodigaha road	Kadawala road
Ramboda road	Dambulla and Galewela road
Kalude Ella-Perabahutenna	Aluwihara and Weragama road
Balakaduwa road	Kolongahamulla road
Peradeniya bridge and Iriyagama road	

Kandy Kachcheri, November 8, 1898. F. J. SMITH, for Government Agent.

මෙහි පහත සඳහන්වන මධ්‍යම දිසාවේ යොටුපල් පාලම් රේන්දවලට, වර්ෂ 1898 ක්වූ ඔක්තෝබර් මාසේ වාරගතකරණ ගෙවීයුතු මුදල් වර්ෂ 1898 ක්වූ නොවැම්බර් මස 25 වෙනි දිනදී නොගොස් ඊට මත්තෙන් ප්‍රථම ගැණුම්කාරයෝ විසින් ගෙවන්ට නොයෙදුනේදී, නැවත විකිනීමෙන් වෙන්ව ගෙදෙන්නාවූ සම් අලාභයකට ඔවුන් වහ කීමට යටත්කර, වර්ෂ 1898 ක්වූ දෙසැම්බර් මස 1 වෙනි දින පවත්වන 31 වෙනි දින දක්වා ඒවායේ රේන්ද, ඉහතකී නොවැම්බර් මස 25 වෙනි සිකුරුදු පස්වරු 2ට මහනුවර කම්මේරියේදී නැවත විකුණන්ට සෛදෙන වග වෙසින් දැනුම්දෙමි.

නැවත විකිනීමේදී ඉල්ලා ගන්නා අගවර්ෂ විසින් එසේ ඉල්ලා ගන්නාලද ගණකෙන් දහයෙන් එකක් විකුණු දවසේදී මුදලෙන් බැඳ තබන්ට ඕනෑය.

වැඩිදුර කොන්දේසි විකුණන දවසේදී කිසිවෑ නේ රුමිකර දෙනුලැබේ.

විකිනීමට තිබෙන රේන්දනම් :

- මඩවල පාරේ රේන්දය.
- බව්වාගම පාලම.
- බිඹරකැලේ කොඩිගහා පාරේ රේන්දය.
- රංඛඩ පාරේ රේන්දය.
- කළුදැල පෙරබහුනැත්තේ පාරේ රේන්දය.
- බලකඩුම්මේ පාර.
- ජේරුදෙනියේ පාලම සහ ඊරිගම පාරේ රේන්දය.
- කවුකස්තොට පාලම.
- නාලන්දේ පාලම.
- කඩවල පාරේ රේන්දය.
- දඹුල්ල සහ ගලේවෙල පාරේ රේන්දය.
- අළුපිහාරේ සහ වේරගම පාරේ රේන්දය.
- කොලොන්නකමුල පාරේ රේන්දය.

ඇප. ජේ. සමන්,

ආණ්ඩුවේ ඒජන්තලන්කාන්සේ වෙනුවට.

වර්ෂ 1898 ක්වූ නොවැම්බර් මස 8 වෙනි දින මහනුවර කම්මේරියේදීය.

NOTICE is hereby given that the Government Agent of the Province of Uva is prepared to receive tenders for the purchase of the following Toll Rents of the said Province for the period of one year from January 1 to December 31, 1899 :—

Wellawaya	Udakumbalwela
Tanamalwila	Padinawela
Marangahawela	Lunugala
Taldena	

The tenders which should be in sealed envelopes superscribed "Tender for Toll Rents," will be received at the Badulla Kachcheri at 1 o'clock P.M. on Saturday, November 12, 1898, when they will be opened.

Tenders should be accompanied by cash or Government draft for one-tenth of the amount of tender for each toll, if the tenderer does not appear at the Kachcheri in person.

Tenders may be sent in for each toll separately, but one for the seven tolls collectively will be preferred.

The Government Agent reserves to himself the right, without question, of rejecting any or all tenders.

The tenderer whose tender is accepted by the Government Agent will be required to deposit at once in cash one-tenth of the amount of his tender, which sum will be forfeited if he does not, within thirty days from the date when His Excellency the Governor's approval for his offer is communicated to him, deposit cash security equal to one-third of his purchase amount.

If no satisfactory offer be received by tender, the Government Agent will immediately put up each rent separately, or all the rents together, for sale by public auction.

The Padinawela toll station will, on the opening of the road to Ambawela railway station, be removed above the junction of that road.

G. A. BAUMGARTNER, Government Agent. Badulla Kachcheri, October 20, 1898.

වර්ෂ 1899 ක්වූ ජනවාරි මස 1 වෙනි දින සිට එම අඩු රැද්දේ දෙසැම්බර් මස 31 වෙනි දින වනතුරු ඉල්ලා ගන්නාලද ගණකෙන් දහයෙන් එකක් විකුණු දවසේදී මුදලෙන් බැඳ තබන්ට ඕනෑය.

රේන්දපලවල්.

වැල්ලවාග	තල්දෙන
කනමල්වල	උඩුකුඹුල්වෙල
මිරන්ගහවෙල	පාදිනාවෙල
එනුගල	

වැඩවර් නොගොස් ඉල්ලීමට පත්ව වහ වනතුරු ඇත් විලෝප එනේ සිට "රේන්ද ඉල්ලීමට පත්ව" කියා ලිය යුතුය. කවද මෙසේ එවනතුරු වැඩවර් වර්ෂ 1898 ක්වූ නොවැම්බර් මස 12 වෙනි සැතියන සවස එක වනතුරු බදු එ කම්මේරියේදී බාරගෙන ඊට පසු ඒවා කඩන්ට සෛදෙනවා ඇත. ඉල්ලීමකාරයා කටවේරියට ගේන වානම් ඉල්ලීමට සූදු සඳහන් එක එක රේන්ද ඉල්ලා තිබෙන මුදලෙන් දහයෙන් පංගුවකට මුදල් හෝ ආණ්ඩුවේ බිරිස් කඩදසියක් එවිය යුතුයි. එක එක රේන්ද යට වෙනවෙනම වැඩවර් එවිය හැකිය, නුමුත් රේන්ද ගතවම එක වැඩවර්කක් ලැබීමට වඩා කැමතිය. වැඩ එකක් හෝ සියල්ලම හෝ ප්‍රතික්ෂේප කෙරීමට බලය ආණ්ඩුවේ ඒජන්තලන්කාන්සේ වෙත ගබඩාගන්නාලදී.

සම් වැඩවර් දුන් අයෙකුගේ වැඩවර් එක ආණ්ඩුවේ ඒජන්තලන්කාන්සේ විසින් ඒජන්තලන්කාන්සේ සෙදු නාම වැඩවර් එකේ ජේන මුදලෙන් දහයෙන් කොටසක් එකී වැඩවර් අයිතිකාරයා විසින් වහාම මුදලෙන් බද්දට ඕනෑය. ඔහුගේ වැඩවර් ආණ්ඩුකාර උතුරා නන්වකන්සේ විසින් පිලිගන්නා කියා ඔහුට දැනුත් දුන් තිස්දවසක් තුල ඔහු රේන්දය ඉල්ලාගත් මුදලෙන් තුනෙන් පහෙන් මුදලෙන් නොබැරැන්දෙන් ඔහු විසින් පලමුකොට බැඳුණු දහයෙන් පහෙන් රුපියල්කයක වෙන බව දැනුණුයි. සෑහෙන ගනනකට ඉල්ලා වැඩවර් ලැබුනේ නැත්නම් එක එක රේන්දය වෙනවෙනම හෝ එසේ නැත්නම් රේන්ද සියල්ලම එකටදමා හෝ ආණ්ඩුවේ ඒජන්තලන්කාන්සේ විසින් එවලේම ප්‍රසිඩ වෙන්දේසියේ විකුණනු ලැබේ.

අසම්වෙල රේල්වේ ඡායිසන්පලට පාර ඇරිපිටක පාදිනාවෙල රේන්දපල එම පාර හන්දියෙන් ඉහලට කරනුලැබේ.

ජී. ඒ. බම්හාර්ට්ටර්, ආණ්ඩුවේ ඒජන්තලන්කාන්සේ.

වර්ෂ 1898 ක්වූ ඔක්තෝබර් මස 20 වෙනි දින බදු එ කම්මේරියේදීය.

MISCELLANEOUS NOTICES.

Amended Notice.

NOTICE is hereby given that the lease of the piece of grass land between the Gasworks premises and the approach road to the Kachcheri, and lying behind the Tamil Church, will be put up to auction, at the Colombo Kachcheri, on Monday, November 28, 1898, at 12 o'clock noon.

The conditions on which the lease of the above lot is to be sold are as follows:—

- (a) That the purchaser shall be regarded as a tenant-at-will.
- (b) That the rent shall be paid monthly in advance.

Colombo Kachcheri, J. S. DRIEBERG,
November 1, 1898. for Government Agent.

වෙනස්කරණලද දැන්වීමයි.

ලියාපදිංචි කළුබිම්කරුන්ගේ ඉඩමට සහ සවිවේ 8:00 සහ පාරවත් අතර දෙමල පල්ලියට පිටපස්සෙන් පිහිටා තිබෙන තනකොල වටා තිබෙන ඉඩමකැබෙල්ලේ බද්ද වෂ් 1898 ක්වු නොවැම්බර් මස 28 වෙනි සඳුදා දවල් 12ට කොලුම් කවිවේරියේදී ප්‍රසිද්ධ වෙන්දේසියේ විකුණන බව යෙදෙන බව මෙයින් දැනුම් දුන්නා ඇත.

ඉහත කී ඉඩමකැබෙල්ලේ බද්ද විකුණන බව යෙදෙන තේ මෙහි පහත සඳහන් වෙන කොන්දේසි පිටත.

(a) බද්ද ගන්ධ යෙදෙන තැනැත්තා ඕනෑ විටක අහස්කරනට පුළුවන් බ්‍රසකාරයක් හැරියට සලකන්නට යොදනවා ඇත.

(b) බදුමුදල් මාසපතා අත්පිට ගෙවන්නට ඕනෑ.

ජේ. ඇස්. ට්‍රිබර්න්,

අණවුලේ ඒජන්තයා වෙනුවට.

වෂ් 1898 ක්වු නොවැම්බර් මස 1 වෙනි දින කොලුම් කවිවේරියේදී.

NOTICE is hereby given that the Government Agent for the Southern Province will receive sealed tenders for the purchase of the lease to dig for plumbago on the under-mentioned Crown lands for a period of two years. The Government Agent reserves to himself the right to sell by public auction on the same day, if the tenders are unsatisfactory:—

Preliminary plan 3,958.—Talpe pattu, Magedara.

Lot.	Name of Land.	Extent.	
		A.	R. P.
9918	Pathareokanda	1	2 10
9919	Do.	1	2 7
9920	Do.	1	2 15
9921	Do.	1	1 14
9922	Do.	1	3 29
9923	Do.	1	0 34
9924	Do.	1	1 35
9925	Do.	1	3 5
Gangaboda pattu, Divitura.			
670	Puwakgahenakanda	19	0 32
686	Do.	19	1 20

The tenders, which must be in sealed envelopes superscribed "Tenders," will be received at the Galle Kachcheri until 12 noon on Friday, December 16, 1898.

Any further information can be obtained on application to the Government Agent.

The Kachcheri, E. B. ALEXANDER,
Galle, November 8, 1898. for Government Agent.

මෙහි පහත සඳහන් වෙන රජසන්තක ඉඩමවල මිනිරන් භාරක්ක දැඩිවැසිකම සහ බලය දුටු රැද්දකට විකිනීම ගැණ එවකලද මුද්දරකරු ඉල්ලුම්පත් දකුණු පලාතේ මහජන නඩුරත්නායකයන්ගේ විසින් භාරගනු ලැබේ.

සිතියම 3,958. තල්පේපත්තුව. මාගෙදර.

නො.	ඉඩමේ නම.	අ. ර. ප.
9918	පත්තාරේ ඕකන්ද	1 2 10
9919	එම	1 2 7
9920	එම	1 2 15
9921	එම	1 1 14
9922	එම	1 3 29
9923	එම	1 0 34
9924	එම	1 1 35
9925	එම	1 3 5

ගහබඩපත්තුව. දිවුරු.

670	පුළුක්කන්දේ කන්ද	19 0 32
686	එම	19 1 20

එවකලද ඉල්ලුම්පත් මුද්දරකරු කවරවල දී එහි පිට "ඉල්ලුම්පත්" යන වචන සටහන්කර දෙසැම්බර් මස 16 වෙනි දින දවල් දෙදෙන වෙනතරු දකුණු පලාතේ ඒජන්තයන්ගේ විසින් භාරගනු ලැබේ.

එම ඉල්ලුම්පත්වල ඉල්ලුම් බාරනොගත්තොත් මෙම ඉඩමවල බද්ද එවලේම ඒජන්තයන්ගේ විසින් විකුණන බව මෙයින් දැන්වේ.

මේ ගැන තවත් වැඩිදුර කාරණා දැනගත්ව ඕනෑ ලදී නම් ඒජන්තයන්ගේ විසින් ඉල්ලිය යුතුය.

ජේ. ඩී. ඇලැක්සැන්ඩර්,
ඒජන්තයන්ගේ වෙනුවට.

වෂ් 1898 ක්වු නොවැම්බර් මස 8 වෙනි දින ගාල්ලේ කවිවේරියේදී.

WHEREAS cattle murrain has broken out at Kendewa and Galkanda in Kende korale, in Nuwaragampalata of the Anuradhapura District, in the North-Central Province, it is hereby declared that the said village Kendewa—bounded on the east by Weddewa, south the village Ehetuwagama, west Kirimetiya-ela, and north the pinpara; and the said village Galkadawala, bounded on the east by a bo-tree, south a wiranda tree, west Galkanda, and north by eheta trees—are infected areas in terms of the 3rd clause of the Ordinance No. 9 of 1891.

This proclamation is to take effect from this date.

THOS. R. E. LOFTUS,
for Government Agent.

Anuradhapura Kachcheri,
November 2, 1898.

WHEREAS cattle murrain has ceased to exist in Dewamedde korale in Dewamedi hatpattu, in the Kurunegala District, the notification appearing in the Government Gazette, Part III., of September 24, 1897, proclaiming the korale an infected area, is hereby revoked.

This declaration is to take effect from this date.

HARRY E. BEVEN,
for Government Agent.

Kurunegala Kachcheri,
November 7, 1898.